



DESIGN AWARDS

Flair are proud to have received three design accolades in recognition of the ORO shower door collection.



The **Good Design Award**, **RedDot Award**, and **iF Design Award** are seals of global design excellence and a testimony to our passion for product quality and innovation.



PATENTED MAGNETIC GUIDE

The patented Magnetic Guide System is the first of the kind in the industry. It ensures the smoothest of motion for each sliding door as it glides along the bottom rail.

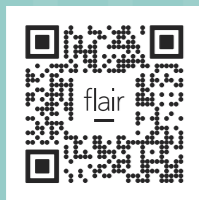

EXPLORE
ORO

ORO

FRAMELESS &
ULTRA FRAMELESS 8mm
SHOWER ENCLOSURE
COLLECTION

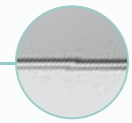

SILVER

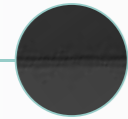

MATTE BLACK

FINISHES

S - Silver
B - Matte Black

THE ORO[®] COLLECTION

ORO - the epitome of grace & beauty.

With a graceful aesthetic, the award winning ORO collection is a union of design innovation and functional perfection. This signature collection sets the standard in frameless shower door design.

The hand crafted ORO door handles are one of a kind and distinctly individual. The patented magnetic guide system provides a smooth and effortless gliding action for each sliding door. Elegance shines through the curved profile and hinge detailing.

Each ORO detail is carefully considered to enhance your experience every day.



IDEA
CONCEPT
PROTOTYPE
ORO



THE ORO® COLLECTION

SILVER & BLACK OPTIONS

SLIDING DOOR 16	SLIDING DOOR WITH TWO INLINE PANELS 18	SLIDING QUADRANT DOOR 20
SLIDING OFFSET QUADRANT DOOR 22	HINGED QUADRANT DOOR 24	HINGED OFFSET QUADRANT DOOR 26
BIFOLD DOOR 28	HINGE DOOR 30	HINGE DOOR WITH INLINE PANEL 32
	HINGE & INLINE DOOR 34	HINGE & INLINE DOOR WITH INLINE PANEL 36

VISIONARY DETAILS

 2000mm HEIGHT	2 METRES HIGH	 SEAMLESS INTERIOR COVER STRIPS	CONCEALED INTERIOR FIXATION POINTS
 8mm TOUGHENED SAFETY GLASS	8mm TOUGHENED SAFETY GLASS TO EN12150	 ULTRA CLEAR SEALS	INNOVATIVE ULTRA CLEAR SEALS
 CLEARVUE GLASS COATING	CLEARVUE IS A HYDROPHOBIC GLASS COATING THAT RESISTS THE BUILD UP OF LIMESCALE AND GRIME ON THE GLASS SURFACE	 SUITABLE FOR SHOWER TRAY OR WETROOM INSTALLATION	SUITABLE FOR SHOWER TRAY OR WETROOM FLOOR INSTALLATION
 CRAFTED HANDLE DESIGN	UNIQUELY CRAFTED CHROME PLATED HANDLE	 LIFETIME GUARANTEE	LIFETIME GUARANTEE

THE ORO® ULTRA FRAMELESS COLLECTION

BIFOLD DOOR / ULTRA FRAMELESS 38	HINGE DOOR / ULTRA FRAMELESS 40	HINGE & INLINE / ULTRA FRAMELESS 42
-------------------------------------	------------------------------------	--

VISIONARY INNOVATIONS

COUNTERSUNK INTERIOR HINGES
WITH FLUSH TO GLASS FINISH



CURVED HINGE
DETAILING



SIGNATURE
HANDLE
DESIGN



UNIQUELY CRAFTED
BI-FOLD HANDLE



PATENTED MAGNETIC
GUIDE SYSTEM



MINIMALIST BOTTOM
DOOR GUIDE

FUNCTIONAL INNOVATIONS

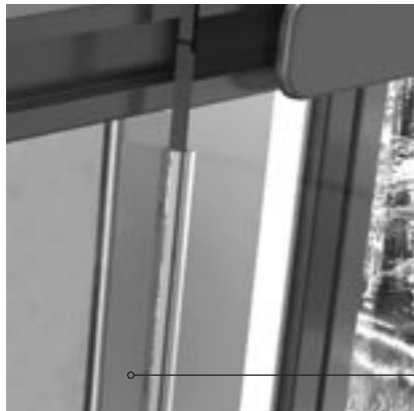

ULTRA CLEAR DOOR SEALS

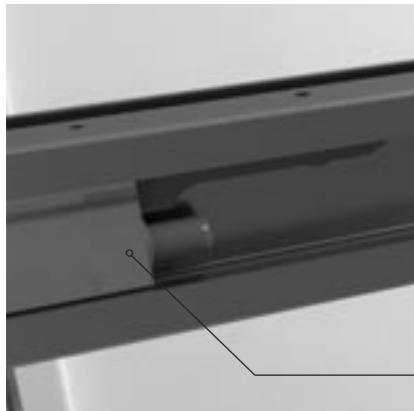

CUSHION CLOSE DAMPENER SYSTEM



CURVED RADIUS DETAILING THROUGHOUT





SLIDING DOOR (LEFT HAND)
WITH SEMI FRAMED SIDE PANEL - SILVER



SLIDING DOOR
(LEFT HAND) IN ALCOVE -
MATTE BLACK

Note: Sliding Door may also be installed to close onto Side Panel, please check door handing before ordering.

SLIDING DOOR

SILVER MATTE BLACK

A delightful choice, the ORO Sliding Door glides along with smooth perfection. The patented magnetic guide on the bottom of the door is the first of its kind on the market. 8mm toughened safety glass offers a tactile feeling of strength and quality.

The floating top rail design is a signature characteristic of the ORO range. With a seamless interior cover cap, the top rail also cleverly conceals the roller system. The finishing touch is the unique handle design – beautifully formed and a pleasure to use.

DOOR SIZE OPTIONS

PRODUCT SIZE (mm)	ADJUSTMENT SIZE		ACCESS (mm)	CODE SILVER	CODE MATTE BLACK
	MIN (mm)	MAX (mm)			
1100 - Left Hand	1060	1100	480	OROSA110LSC	–
1100 - Right Hand	1060	1100	480	OROSA110RSC	–
1200 - Left Hand	1160	1200	580	OROSA120LSC	OROSA120LBC
1200 - Right Hand	1160	1200	580	OROSA120RSC	OROSA120RBC
1400 - Left Hand	1360	1400	580	OROSA140LSC	OROSA140LBC
1400 - Right Hand	1360	1400	580	OROSA140RSC	OROSA140RBC
1500 - Left Hand	1460	1500	580	OROSA150LSC	OROSA150LBC
1500 - Right Hand	1460	1500	580	OROSA150RSC	OROSA150RBC
1600 - Left Hand	1560	1600	580	OROSA160LSC	–
1600 - Right Hand	1560	1600	580	OROSA160RSC	–

SEMI FRAMED SIDE PANEL OPTIONS (INCLUDES CORNER PROFILE)

PRODUCT SIZE (mm)	ADJUSTMENT SIZE		CODE SILVER	CODE MATTE BLACK
	MIN (mm)	MAX (mm)		
700	670	690	OROSP70SC	OROSP70BC
760	730	750	OROSP76SC	OROSP76BC
800	770	790	OROSP80SC	OROSP80BC
900	870	890	OROSP90SC	OROSP90BC
1000	970	990	OROSPI00SC	–
1200	1170	1190	OROSPI20SC	–

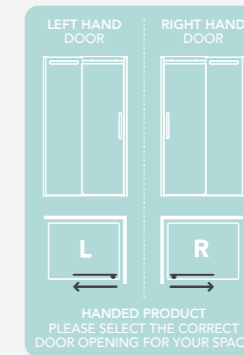

ACCESSORIES

PRODUCT DESCRIPTION	CODE SILVER	CODE MATTE BLACK
20mm Compensating Wall Profile	OROCB20SC	OROCB20BC

8mm

TOUGHENED SAFETY GLASS

2000mm

HEIGHT

OVERALL

40mm

PROFILE ADJUSTMENT

10mm

ULTRA LOW BOTTOM RAIL

CLEARVUE

GLASS COATING

SEAMLESS INTERIOR COVER STRIPS

ULTRA CLEAR SEALS

CUSHION CLOSE DAMPENER MECHANISM

PATENTED MAGNETIC GUIDE SYSTEM

AVAILABLE IN SILVER & MATTE BLACK

LIFETIME GUARANTEE

SLIDING DOOR WITH TWO INLINE PANELS

SILVER MATTE BLACK

The Sliding Door with two inline panels provides a sleek, contemporary look while maximizing space.

The patented magnetic guide system is designed to guarantee the smoothest motion as the door glides around the bottom rail.

The sliding door with two inline panels can be installed in an alcove or with a frameless side panel option and is the perfect choice for a large, luxurious showering zone.

DOOR SIZE OPTIONS

PRODUCT SIZE (mm)	ADJUSTMENT SIZE		ACCESS (mm)	CODE	CODE
	MIN (mm)	MAX (mm)		SILVER	MATTE BLACK
1200 - Left Hand	1160	1200	412	OROSA2IL120LSC	OROSA2IL120LBC
1200 - Right Hand	1160	1200	412	OROSA2IL120RSC	OROSA2IL120RBC
1400 - Left Hand	1360	1400	493	OROSA2IL140LSC	OROSA2IL140LBC
1400 - Right Hand	1360	1400	493	OROSA2IL140RSC	OROSA2IL140RBC
1500 - Left Hand	1460	1500	542	OROSA2IL150LSC	OROSA2IL150LBC
1500 - Right Hand	1460	1500	542	OROSA2IL150RSC	OROSA2IL150RBC
1600 - Left Hand	1560	1600	542	OROSA2IL160LSC	OROSA2IL160LBC
1600 - Right Hand	1560	1600	542	OROSA2IL160RSC	OROSA2IL160RBC
1700 - Left Hand	1660	1700	614	OROSA2IL170LSC	OROSA2IL170LBC
1700 - Right Hand	1660	1700	614	OROSA2IL170RSC	OROSA2IL170RBC
1800 - Left Hand	1760	1800	614	OROSA2IL180LSC	OROSA2IL180LBC
1800 - Right Hand	1760	1800	614	OROSA2IL180RSC	OROSA2IL180RBC
1900 - Left Hand	1860	1900	614	OROSA2IL190LSC	-
1900 - Right Hand	1860	1900	614	OROSA2IL190RSC	-
2000 - Left Hand	1960	2000	614	OROSA2IL200LSC	OROSA2IL200LBC
2000 - Right Hand	1960	2000	614	OROSA2IL200RSC	OROSA2IL200RBC

FRAMELESS SIDE PANEL OPTIONS *To suit sliding door with two inline panels only

PRODUCT SIZE (mm)	ADJUSTMENT SIZE		CODE	CODE
	MIN (mm)	MAX (mm)	SILVER	MATTE BLACK
700 (SA2IL specific)	660	680	OROSA2ILSP70SC	OROSA2ILSP70BC
800 (SA2IL specific)	760	780	OROSA2ILSP80SC	OROSA2ILSP80BC
900 (SA2IL specific)	860	880	OROSA2ILSP90SC	OROSA2ILSP90BC
1000 (SA2IL specific)	960	980	OROSA2ILSP100SC	OROSA2ILSP100BC
1200 (SA2IL specific)	1160	1180	OROSA2ILSP120SC	OROSA2ILSP120BC

Note - Two side panels can be made used to make a three sided enclosure.

8m

TOUGHENED SAFETY GLASS

2000mm

HEIGHT

40m

PROFILE ADJUSTMENT

10m

ULTRA LOW BOTTOM RAIL

CLEARVUE GLASS COATING

SEAMLESS INTERIOR COVER STRIPS

ULTRA CLEAR SEALS

CUSHION CLOSE DAMPENER MECHANISM

PATENTED MAGNETIC GUIDE SYSTEM

AVAILABLE IN SILVER & MATTE BLACK

LIFETIME GUARANTEE

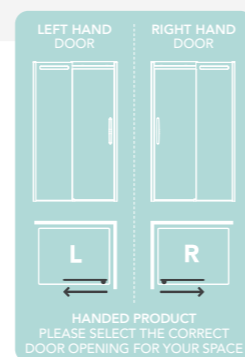

RIGHT HAND SLIDING DOOR WITH TWO INLINE PANELS AND FRAMELESS SIDE PANEL* - SILVER



LEFT HAND SLIDING DOOR WITH TWO INLINE PANELS IN ALCOVE - SILVER



RIGHT HAND SLIDING DOOR WITH TWO INLINE PANELS AND TWO TWO FRAMELESS SIDE PANELS* - SILVER

SLIDING QUADRANT DOOR

SILVER MATTE BLACK

Creative engineering has shaped the unique ORO Sliding Quadrant. The top floating rail design ingeniously encloses the roller system to give the door a sleek polished look. Practically speaking, the concealed rollers ensure reduced cleaning time.

Functional distinction continues with the patented magnetic guide system – this design innovation guarantees the smoothest motion as the door glides around the bottom rail. The final detail is the crafted handle design, befitting for the overall elegance of this door.

DOOR SIZE OPTIONS

PRODUCT ADJUSTMENT SIZE SIZE (mm)/MIN (mm)	ACCESS MAX (mm)	CODE (mm)	COLOR		
			SILVER	MATTE B	
900 - Left Hand	870	890	480	OROSQ90LSC	OROSQ90LBC
900 - Right Hand	870	890	480	OROSQ90RSC	OROSQ90RBC
1000 - Left Hand NEW	970	990	480	OROSQ100LSC	OROSQ100LBC
1000 - Right Hand NEW	970	990	480	OROSQ100RSC	OROSQ100RBC

ACCESSORIES

PRODUCT DESCRIPTION	COLOR	
	SILVER	MATTE BLACK
20mm Compensating Wall Profile	OROCB20SC	OROCB20BC

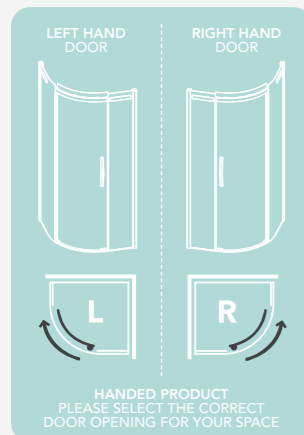

- 8mm TOUGHENED SAFETY GLASS
- 2000mm HEIGHT
- 20mm PROFILE ADJUSTMENT
- 10mm ULTRA LOW BOTTOM RAIL
- CRAFTED HANDLE DESIGN
- ULTRA CLEAR SEALS
- AVAILABLE IN SILVER & MATTE BLACK
- PATENTED MAGNETIC GUIDE SYSTEM
- CUSHION CLOSE DAMPENER MECHANISM
- CLEARVUE GLASS COATING
- LIFETIME GUARANTEE



SLIDING QUADRANT (RIGHT HAND) - MATTE BLACK

SLIDING QUADRANT (RIGHT HAND) - SILVER



SLIDING OFFSET QUADRANT (RIGHT HAND) - SILVER
(to suit right hand offset quadrant shower tray)

SLIDING OFFSET QUADRANT DOOR

SILVER MATTE BLACK

Generously proportioned, the ORO Sliding Offset Quadrant is designed to impress in your bathroom. The signature floating rail design cleverly encloses the rollers to give the door a sleek appearance.

Design excellence continues with the **patented magnetic guide system** ensuring the smoothest of motion as the door glides around the bottom rail. The **crafted chrome handles** have perfect symmetry, in line with the overall elegance of the door.

DOOR SIZE OPTIONS

PRODUCT SIZE (mm)	ADJUSTMENT SIZE		ACCESS (mm)	CODE	CODE
	MIN (mm)	MAX (mm)		SILVER	MATTE BLACK
1000 x 800 - Left Hand	770-970	790-990	480	OROSQ80X100LSC	-
1000 x 800 - Right Hand	770-970	790-990	480	OROSQ80X100RSC	-
1000 x 900 - Left Hand	870-970	890-990	480	OROSQ90X100LSC	-
1000 x 900 - Right Hand	870-970	890-990	480	OROSQ90X100RSC	-
1200 x 800 - Left Hand	770-1170	790-1190	480	OROSQ80X120LSC	OROSQ80X120LBC
1200 x 800 - Right Hand	770-1170	790-1190	480	OROSQ80X120RSC	OROSQ80X120RBC
1200 x 900 - Left Hand	870-1170	890-1190	480	OROSQ90X120LSC	OROSQ90X120LBC
1200 x 900 - Right Hand	870-1170	890-1190	480	OROSQ90X120RSC	OROSQ90X120RBC

ACCESSORIES

PRODUCT DESCRIPTION	CODE SILVER	CODE MATTE BLACK
20mm Compensating Wall Profile	OROCB20SC	OROCB20BC

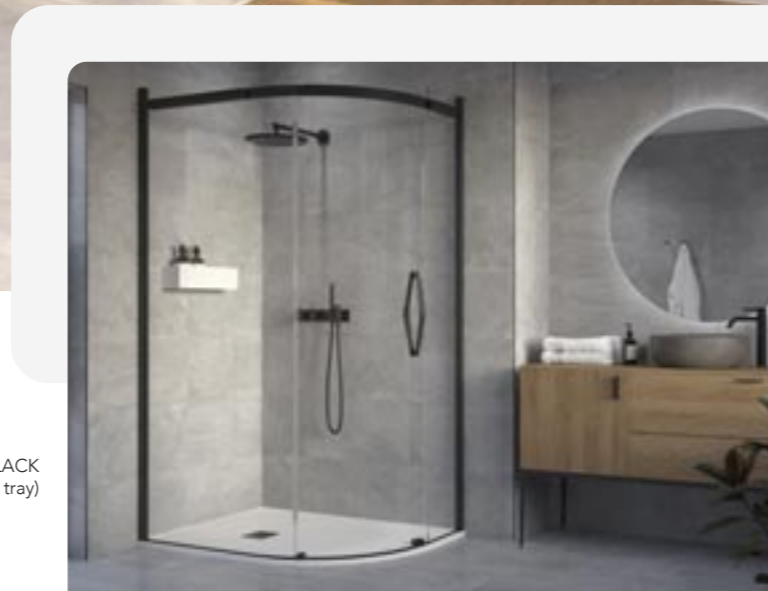

SLIDING OFFSET QUADRANT (RIGHT HAND) - MATTE BLACK
(to suit right hand offset quadrant shower tray)



- 8mm** TOUGHENED SAFETY GLASS
- 2000mm** PROFILE HEIGHT
- 20mm** PROFILE ADJUSTMENT
- 10mm** ULTRA LOW BOTTOM RAIL
- CRAFTED HANDLE DESIGN**
- ULTRA CLEAR SEALS**
- PATENTED MAGNETIC GUIDE SYSTEM**
- SEAMLESS INTERIOR COVER STRIPS**
- CUSHION CLOSE DAMPENER MECHANISM**
- CLEARVUE GLASS COATING**
- AVAILABLE IN SILVER & MATTE BLACK**
- LIFETIME GUARANTEE**

HINGED QUADRANT DOOR

SILVER MATTE BLACK

A hallmark of elegance, the ORO Hinged Quadrant will add a touch of class to your bathroom.

The frameless curved glass is supported by 2 stainless steel stabilising bars that blend seamlessly into the door silhouette. Flush to glass interior **counter sunk hinges** allows you to easily wipe the shower glass clean. Precise in its action, this curved hinge door is secured by **ultra clear magnetic seals** that deliver the perfect positive close action every time.

DOOR SIZE OPTIONS

PRODUCT SIZE (mm)	ADJUSTMENT SIZE		ACCESS (mm)	CODE SILVER	CODE MATTE BLACK
	MIN (mm)	MAX (mm)			
900 - Left Hand	870	890	570	OROHQ90LSC	OROHQ90LBC
900 - Right Hand	870	890	570	OROHQ90RSC	OROHQ90RBC
1000 - Left Hand	970	990	570	OROHQ100LSC	OROHQ100LBC
1000 - Right Hand	970	990	570	OROHQ100RSC	OROHQ100RBC

ACCESSORIES

PRODUCT DESCRIPTION	CODE SILVER	CODE MATTE BLACK
20mm Compensating Wall Profile	OROCB20SC	OROCB20BC

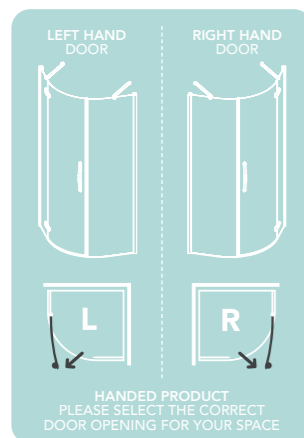

- 8mm TOUGHENED SAFETY GLASS
- 2000mm HEIGHT
- 20mm PROFILE ADJUSTMENT
- COUNTERSUNK INTERIOR HINGES
- 10mm ULTRA LOW BOTTOM RAIL
- CRAFTED HANDLE DESIGN
- ULTRA CLEAR SEALS
- SEAMLESS INTERIOR COVER STRIPS
- STAINLESS STEEL ANGLED STABILISING BARS
- CLEARVUE GLASS COATING
- AVAILABLE IN SILVER & MATTE BLACK
- LIFETIME GUARANTEE



HINGED QUADRANT (LEFT HAND) - MATTE BLACK



HINGED QUADRANT (RIGHT HAND) - SILVER



HINGED OFFSET QUADRANT (RIGHT HAND) - SILVER
(to suit right hand offset quadrant shower tray)



HINGED OFFSET QUADRANT (RIGHT HAND) - MATTE BLACK
(to suit right hand offset quadrant shower tray)

HINGED OFFSET QUADRANT DOOR

SILVER MATTE BLACK

Setting the standard in frameless design, the ORO Offset Hinged Quadrant is a shower door of sheer beauty and elegance for your bathroom. The curved frameless glass is supported by 2 minimalist stainless steel stabilising bars. Flush to glass interior counter sunk hinges allow you to easily wipe the shower glass clean.

Precise in its action, the curved hinge door is secured by ultra clear magnetic seals that give the perfect close on the shower enclosure.



DOOR SIZE OPTIONS

PRODUCT SIZE (mm)	ADJUSTMENT SIZE		ACCESS (mm)	CODE	CODE
	MIN (mm)	MAX (mm)		SILVER	MATTE BLACK
1000 x 800 - Left Hand	770-970	790-990	570	OROHQ80X100LSC	-
1000 x 800 - Right Hand	770-970	790-990	570	OROHQ80X100RSC	-
1000 x 900 - Left Hand	870-970	890-990	570	OROHQ90X100LSC	-
1000 x 900 - Right Hand	870-970	890-990	570	OROHQ90X100RSC	-
1200 x 800 - Left Hand	770-1170	790-1190	570	OROHQ80X120LSC	OROHQ80X120LBC
1200 x 800 - Right Hand	770-1170	790-1190	570	OROHQ80X120RSC	OROHQ80X120RBC
1200 x 900 - Left Hand	870-1170	890-1190	570	OROHQ90X120LSC	OROHQ90X120LBC
1200 x 900 - Right Hand	870-1170	890-1190	570	OROHQ90X120RSC	OROHQ90X120RBC

ACCESSORIES

PRODUCT DESCRIPTION	CODE SILVER	CODE MATTE BLACK
20mm Compensating Wall Profile	OROCB20SC	OROCB20BC

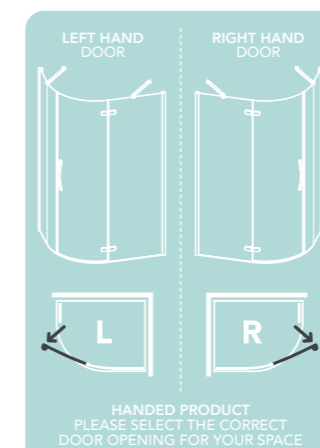

- 8mm** TOUGHENED SAFETY GLASS
- 2000mm** HEIGHT
- 20mm** PROFILE ADJUSTMENT
- COUNTERSUNK INTERIOR HINGES
- CRAFTED HANDLE DESIGN
- ULTRA CLEAR SEALS
- SEAMLESS INTERIOR COVER STRIPS
- 10mm** ULTRA LOW BOTTOM RAIL
- STAINLESS STEEL ANGLED STABILISING BARS
- CLEARVUE GLASS COATING
- AVAILABLE IN SILVER & MATTE BLACK
- LIFETIME GUARANTEE

BIFOLD DOOR

SILVER MATTE BLACK

The ingenious design of the ORO Bifold Door makes it a firm favourite amongst this 8mm shower door range.

The innovative 180 degree hinge mechanism enables the door to open inwards and outwards, offering you total flexibility. A self stop hinge action prevents the door glass extending into contact with the shower wall or door hinges. The bifold hinge is meticulously engineered giving this frameless door exceptional stability. The signature ORO handle design adds the finishing touch to this bijoux beauty.

DOOR SIZE OPTIONS

PRODUCT SIZE (mm)	ADJUSTMENT SIZE		ACCESS (mm)	CODE	
	MIN (mm)	MAX (mm)		SILVER	MATTE BLACK
700	660	700	483	OROBF70SC	-
760	720	760	538	OROBF76SC	-
800	760	800	575	OROBF80SC	OROBF80BC
900	860	900	668	OROBF90SC	OROBF90BC
1000	960	1000	759	OROBF100SC	OROBF100BC

SEMI FRAMED SIDE PANEL OPTIONS (INCLUDES CORNER PROFILE)

PRODUCT SIZE (mm)	ADJUSTMENT SIZE		CODE	
	MIN (mm)	MAX (mm)	SILVER	MATTE BLACK
700	670	690	OROSP70SC	OROSP70BC
760	730	750	OROSP76SC	OROSP76BC
800	770	790	OROSP80SC	OROSP80BC
900	870	890	OROSP90SC	OROSP90BC
1000	970	990	OROSP100SC	-
1200	1170	1190	OROSP120SC	-

ACCESSORIES

PRODUCT CODE	CODE		
SIZE (mm)	SILVER	MATTE BLACK	
20mm Compensating Wall Profile	OROCB20SC	OROCB20BC	
Raised Stabilising Bar 1050mmS-ORO105HSSB		S-ORO105HSSBMB	

Note - Stabilising bar must be purchased with the bifold door and semi framed side panel with polished silver corner profile.



BIFOLD DOOR (LEFT HAND) IN ALCOVE - MATTE BLACK

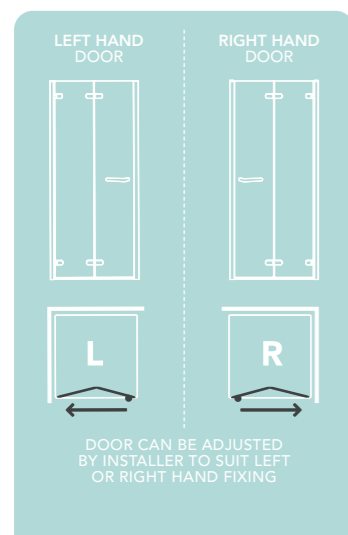

UNIVERSAL - SUITS LEFT OR RIGHT HAND OPENING



BIFOLD DOOR (RIGHT HAND) WITH SEMI FRAMED SIDE PANEL - SILVER

- 8mm TOUGHENED SAFETY GLASS
- 2000mm HEIGHT
- OVERALL 40mm PROFILE ADJUSTMENT
- 10mm ULTRA LOW BOTTOM RAIL
- ULTRA CLEAR SEALS
- SEAMLESS INTERIOR COVER STRIPS
- UNIVERSAL LEFT OR RIGHT HAND OPENING
- CLEARVUE GLASS COATING
- AVAILABLE IN SILVER & MATTE BLACK
- LIFETIME GUARANTEE

HINGE DOOR SILVER MATTE BLACK

Experience perfection with the 8mm ORO hinge door. Ideal for smaller spaces, this frameless door features curved radius detailing throughout. Interior fixation points are discreetly concealed by an innovative cover cap design. The countersunk interior hinges allow you to wipe the shower glass clean with ease.

Ultra clear magnetic seals give the hinge door a reassuring close action. The finishing touch is the crafted chrome handles – shaped to give a tactile feeling of smooth perfection.

DOOR SIZE OPTIONS

PRODUCT SIZE (mm)	ADJUSTMENT SIZE		ACCESS (mm)	CODE	CODE
	MIN (mm)	MAX (mm)		SILVER	MATTE BLACK
800	760	800	660	OROHD80SC	OROHD80BC
900	860	900	760	OROHD90SC	OROHD90BC
1000	960	1000	860	OROHD100SC	–

SEMI FRAMED SIDE PANEL OPTIONS (INCLUDES CORNER PROFILE)

PRODUCT SIZE (mm)	ADJUSTMENT SIZE		CODE	CODE
	MIN (mm)	MAX (mm)	SILVER	MATTE BLACK
700	670	690	OROSP70SC	OROSP70BC
760	730	750	OROSP76SC	OROSP76BC
800	770	790	OROSP80SC	OROSP80BC
900	870	890	OROSP90SC	OROSP90BC
1000	970	990	OROSPI00SC	–
1200	1170	1190	OROSPI20SC	–

ACCESSORIES

PRODUCT CODE	CODE		
SIZE (mm)	SILVER	MATTE BLACK	
20mm Compensating Wall Profile	OROCB20SC	OROCB20BC	
Raised Stabilising Bar 1050mmS-ORO1055SB-S-ORO1055SBMB			

Note - Stabilising bar must be purchased with the with the hinge door and semi framed side panel with polished silver corner profile.

HINGE DOOR (LEFT HAND) IN ALCOVE - MATTE BLACK

UNIVERSAL - SUITS LEFT OR RIGHT HAND OPENING

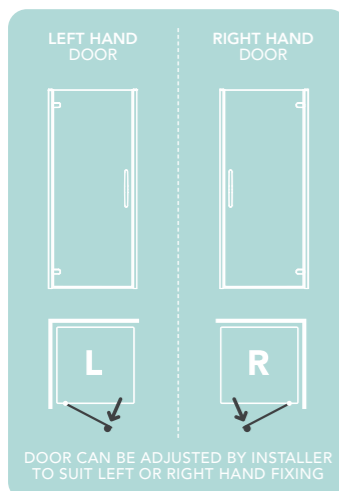

STAINLESS STEEL STRAIGHT STABILISING BAR



8mm TOUGHENED SAFETY GLASS	2000mm HEIGHT	40mm OVERALL PROFILE ADJUSTMENT	10mm ULTRA LOW BOTTOM RAIL	CLEARVUE GLASS COATING	AVAILABLE IN SILVER & MATTE BLACK
CRAFTED HANDLE DESIGN	ULTRA CLEAR SEALS	SEAMLESS INTERIOR COVER STRIPS	UNIVERSAL LEFT OR RIGHT HAND OPENING	LIFETIME GUARANTEE	



HINGE DOOR (LEFT HAND) WITH SEMI FRAMED SIDE PANEL - SILVER

INLINE PANEL TO SUIT HINGE DOOR

SILVER MATTE BLACK

The ORO hinge door installed with an inline panel is a practical yet elegant option for the bathroom.

The inline panels offer a great degree of flexibility, with a wide variety of sizes available. This sleek frameless shower door design is suitable for alcove/ recess installation only.

INLINE PANEL OPTIONS

PRODUCT CODE SIZE (mm)	CODE SILVER	CODE MATTE BLACK
100 (No Stabilising Bar Required)	OROIL10SC	-
200 (No Stabilising Bar Required)	OROIL20SC	-
300 (450mm Stabilising Bar Included)	OROIL30SC	OROIL30BC
400 (450mm Stabilising Bar Included)	OROIL40SC	OROIL40BC
500 (450mm Stabilising Bar Included)	OROIL50SC	-
600 (450mm Stabilising Bar Included)	OROIL60SC	-

HINGE DOOR OPTIONS

PRODUCT SIZE (mm)	ADJUSTMENT SIZE		ACCESS (mm)	CODE	CODE
	MIN (mm)	MAX (mm)		SILVER	MATTE BLACK
800	760	800	660	OROHD80SC	OROHD80BC
900	860	900	760	OROHD90SC	OROHD90BC
1000	960	1000	860	OROHD100SC	-

BOTTOM BARRIER BAR – TO SUIT HINGE DOOR WITH INLINE PANEL APPLICATION

PRODUCT CODE SIZE (mm)	CODE SILVER	CODE MATTE BLACK
Bottom Barrier Bar 1600mm	OROILBB-BF-HDS	OROILBB-BF-HDB

Note - Inline panels only suitable for alcove or recess application (not compatible with side panels)

- 8mm TOUGHENED SAFETY GLASS
- 2000mm HEIGHT
- OVERALL 40mm PROFILE ADJUSTMENT
- 10mm ULTRA LOW BOTTOM RAIL
- CLEARVUE GLASS COATING
- AVAILABLE IN SILVER & MATTE BLACK
- CRAFTED HANDLE DESIGN
- ULTRA CLEAR SEALS
- SEAMLESS INTERIOR COVER STRIPS
- UNIVERSAL LEFT OR RIGHT HAND OPENING
- LIFETIME GUARANTEE



HINGE DOOR WITH INLINE PANEL IN ALCOVE - SILVER



HINGE & INLINE DOOR (RIGHT HAND) WITH SEMI FRAMED SIDE PANEL - MATTE BLACK



HINGE & INLINE DOOR (LEFT HAND) IN ALCOVE - SILVER

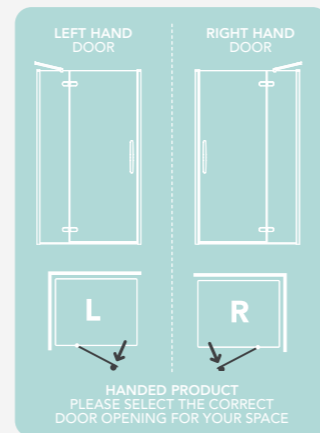

HINGE & INLINE OPEN POSITION MEASUREMENTS

DOOR SIZE	FIXED INLINE PANEL SIZE	DOOR OPEN EXTERNAL PROTRUSION*
1100mm	350mm	770mm
1200mm	400mm	770mm
1400mm	600mm	770mm
1600mm	750mm	770mm

*Door opens to 90° angle.

HINGE & INLINE DOOR

SILVER MATTE BLACK

Striking in its appearance, the ORO Hinge and Inline door is a statement piece for your bathroom.

The **gently curved hinges** have a countersunk interior design and can be wiped clean with ease. The **T-bar stabiliser** has concealed fixings and its sleek construction blends subtly into the products profile. Ultra clear magnetic seals giving a superior close action. The finishing touch is the **crafted chrome handles**, their perfect symmetry complementing the overall elegance of the door.

DOOR SIZE OPTIONS

PRODUCT SIZE (mm)	ADJUSTMENT SIZE		ACCESS (mm)	CODE SILVER	CODE MATTE BLACK
	MIN (mm)	MAX (mm)			
1100 - Left Hand	1060	1100	740	OROHD110LSC	–
1100 - Right Hand	1060	1100	740	OROHD110RSC	–
1200 - Left Hand	1160	1200	740	OROHD120LSC	OROHD120LBC
1200 - Right Hand	1160	1200	740	OROHD120RSC	OROHD120RBC
1400 - Left Hand	1360	1400	740	OROHD140LSC	–
1400 - Right Hand	1360	1400	740	OROHD140RSC	–
1600 - Left Hand	1560	1600	740	OROHD160LSC	–
1600 - Right Hand	1560	1600	740	OROHD160RSC	–

Angled stabilising bar included with each door.

SEMI FRAMED SIDE PANEL OPTIONS (INCLUDES CORNER PROFILE)

PRODUCT SIZE (mm)	ADJUSTMENT SIZE		CODE SILVER	CODE MATTE BLACK
	MIN (mm)	MAX (mm)		
700	670	690	OROSP70SC	OROSP70BC
760	730	750	OROSP76SC	OROSP76BC
800	770	790	OROSP80SC	OROSP80BC
900	870	890	OROSP90SC	OROSP90BC
1000	970	990	OROSP100SC	–
1200	1170	1190	OROSP120SC	–

ACCESSORIES

PRODUCT CODE SIZE (mm)	CODE SILVER	CODE MATTE BLACK
20mm Compensating Wall Profile	OROCB20SC	OROCB20BC
Straight Stabilising Bar 600mm with T Piece	S-ORO160SSB+TB	S-ORO160SSBMB+TB

Note - Stabilising bar must be purchased with the hinge and inline door and semi framed side panel. Stabilising bar is standard 1600mm and can be resized to suit all door sizes.

8mm

TOUGHENED SAFETY GLASS

2000mm

HEIGHT

40mm

OVERALL PROFILE ADJUSTMENT

10mm

ULTRA LOW BOTTOM RAIL

CLEARVUE GLASS COATING

AVAILABLE IN SILVER & MATTE BLACK

CRAFTED HANDLE DESIGN

ULTRA CLEAR SEALS

SEAMLESS INTERIOR COVER STRIPS

UNIVERSAL LEFT OR RIGHT HAND OPENING

LIFETIME GUARANTEE

INLINE PANEL TO SUIT HINGE & INLINE DOOR

SILVER MATTE BLACK

The ORO hinge & Inline door installed with an inline panel achieves a luxurious, spacious feel whilst not compromising on functionality.

With an emphasis on frameless aesthetics, the curved hinges are countersunk on the interior allowing for effortless cleaning of the shower glass. The 8mm toughened safety glass stands at 2 metres tall and boasts Clearvue hydrophobic coating, making this shower door the perfect blend of form and function.

INLINE PANEL OPTIONS

PRODUCT CODE SIZE (mm) SILVER	CODE MATTE BLACK		
100 (No Stabilising Bar Required) OROIL10SC	—		
200 (No Stabilising Bar Required) OROIL20SC	—		
300 (450mm Stabilising Bar Included) OROIL30SC	OROIL30BC		
400 (450mm Stabilising Bar Included)	OROIL40SC	OROIL40BC	
500 (450mm Stabilising Bar Included) OROIL50SC	—		
600 (450mm Stabilising Bar Included)	OROIL60SC	—	

HINGE AND INLINE DOOR OPTIONS

PRODUCT SIZE (mm)	ADJUSTMENT SIZE		ACCESS (mm)	CODE SILVER	CODE MATTE BLACK
	MIN (mm)	MAX (mm)			
1100 - Left Hand	1060	1100	740	OROHD110LSC	—
1100 - Right Hand	1060	1100	740	OROHD110RSC	—
1200 - Left Hand	1160	1200	740	OROHD120LSC	OROHD120LBC
1200 - Right Hand	1160	1200	740	OROHD120RSC	OROHD120RBC

BOTTOM BARRIER BAR – TO SUIT HINGE AND INLINE DOOR WITH INLINE PANEL APPLICATION

PRODUCT CODE SIZE (mm) SILVER	CODE MATTE BLACK
Bottom Barrier Bar 2200mm OROILBB-HDILS	OROILBB-HDILB

Note - Inline panels only suitable for alcove or recess application (not compatible with side panels)

8mm
TOUGHENED SAFETY GLASS

2000mm
HEIGHT

40mm
OVERALL PROFILE ADJUSTMENT

10mm
ULTRA LOW BOTTOM RAIL

CLEARVUE GLASS COATING

AVAILABLE IN SILVER & MATTE BLACK

CRAFTED HANDLE DESIGN

ULTRA CLEAR SEALS

SEAMLESS INTERIOR COVER STRIPS

UNIVERSAL LEFT OR RIGHT HAND OPENING

LIFETIME GUARANTEE



HINGE & INLINE DOOR WITH INLINE PANEL IN ALCOVE - SILVER

BIFOLD DOOR WITH ULTRA FRAMELESS CORNER SIDE PANEL

SILVER MATTE BLACK

The ORO Bifold and ultra frameless corner side panel is a truly versatile shower door choice. Designed to open both inwards and outwards, the self stop hinge mechanism prevents the bifold door from folding into contact with the glass panels. The raised stabilising bar is engineered to accompany the frameless corner side panel and with its extra height, allows the door to fold inwards without restriction.

STEP 1 - SELECT SIZE OF ULTRA FRAMELESS CORNER SIDE PANEL

PRODUCT SIZE (mm)	ADJUSTMENT SIZE		CODE SILVER	CODE MATTE BLACK
	MIN (mm)	MAX (mm)		
700	660	680	OROCSP70SC	—
760	720	740	OROCSP76SC	—
800	760	780	OROCSP80SC	OROCSP80BC
900	860	880	OROCSP90SC	OROCSP90BC
1000	960	980	OROCSP100SC	—

STEP 2 - SELECT SIZE OF DOOR

PRODUCT SIZE (mm)	ADJUSTMENT SIZE		ACCESS (mm)	CODE SILVER	CODE MATTE BLACK
	MIN (mm)	MAX (mm)			
700	660	700	483	OROBF70SC	—
760	720	760	538	OROBF76SC	—
800	760	800	575	OROBF80SC	OROBF80BC
900	860	900	668	OROBF90SC	OROBF90BC
1000	960	1000	759	OROBF100SC	OROBF100BC

STEP 3 - CHOOSE CORNER INLINE PANEL KIT SIZE

PRODUCT CODE	CORNER KIT SIZE (mm)	CODE SILVER	CODE MATTE BLACK
200	OROKIT2	—	—
300	OROKIT3	OROKIT3B	—
400	OROKIT4	OROKIT4B	—

NOTE - BIFOLD DOOR SIZE PLUS CORNER INLINE PANEL SIZE WILL TOTAL TO THE WIDTH OF YOUR SHOWER TRAY.
 Each corner inline panel kit includes the following components:
 Inline panel, bottom barrier bar and stabilising bar with fixing brackets.
 Ultra clear seal or 3M tape option supplied for corner inline panel fixation.

AVAILABLE IN SILVER & MATTE BLACK

8mm TOUGHENED SAFETY GLASS	2000mm HEIGHT	20mm CORNER SIDE PANEL ADJUSTMENT	20mm DOOR ADJUSTMENT	10mm ULTRA LOW BOTTOM RAIL	SUITABLE FOR SHOWER TRAY INSTALLATION ONLY
CRAFTED HANDLE DESIGN	ULTRA CLEAR SEALS	SEAMLESS INTERIOR COVER STRIPS	UNIVERSAL LEFT OR RIGHT HAND OPENING	CLEARVUE GLASS COATING	LIFETIME GUARANTEE

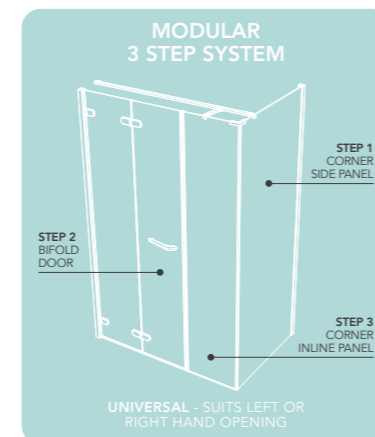

BIFOLD DOOR (LEFT HAND) WITH ULTRA FRAMELESS CORNER SIDE PANEL - MATTE BLACK



BIFOLD DOOR (LEFT HAND) WITH ULTRA FRAMELESS CORNER SIDE PANEL - SILVER

HINGE DOOR WITH ULTRA FRAMELESS CORNER SIDE PANEL

SILVER MATTE BLACK

The ORO Hinge Door and ultra frameless corner side panel radiates style and contemporary elegance.

This **corner side panel system** is modular, giving you flexibility with your door and inline panel sizing to suit your shower tray. Minimally designed but with durability in mind, the corner side panel is supported by a **sleek chrome stabilising bar**.

STEP 1 - SELECT SIZE OF ULTRA FRAMELESS CORNER SIDE PANEL

PRODUCT SIZE (mm)	ADJUSTMENT SIZE		CODE SILVER	CODE MATTE BLACK
	MIN (mm)	MAX (mm)		
700	660	680	OROCSP70SC	-
760	720	740	OROCSP76SC	-
800	760	780	OROCSP80SC	OROCSP80BC
900	860	880	OROCSP90SC	OROCSP90BC
1000	960	980	OROCSP100SC	-

STEP 2 - SELECT SIZE OF DOOR

PRODUCT SIZE (mm)	ADJUSTMENT SIZE		ACCESS (mm)	CODE SILVER	CODE MATTE BLACK
	MIN (mm)	MAX (mm)			
800	760	800	660	OROHD80SC	OROHD80BC
900	860	900	760	OROHD90SC	OROHD90BC
1000	960	1000	860	OROHD100SC	-

STEP 3 - CHOOSE CORNER INLINE PANEL KIT SIZE

PRODUCT CODE	SIZE (mm)	CODE SILVER	CODE MATTE BLACK
200	OROKIT2	-	-
300	OROKIT3	OROKIT3B	-
400	OROKIT4	OROKIT4B	-

NOTE - HINGE DOOR SIZE PLUS CORNER INLINE PANEL SIZE WILL TOTAL TO THE WIDTH OF YOUR SHOWER TRAY.

Each corner inline panel kit includes the following components:
inline panel, bottom barrier bar and stabilising bar with fixing brackets.
Ultra clear seal or 3M tape option supplied for corner inline panel fixation.



 8mm TOUGHENED SAFETY GLASS	 2000mm HEIGHT	 20mm CORNER SIDE PANEL ADJUSTMENT	 20mm DOOR ADJUSTMENT	 10mm ULTRA LOW BOTTOM RAIL	 SUITABLE FOR SHOWER TRAY INSTALLATION ONLY
 CRAFTED HANDLE DESIGN	 ULTRA CLEAR SEALS	 SEAMLESS INTERIOR COVER STRIPS	 UNIVERSAL LEFT OR RIGHT HAND OPENING	 CLEARVUE GLASS COATING	 LIFETIME GUARANTEE

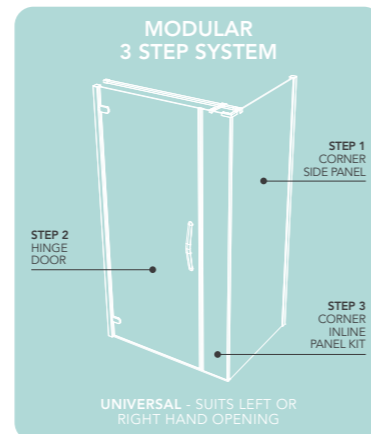

HINGE DOOR (LEFT HAND) WITH ULTRA FRAMELESS CORNER SIDE PANEL - SILVER



HINGE DOOR (RIGHT HAND) WITH ULTRA FRAMELESS CORNER SIDE PANEL - MATTE BLACK

HINGE AND INLINE DOOR WITH ULTRA FRAMELESS CORNER SIDE PANEL

SILVER MATTE BLACK

Setting the standard in frameless design, the ORO Hinge and Inline door with ultra frameless corner side panel will make a real style statement in your bathroom.

A generously proportioned shower enclosure, this modular design is ideal for larger showering spaces. With durability in mind, the corner side panel is supported by a minimalist chrome stabilising bar.

STEP 1 - SELECT SIZE OF ULTRA FRAMELESS CORNER SIDE PANEL

PRODUCT SIZE (mm)	ADJUSTMENT SIZE		CODE SILVER	CODE MATTE BLACK
	MIN (mm)	MAX (mm)		
700	660	680	OROCSP70SC	—
760	720	740	OROCSP76SC	—
800	760	780	OROCSP80SC	OROCSP80BC
900	860	880	OROCSP90SC	OROCSP90BC
1000	960	980	OROCSP100SC	—

STEP 2 - SELECT SIZE OF DOOR

PRODUCT SIZE (mm)	ADJUSTMENT SIZE		ACCESS (mm)	CODE SILVER	CODE MATTE BLACK
	MIN (mm)	MAX (mm)			
1100 - Left Hand	1060	1100	740	OROHD110LSC	—
1100 - Right Hand	1060	1100	740	OROHD110RSC	—
1200 - Left Hand	1160	1200	740	OROHD120LSC	OROHD120LBC
1200 - Right Hand	1160	1200	740	OROHD120RSC	OROHD120RBC

STEP 3 - CHOOSE CORNER INLINE PANEL KIT SIZE

PRODUCT SIZE (mm)	CODE SILVER	CODE MATTE BLACK
	100	OROKIT5
200	OROKIT6	—
300	OROKIT7	OROKIT7B
400	OROKIT8	OROKIT8B

NOTE - HINGE AND INLINE DOOR SIZE PLUS CORNER INLINE PANEL SIZE WILL TOTAL TO THE WIDTH OF YOUR SHOWER TRAY.

*Tolerance of 20mm in the inline panel measurement reflecting the 20mm profile adjustment.

Each corner inline panel kit includes the following components: inline panel, bottom barrier bar and stabilising bar with fixing brackets. Ultra clear seal or 3M tape option supplied for corner inline panel fixation.

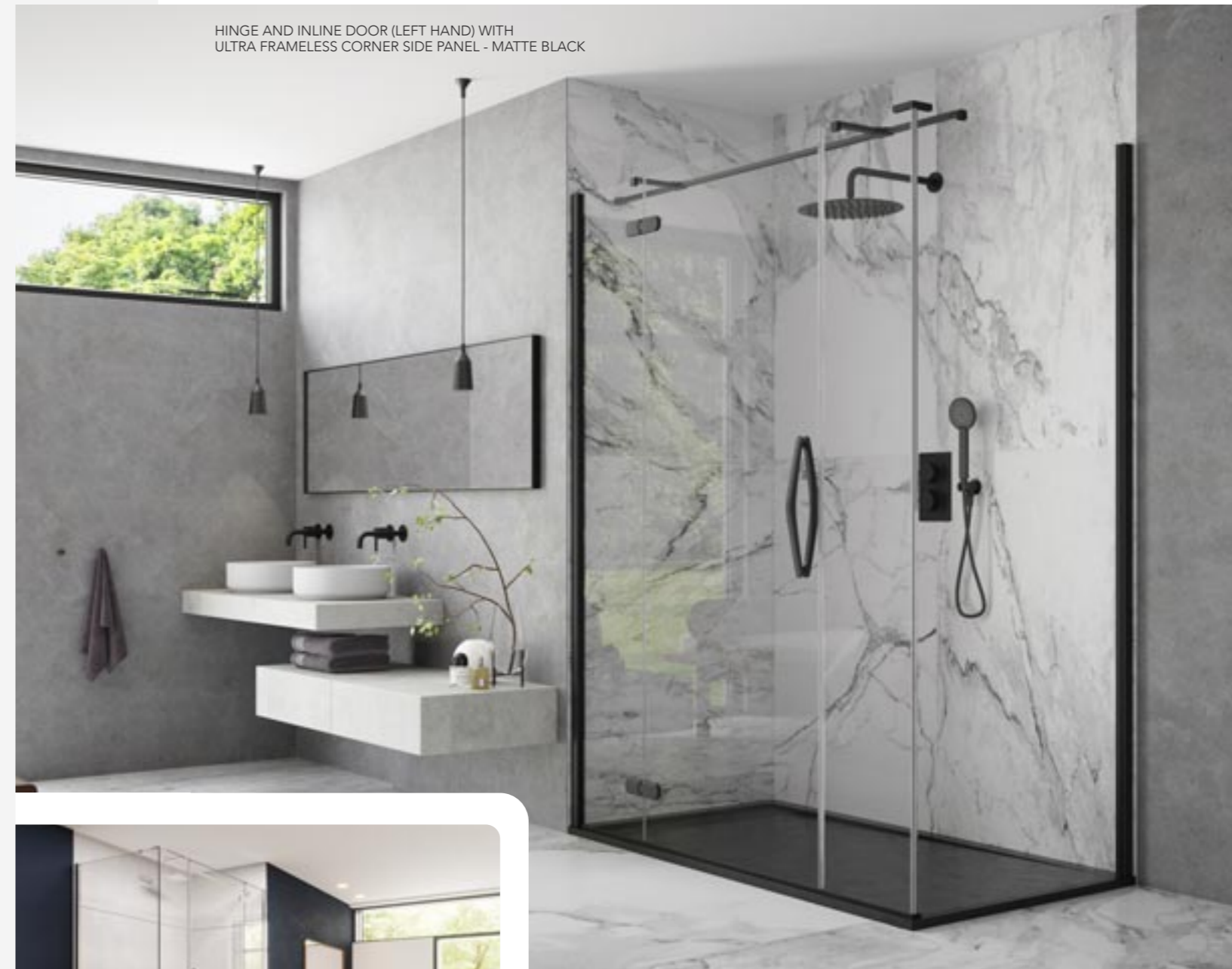
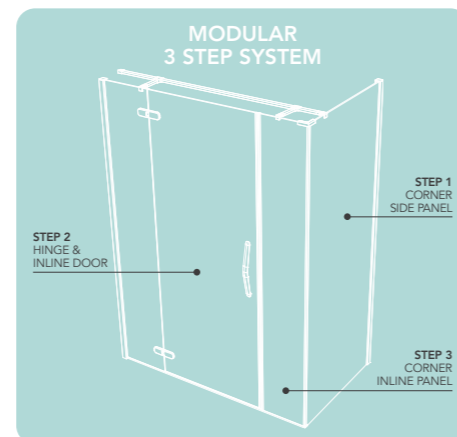
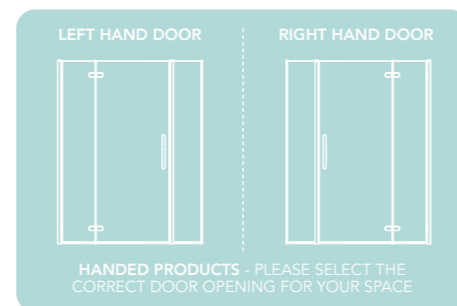

HINGE AND INLINE DOOR (LEFT HAND) WITH ULTRA FRAMELESS CORNER SIDE PANEL - MATTE BLACK



HINGE AND INLINE DOOR (RIGHT HAND) WITH ULTRA FRAMELESS CORNER SIDE PANEL - MATTE BLACK

8E TOUGHENED SAFETY GLASS	2000mm HEIGHT	20E CORNER SIDE PANEL ADJUSTMENT	20E DOOR ADJUSTMENT	10E ULTRA LOW BOTTOM RAIL	AVAILABLE IN SILVER & MATTE BLACK
CRAFTED HANDLE DESIGN	ULTRA CLEAR SEALS	SEAMLESS INTERIOR COVER STRIPS	SUITABLE FOR SHOWER TRAY INSTALLATION ONLY	CLEARVUE GLASS COATING	LIFETIME GUARANTEE

ORO[®] DOOR STYLES & HANDED DOOR GUIDE

SLIDING DOOR

Please select carefully the ORO Sliding Door that is the correct hand opening for your space.



SLIDING QUADRANT DOOR

Please select carefully the ORO Sliding Quadrant that is the correct hand opening for your space.

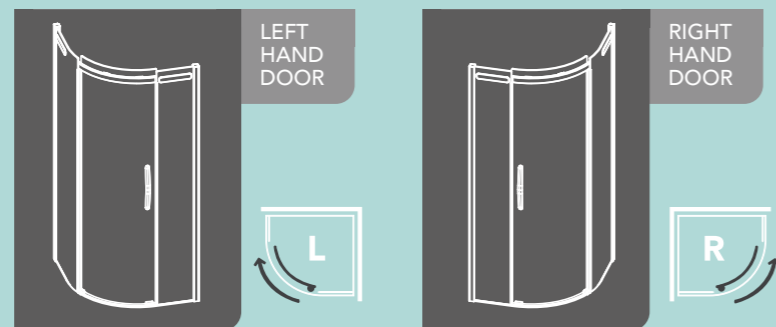

SLIDING OFFSET QUADRANT DOOR

Please select carefully the ORO Sliding Offset Quadrant that is the correct shape for your offset shower tray.

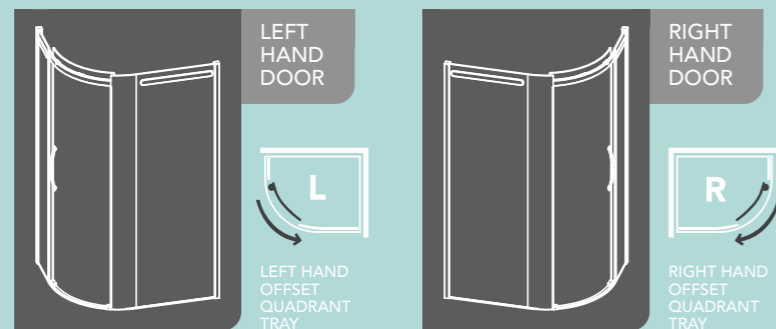

HINGED QUADRANT DOOR

Please select carefully the ORO Hinged Quadrant that is the correct hand opening for your space.

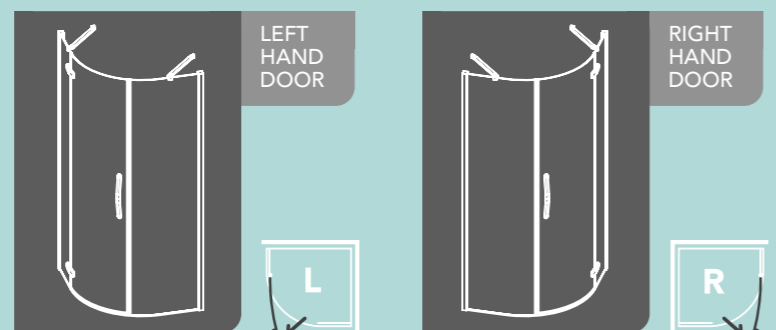

HINGED OFFSET QUADRANT DOOR

Please select carefully the ORO Hinged Offset Quadrant that is the correct shape for your offset shower tray.

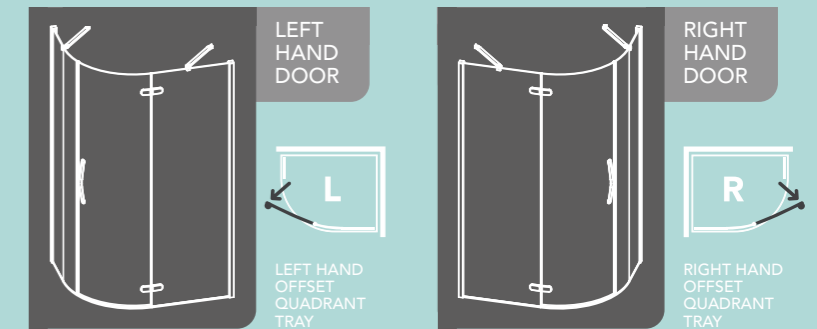

BIFOLD DOOR

The ORO Bifold Door is universal, so it can be adapted at installation to suit either left or right hand installation.

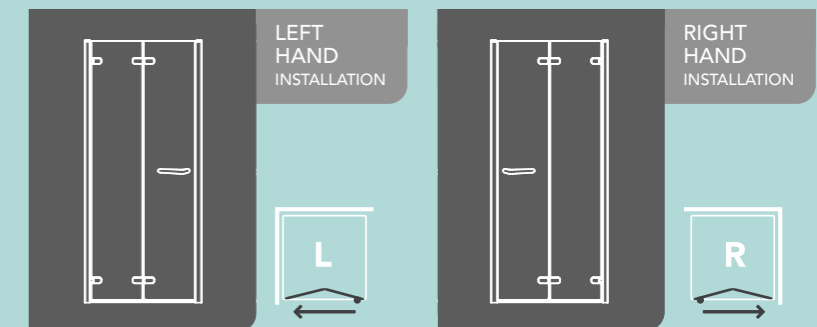

HINGED DOOR

The ORO Hinged Door is universal, so it can be adapted at installation to suit either left or right hand installation.

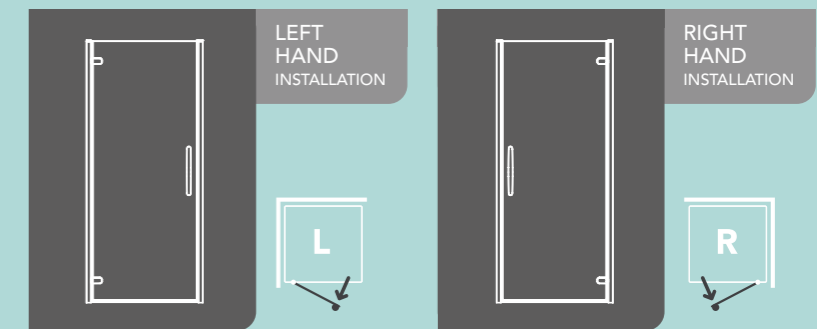

HINGED AND INLINE DOOR

Please select carefully the ORO Hinge and Inline Door that is the correct hand opening for your space.

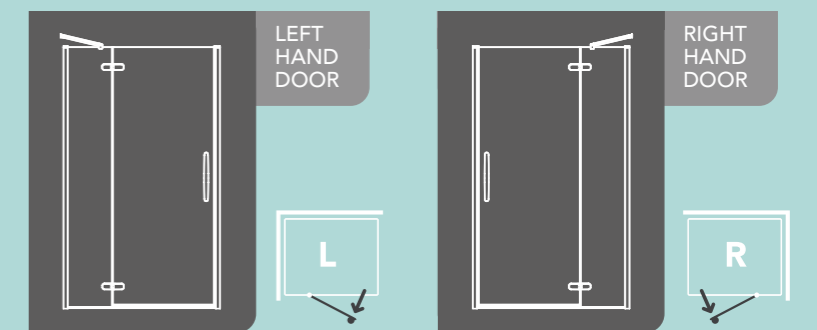

ORO[®] WATER RETENTION GUIDE

ORO Sliding Doors have an award winning design that reduces the need for invasive seals or large bottom rails allowing the customer a unique frameless showering experience.

As standard, ORO Sliding Doors come with a minimalist bottom barrier bar that does not include the use of an invasive seal or large bottom rail as part of the frameless design.

The ORO enclosure range is tested and certified for water retention in accordance with EN14428 where conventional showering practices are used and the product has been fitted in accordance with the Flair Fitting Instructions.

However, in unconventional showering practices, to further improve water retention and minimise any water escaping from the shower enclosure we have designed additional water retention solutions for optional use by customers.

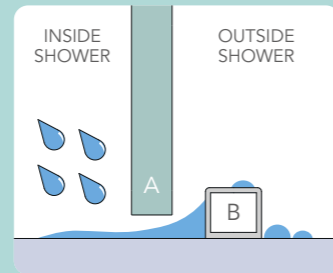

A - Sliding Door Glass
B - Minimal Barrier Bar

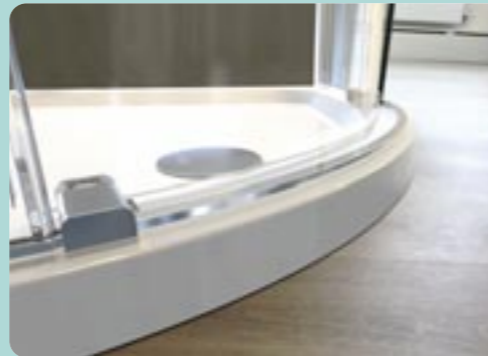

OPTION 1 THRESHOLD SEAL

The ORO Threshold seal is a minimal 15mm high silver profile with a discreet clear seal that can be easily fitted on top of the barrier bar during or after installation.

The Threshold seal will provide an increased level of water retention and protect against large surges of water escaping from the shower area. ORO Threshold seals are readily available from Flair Showers and can be ordered using the below product codes.

Product Codes:

S-OROSA110TSS, S-OROSA120TSS,
S-OROSA140-160TSS, S-OROSQTSS

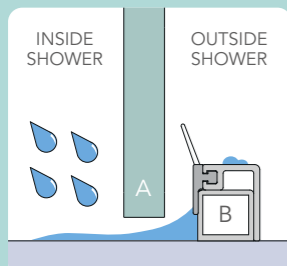

A - Sliding Door Glass
B - Minimal Barrier Bar
1 - Threshold Seal



OPTION 2 THRESHOLD BARRIER BAR

The ORO Threshold Barrier Bar is a larger 27mm high barrier bar which can be easily fitted on top of the barrier bar during or after installation.

The Threshold Barrier Bar offers the highest level of water retention available in the ORO Frameless Sliding Door's design. ORO Threshold Barrier Bars are readily available from Flair Showers and can be ordered using the below product codes.

Product Codes:

S-OROSA110TBS, S-OROSA120TBS,
S-OROSA140-160TBS, S-OROSQTBS

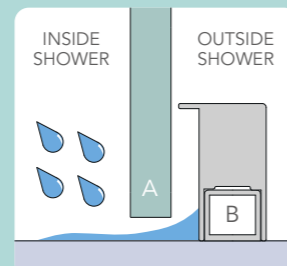

A - Sliding Door Glass
B - Minimal Barrier Bar
2 - Threshold Bar



ORO[®] ALTERNATIVE HANDLES

An alternative choice of ORO handle design is now available. Created to deliver a sleek and contemporary aesthetic, these additional handle options are available in a Polished Chrome or Matte Black finish.

For ORO Range see pages 16-43.

PRODUCT SIZE CODE

ORO Alternative Handle - Chrome (compatible with all ORO doors except bifold)	S-OROHLE2
ORO Alternative Handle - Matte Black (compatible with all ORO doors except bifold)	S-OROHLE2B
ORO Alternative Handle for Bifold - Chrome	S-ETO-OROHLE1
ORO Alternative Handle for Bifold - Matte Black	S-ETO-OROHLE1B



ETO[®] ALTERNATIVE HANDLES

An alternative choice of ETO handle design is now available. Created to deliver a sleek and contemporary aesthetic, these additional handle options are available in a Polished Chrome, Matte Black or Brushed Brass finish.

For ETO Range see pages 60-93.

PRODUCT SIZE CODE

ETO Alternative Handle - Chrome	S-ETO-OROHLE1
ETO Alternative Handle - Matte Black	S-ETO-OROHLE1B
ETO Alternative Handle - Brushed Brass	S-ETO-OROHLE1BRB



QUALITY GUARANTEED

At Flair we have an unwavering commitment to product quality.

All Flair Shower doors and wetrooms are CE approved and manufactured in accordance with ISO 9001:2000 Quality Assurance systems. All glass is toughed safety glass and produced to EN12150.

Flair products are performance tested to EN14428. Shower doors and rotating wetroom panels have been subject to lifetime shower door cycle testing consisting of 20,000 functional cycles.

Flair Shower doors and rotating wetroom panels have also been tested for their durability, stability, and water retention properties to ensure that they meet the highest possible industry standards. Water is maintained where conventional showering practices are used and the product has been fitted in accordance with the Flair Fitting Instructions. Please note - Due to the weight of certain products, they may require a two man lift.

Images shown in this catalogue are for illustrative purposes only. All descriptions contained in this catalogue are for the purpose of explaining each product more clearly and do not form part of any contract with the company.

Guarantee

ORO & ETO Shower Doors are covered by a lifetime guarantee against manufacturer defect. A lifetime guarantee constitutes a term of 20 years. AYO Wetrooms and Bathscreens are covered by a 20 year guarantee against manufacturer defect. Shower Trays are subject to manufacturer guarantee. All guarantees are valid on the condition that goods are installed and maintained in accordance with the products fitting instructions and best practices. This guarantee is for domestic use only.

***Note: Non glass and detachable parts such as seals and cover caps are subject to normal wear and tear during usage and are under statutory guarantee for 2 years from time of purchase. Glass shattering is not subject to Lifetime guarantee.**

We ask our customers to register their guarantee online at www.flairshowers.com or return the guarantee card that comes with every Flair product.

After-sales & Spare Parts Service

Flair Showers are 100% committed to customer service excellence. For ultimate peace of mind, a comprehensive range of spare parts is available for all Flair product ranges. If you would like to talk to an aftercare specialist about your Flair product, please contact us on (Ireland & Northern Ireland) +353 42 966 8000 or (UK) 0800 1800 8050.

Return Policy

Flair will not accept return of any product that has been opened. We do not accept return of any product if the packaging has been damaged. If the product is unopened and not damaged, we will accept the return of the product but a handling fee of 25% of the invoice price will be charged.

Cleaning Guidelines

- Glass: Use a soft cloth and warm soapy water; rinse off thoroughly.
- Metallic Surfaces: Use a soft cloth and warm soapy water; rinse off thoroughly.
- Do not use "Spray & leave" cleaning products on the metal surface as these will cause damage to your product. These include acidic based cleaning products, bleaches, solvents or abrasive pads.
- In hard water areas, regular cleaning of your Flair door will help to prevent the build-up of limescale. Stubborn deposits of limescale can be removed with warm soapy water.
- Check your shower door for functionality periodically. Ensure that the wheel track is free from any grit / dirt which may have collected over time.

Installation

Full installation instructions are provided with each product to ensure correct installation. All Shower doors and wetroom panels are adjustable between the dimensions stated. All dimensions are approximate.

Shower Tray Installation

All shower trays must be installed as per instructions supplied. Install on a base of fine sand, cement and cement additive. Please note: Silicone sealants, foams, mastics, installation compound adhesive or similar must not be used as a substitute for cement. Ensure shower tray is 100% level and water test to ensure water is draining correctly. If not satisfied at any stage do not proceed with fitting. Fitting of Shower Tray is acceptance of quality.

Conditions of Sale

Unless otherwise stated, all price quotations are subject to acceptance within 30 days of date of issue. Other than in the case of faulty goods / incorrect despatch, Flair will not accept the return of any product.

AS PART OF OUR CONTINUING POLICY OF PRODUCT IMPROVEMENT, WE RESERVE THE RIGHT TO AMEND SPECIFICATIONS, COLOURS AND PRICES WITHOUT PRIOR NOTICE.

*Errors and Omissions Exempt.

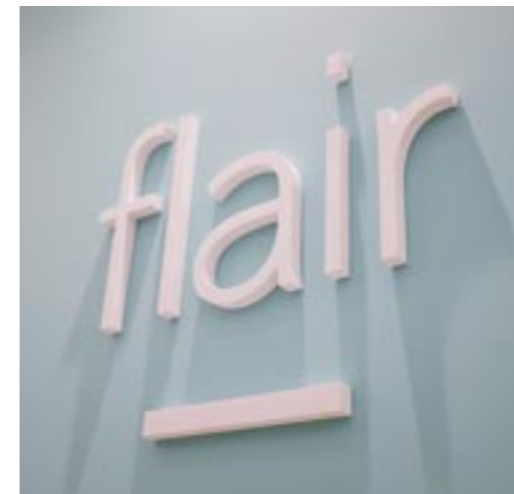

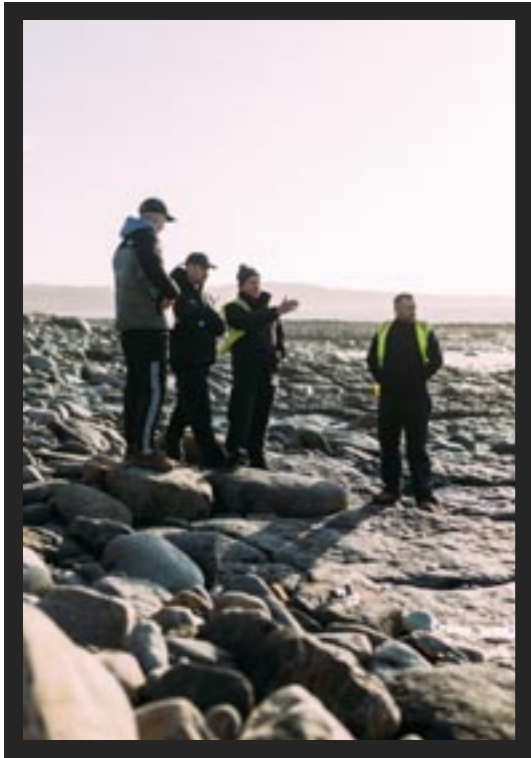
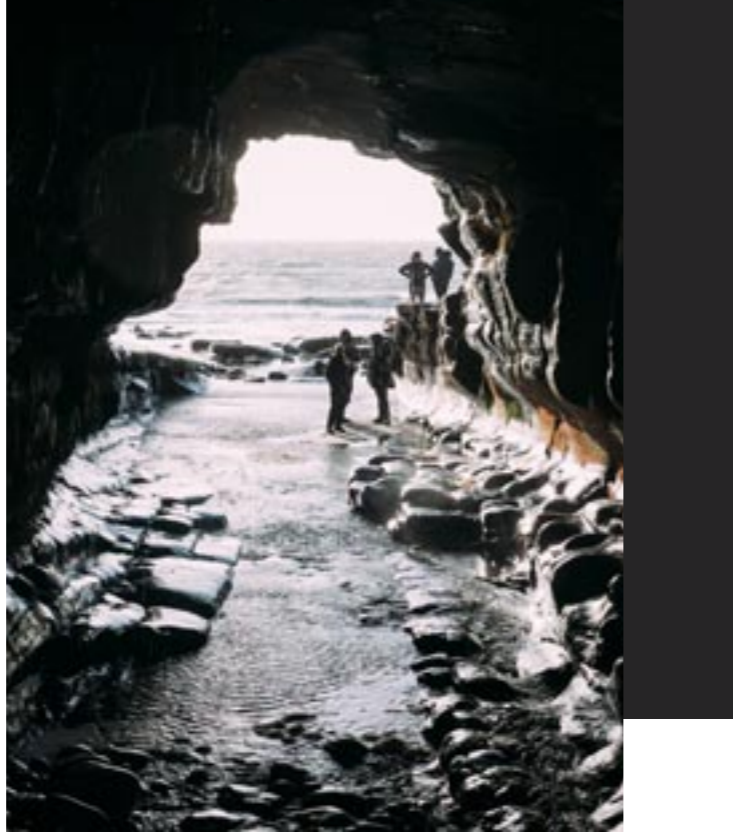

BEHIND
THE
SCENES

WATCH
THE
VIDEO



BROWSE OUR WATERFALL LOOKBOOK

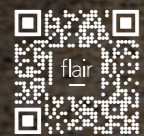

FIND
YOUR
FLAIR



flair
—

Flair Showers

Ireland / Northern Ireland
+353 42 966 8000

England / Scotland / Wales
0800 180 8050

sales@flairshowers.com



FLAIRSHOWERS.COM

