

If installed on the shower tray - The tray must be fitted level, tiled in and sealed along its entire wall length.

S'il est installé sur un receveur de douche - Le receveur doit être installé à niveau 100%, carrelé et scellé sur toute la longueur du mur.

Stabile al 100% Se installato su piatto doccia-Il piatto deve essere stabile e con la giusta inclinazione, piastrellato e sigillato dove viene a contatto col muro.

1A

100% level
Niveau 100%
Stabile al 100%

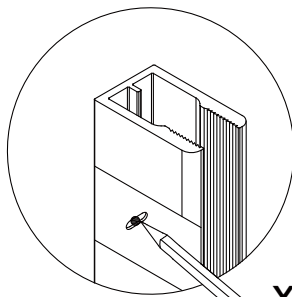
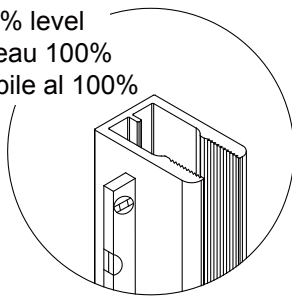

x4

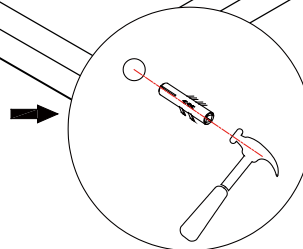
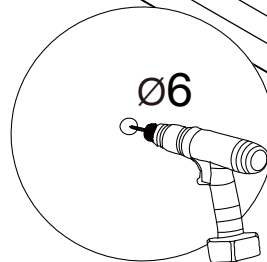
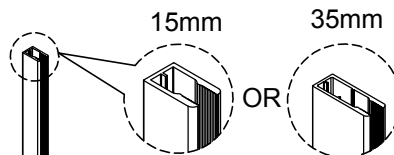

1B

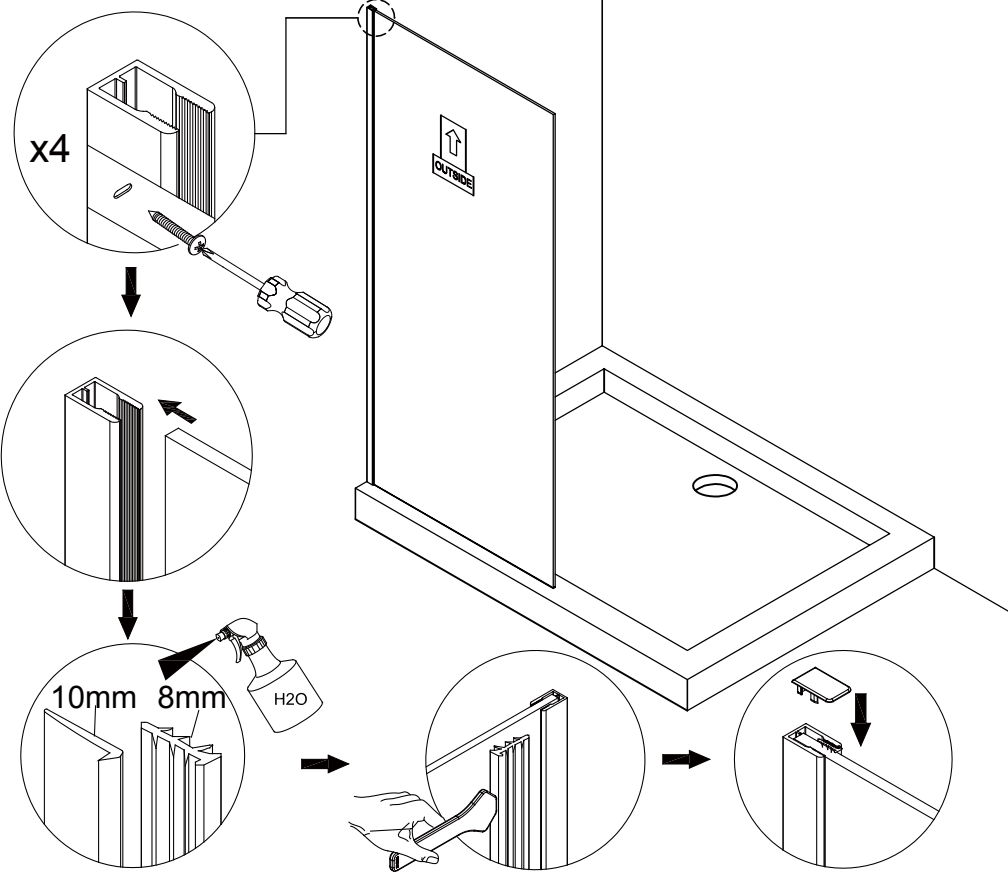

B

1C

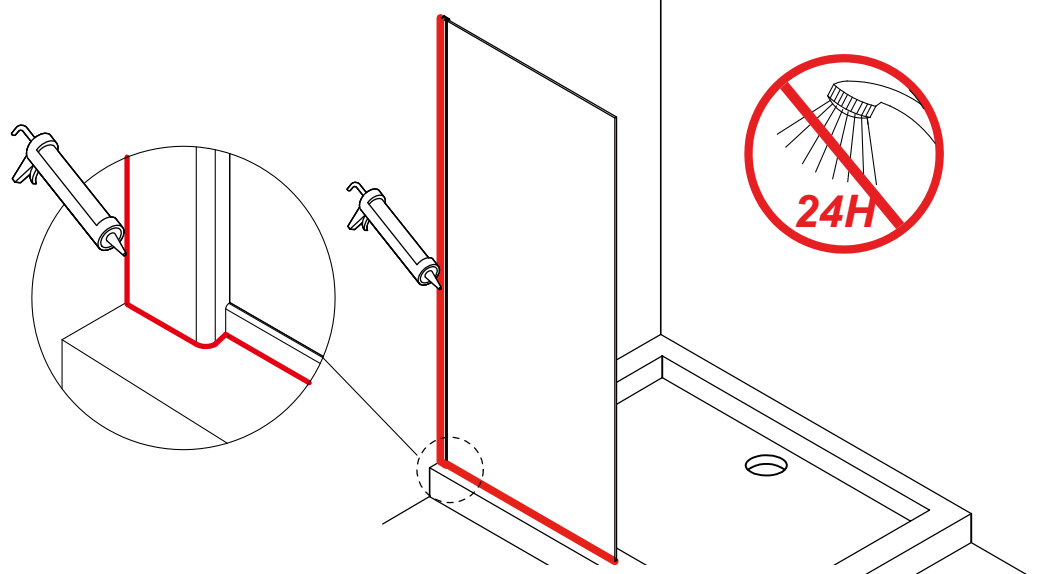

Please fit your preferred stabilising solution before proceeding to apply the silicone. Information for fitting is supplied in the following steps.

Veuillez installer la solution stabilisante de votre choix avant d'appliquer le silicone. Voir les instructions d'installation suivantes.

Installate il metodo di supporto prima di sigillare con il silicone. Le istruzioni di montaggio sono disponibili con il kit della barra di supporto Flair Showers.

B

2A



B

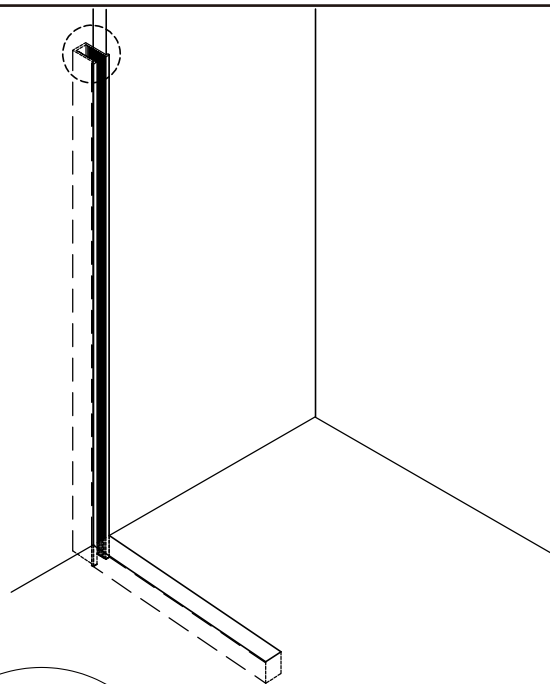
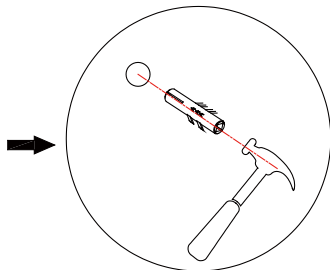
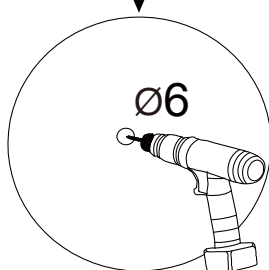
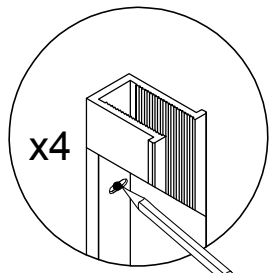
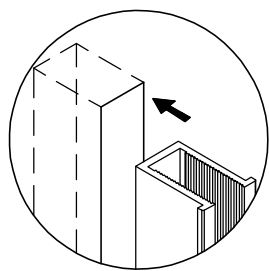

2B

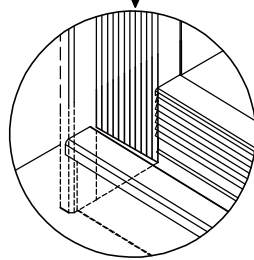
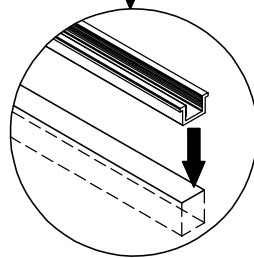
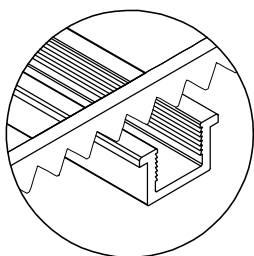

B

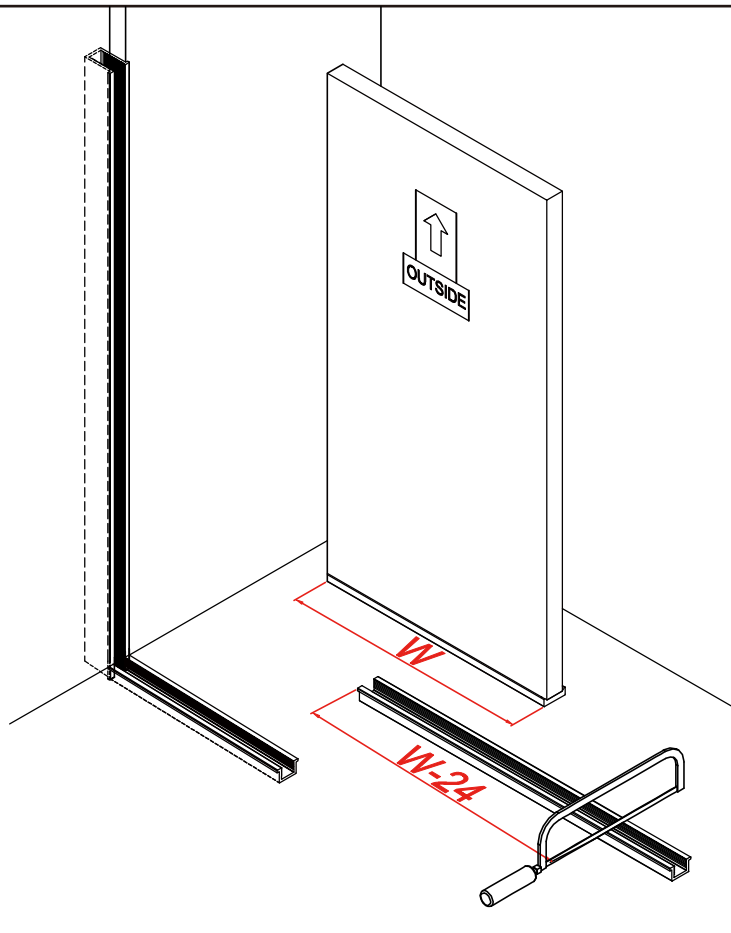

2C

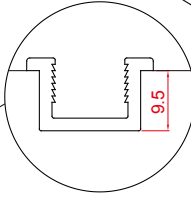
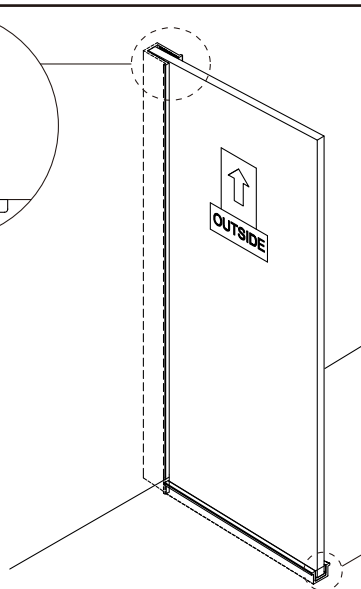
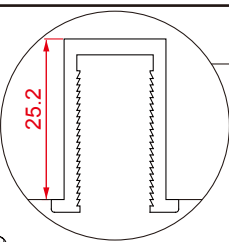
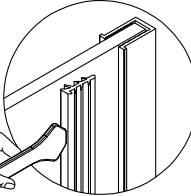
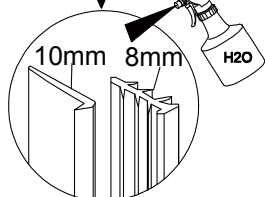
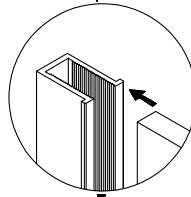
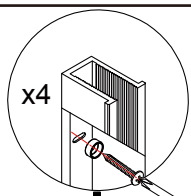

B

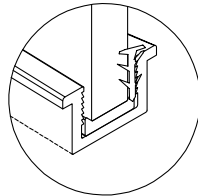
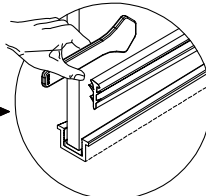
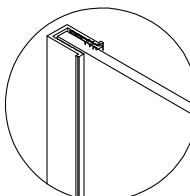
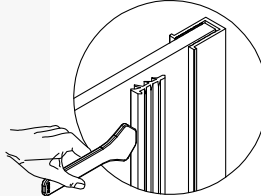

2D



Please fit your preferred stabilising solution before proceeding to apply the silicone. Information for fitting is supplied in the following steps.

Installez la solution de support de votre choix avant de poser le silicone. Vous trouverez les instructions de montage avec le kit des barres de stabilisation Flair Showers.

Installate il metodo di supporto prima di sigillare con il silicone. Le istruzioni di montaggio sono disponibili con il kit della barra di supporto Flair Showers.

