

---

CREATING  
PERFECT  
HARMONY™

# HARMONY COLLECTIONS

NI - JULY 2025



flair  
—



FIND  
YOUR  
FLAIR

ORO ETO ILI AYO

[FLAIRSHOWERS.COM](http://FLAIRSHOWERS.COM)



## AWARD WINNING PRODUCT DESIGNS

Flair's unrelenting passion for innovation has achieved International recognition in the form of numerous design award accolades.

### **GOOD DESIGN AWARD®** (CHICAGO)

Founded in 1950 by architects Eero Saarinen, Charles and Ray Eames and Edgar Kaufmann, **GOOD DESIGN®** is the world's oldest Design Awards program. It is organised annually by The Chicago Athenaeum Museum of Architecture and Design. It recognises the work of manufacturers who have undertaken the design challenge to produce product of the most outstanding design globally.

### **RED DOT DESIGN AWARD** (GERMANY)

The **Red Dot** label is recognised as a warranty of design excellence. It is awarded to entrants who demonstrate an innovative spirit with product of the highest quality, form and function gaining this design awards honour.

### **IF DESIGN AWARD** (GERMANY)

The **iF DESIGN AWARD** recognises exceptionally well-designed products. Since 1953, an esteemed jury of International design experts have awarded this symbol to product that is user focused, ergonomic and efficient in its design.

# Care, craftsmanship and quality since 1952 in the everyday.

Flair have been designing showering solutions for over 70 years and perfecting them since. Our products are beautifully designed and expertly engineered to stand the test of time in the busiest of bathrooms. From humble beginnings in Cavan, Ireland we are now a leader in creating quality showering solutions for the European market.

Flair products are beautifully designed and expertly engineered to work perfectly and stand the test of time by our team of designers in Dublin. We have a real passion for design innovation and expertly manufactured products. Attention to detail is seen in Flair's design language and careful consideration is given to every aspect of our shower enclosure and wetroom designs. Customer care is a core value for us - a happy customer is at the heart of everything we do.

Flair are proud recipients of several international design awards and hold numerous patents for our **Harmony Collections**. In recent years, our ORO, ETO, ILI and AYO product collections have all been recognised for their excellence in design, innovation and product quality.

flair  
—



# SURROUND YOURSELF WITH BEAUTY.



WATCH  
THE  
VIDEO



CREATING  
PERFECT  
HARMONY™

FLAIR SHOWERS	9
ORO® COLLECTION	12
ETO® COLLECTION	46
ILI® COLLECTION	82
AYO® COLLECTION	108
SHOWER TRAYS	162
QUALITY GUARANTEED	176





# flair

At Flair our vision is to produce beautifully designed, expertly crafted showering solutions for everyone and every space so that you can **surround yourself with beauty** and **savour those precious moments** in your everyday. We do this by pushing the frontiers of shower design, with every little detail carefully considered to make the daily routine as harmonious as possible.

For many, showering has the power to lift spirits, calm the mind and invigorate. As you step into a Flair Shower, we encourage you to savour those precious moments in your sacred daily rituals.

**Surround yourself with beauty.**

**FIND YOUR FLAIR.  
CAPTURE THE MOMENT.**



# NEW PRODUCT DEVELOPMENT.



IDEA  
CONCEPT  
PROTOTYPE

With over 70 years of design and innovation behind us, at Flair we know that quality always stands above all.

Our local design team, driven by passion, pushes the boundaries of innovation - always discovering, evolving, and learning.

Every detail is a deliberate choice, carefully crafted to reflect beautiful design in every line and finish.

This is where innovation and quality come together in perfect balance.



ORO ETO ILI AYO



## DESIGN AWARDS

Flair are proud to have received three design accolades in recognition of the ORO shower door collection.



The **Good Design** Award, **RedDot** Award, and **iF Design** Award are seals of global design excellence and a testimony to our passion for product quality and innovation.



## PATENTED MAGNETIC GUIDE

The patented Magnetic Guide System is the first of the kind in the industry. It ensures the smoothest of motion for each sliding door as it glides along the bottom rail.

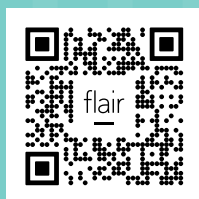

EXPLORE  
ORO

# THE ORO<sup>®</sup> COLLECTION

**ORO - the epitome of grace & beauty.**

With a graceful aesthetic, the award winning ORO collection is a union of design innovation and functional perfection. This signature collection sets the standard in frameless shower door design.

The hand crafted ORO door handles are one of a kind and distinctly individual. The patented magnetic guide system provides a smooth and effortless gliding action for each sliding door. Elegance shines through the curved profile and hinge detailing.

Each ORO detail is carefully considered to enhance your experience every day.

# FRAMELESS & ULTRA FRAMELESS 8mm SHOWER ENCLOSURE COLLECTION





FIND  
YOUR  
ORO

ORO®



SLIDING  
20



HINGE & HINGE  
AND INLINE  
28



SLIDING  
QUADRANT  
& OFFSET  
QUADRANT  
24



BIFOLD  
36



HINGED  
QUADRANT  
& OFFSET  
QUADRANT  
26



ULTRA  
FRAMELESS  
COLLECTION  
38

DOORS

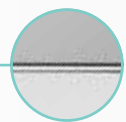

SILVER



MATTE BLACK

## FINISHES

S - Silver  
B - Matte Black







## FUNCTIONAL DETAILS

<b>8mm</b> TOUGHENED SAFETY GLASS	<b>2000mm</b> HEIGHT	<b>20mm</b> PROFILE ADJUSTMENT
ULTRA CLEAR SEALS	SEAMLESS INTERIOR COVER STRIPS	ULTRA SLIM COVER CAPS
CRAFTED HANDLE DESIGN	CLEARVUE HYDROPHOBIC GLASS COATING	<b>10mm</b> ULTRA LOW BOTTOM RAIL
CUSHION CLOSE DAMPENER MECHANISM	PATENTED MAGNETIC GUIDE SYSTEM	COUNTERSUNK INTERIOR HINGES
SHOWER TRAY OR WETROOM APPLICATION	LIFETIME GUARANTEE	



## VISIONARY INNOVATIONS



PATENTED MAGNETIC GUIDE SYSTEM PROVIDES THE SMOOTHEST OF MOTION FOR EACH SLIDING DOOR



CURVED RADIUS DESIGN DETAILING



SIGNATURE HANDLE DESIGN



CURVED HINGE DESIGN



COUNTERSUNK INTERIOR HINGES FOR EASY CLEANING



UNIQUELY CRAFTED BI-FOLD HANDLE



EXPLORE  
ORO





# SLIDING DOOR

FINISHES:

- SILVER
- MATTE BLACK

The ORO Sliding Door glides effortlessly with patented magnetic guidance, 8mm toughened glass, a floating top rail, and a uniquely designed handle for a seamless experience.



SLIDING DOOR (RIGHT HAND)  
WITH SEMI FRAMED SIDE PANEL - SILVER

DOOR SIZE OPTIONS

SIZE (mm)	ADJUSTMENT SIZE MIN (mm)    MAX (mm)		ACCESS (mm)	CODE SILVER	CODE MATTE BLACK
1100 - Left Hand	1060	1100	430	OROSA110LSC	—
1100 - Right Hand	1060	1100	430	OROSA110RSC	—
1200 - Left Hand	1160	1200	480	OROSA120LSC	OROSA120LBC
1200 - Right Hand	1160	1200	480	OROSA120RSC	OROSA120RBC
1400 - Left Hand	1360	1400	580	OROSA140LSC	OROSA140LBC
1400 - Right Hand	1360	1400	580	OROSA140RSC	OROSA140RBC
1500 - Left Hand	1460	1500	580	OROSA150LSC	OROSA150LBC
1500 - Right Hand	1460	1500	580	OROSA150RSC	OROSA150RBC
1600 - Left Hand	1560	1600	580	OROSA160LSC	—
1600 - Right Hand	1560	1600	580	OROSA160RSC	—

SEMI FRAMED SIDE PANEL OPTIONS *(Includes Corner Profile)*

SIZE (mm)	ADJUSTMENT SIZE MIN (mm)    MAX (mm)		CODE SILVER	CODE MATTE BLACK
700	670	690	OROSP70SC	OROSP70BC
760	730	750	OROSP76SC	—
800	770	790	OROSP80SC	OROSP80BC
900	870	890	OROSP90SC	OROSP90BC
1000	970	990	OROSPI00SC	—
1200	1170	1190	OROSPI20SC	—

ACCESSORIES

DESCRIPTION	CODE SILVER	CODE MATTE BLACK
20mm Compensating Wall Profile	OROCB20SC	OROCB20BC

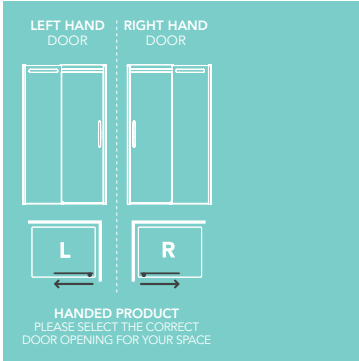

*Note: Sliding Door may also be installed to close onto Side Panel, please check door handing before ordering.*



SLIDING DOOR (LEFT HAND) IN ALCOVE -  
MATTE BLACK

SLIDING DOOR

ORO

8mm GLASS

# SLIDING DOOR WITH TWO INLINE PANELS

FINISHES:

- SILVER
- MATTE BLACK

The sliding door with two inline panels can be installed in an alcove or with a frameless side panel option and is the perfect choice for a large, luxurious showering zone.

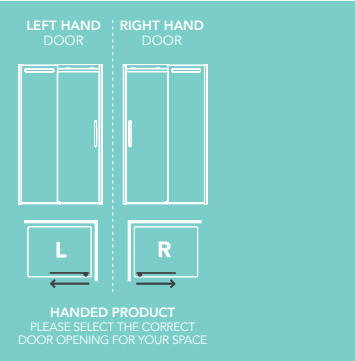

## DOOR SIZE OPTIONS

SIZE (mm)	ADJUSTMENT SIZE		ACCESS (mm)	CODE	CODE
	MIN (mm)	MAX (mm)		SILVER	MATTE BLACK
1200 - Left Hand	1160	1200	412	OROSA2IL120LSC	OROSA2IL120LBC
1200 - Right Hand	1160	1200	412	OROSA2IL120RSC	OROSA2IL120RBC
1400 - Left Hand	1360	1400	493	OROSA2IL140LSC	OROSA2IL140LBC
1400 - Right Hand	1360	1400	493	OROSA2IL140RSC	OROSA2IL140RBC
1500 - Left Hand	1460	1500	542	OROSA2IL150LSC	OROSA2IL150LBC
1500 - Right Hand	1460	1500	542	OROSA2IL150RSC	OROSA2IL150RBC
1600 - Left Hand	1560	1600	542	OROSA2IL160LSC	OROSA2IL160LBC
1600 - Right Hand	1560	1600	542	OROSA2IL160RSC	OROSA2IL160RBC
1700 - Left Hand	1660	1700	614	OROSA2IL170LSC	OROSA2IL170LBC
1700 - Right Hand	1660	1700	614	OROSA2IL170RSC	OROSA2IL170RBC
1800 - Left Hand	1760	1800	614	OROSA2IL180LSC	OROSA2IL180LBC
1800 - Right Hand	1760	1800	614	OROSA2IL180RSC	OROSA2IL180RBC
1900 - Left Hand	1860	1900	614	OROSA2IL190LSC	—
1900 - Right Hand	1860	1900	614	OROSA2IL190RSC	—
2000 - Left Hand	1960	2000	614	OROSA2IL200LSC	OROSA2IL200LBC
2000 - Right Hand	1960	2000	614	OROSA2IL200RSC	OROSA2IL200RBC

## FRAMELESS SIDE PANEL OPTIONS \*To suit sliding door with two inline panels only.

SIZE (mm)	ADJUSTMENT SIZE		CODE	CODE
	MIN (mm)	MAX (mm)	SILVER	MATTE BLACK
700 (SA2IL specific)	660	680	OROSA2ILSP70SC	OROSA2ILSP70BC
800 (SA2IL specific)	760	780	OROSA2ILSP80SC	OROSA2ILSP80BC
900 (SA2IL specific)	860	880	OROSA2ILSP90SC	OROSA2ILSP90BC
1000 (SA2IL specific)	960	980	OROSA2ILSP100SC	OROSA2ILSP100BC
1200 (SA2IL specific)	1160	1180	OROSA2ILSP120SC	OROSA2ILSP120BC

Note - Two side panels can be made used to make a three sided enclosure.



RIGHT HAND SLIDING DOOR WITH TWO INLINE PANELS AND FRAMELESS SIDE PANEL\* - SILVER

SLIDING DOOR WITH TWO INLINE PANELS

ORO

8mm GLASS



# SLIDING QUADRANT & SLIDING OFFSET QUADRANT DOOR

FINISHES:

- SILVER
- MATTE BLACK

The ORO Sliding Quadrant blends creative engineering with a floating top rail, concealed rollers, and a patented magnetic guide for effortless gliding and a sleek, polished look.

The ORO Sliding Offset Quadrant impresses with a floating rail, concealed rollers, a patented magnetic guide for smooth gliding, and perfectly symmetrical chrome handle.

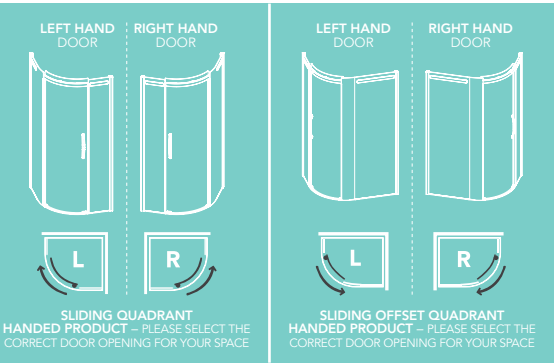

SLIDING OFFSET QUADRANT (LEFT HAND) - SILVER  
(To suit left hand offset quadrant shower tray)

## SLIDING QUADRANT – DOOR SIZE OPTIONS

SIZE (mm)	ADJUSTMENT SIZE		ACCESS (mm)	CODE SILVER	CODE MATTE BLACK
	MIN (mm)	MAX (mm)			
900 - Left Hand	870	890	480	OROSQ90LSC	OROSQ90LBC
900 - Right Hand	870	890	480	OROSQ90RSC	OROSQ90RBC
1000 - Left Hand	970	990	480	OROSQ100LSC	OROSQ100LBC
1000 - Right Hand	970	990	480	OROSQ100RSC	OROSQ100RBC

## SLIDING OFFSET QUADRANT – DOOR SIZE OPTIONS

SIZE (mm)	ADJUSTMENT SIZE		ACCESS (mm)	CODE SILVER	CODE MATTE BLACK
	MIN (mm)	MAX (mm)			
1000 x 800 - Left Hand	770-970	790-990	480	OROSQ80X100LSC	—
1000 x 800 - Right Hand	770-970	790-990	480	OROSQ80X100RSC	—
1000 x 900 - Left Hand	870-970	890-990	480	OROSQ90X100LSC	—
1000 x 900 - Right Hand	870-970	890-990	480	OROSQ90X100RSC	—
1200 x 800 - Left Hand	770-1170	790-1190	480	OROSQ80X120LSC	OROSQ80X120LBC
1200 x 800 - Right Hand	770-1170	790-1190	480	OROSQ80X120RSC	OROSQ80X120RBC
1200 x 900 - Left Hand	870-1170	890-1190	480	OROSQ90X120LSC	OROSQ90X120LBC
1200 x 900 - Right Hand	870-1170	890-1190	480	OROSQ90X120RSC	OROSQ90X120RBC

## ACCESSORIES

DESCRIPTION	CODE SILVER	CODE MATTE BLACK
20mm Compensating Wall Profile	OROCB20SC	OROCB20BC



SLIDING QUADRANT (RIGHT HAND) - MATTE BLACK

SLIDING QUADRANT & OFFSET QUADRANT DOOR

ORO

8mm GLASS



# HINGED QUADRANT & OFFSET HINGED QUADRANT DOOR

FINISHES:

- SILVER
- MATTE BLACK

The ORO Hinged Quadrant exudes elegance with frameless curved glass, seamless stabilising bars, flush hinges for easy cleaning, and ultra-clear magnetic seals for a perfect close.

The ORO Offset Hinged Quadrant sets the standard in frameless design with curved glass, minimalist stabilising bars, flush hinges for easy cleaning, and ultra-clear magnetic seals for a perfect close.

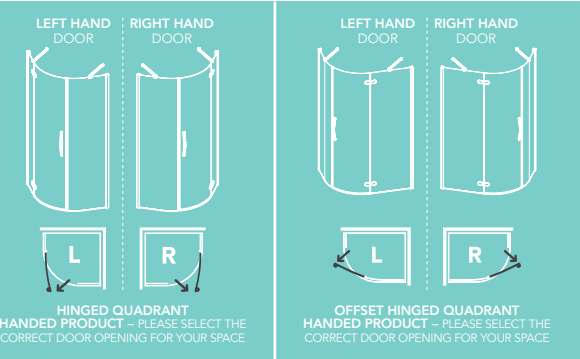

HINGED  
OFFSET  
QUADRANT  
(LEFT HAND) -  
SILVER



## HINGED QUADRANT – DOOR SIZE OPTIONS

SIZE (mm)	ADJUSTMENT SIZE		ACCESS (mm)	CODE SILVER	CODE MATTE BLACK
MIN (mm)	MAX (mm)				
900 - Left Hand	870	890	570	OROHQ90LSC	OROHQ90LBC
900 - Right Hand	870	890	570	OROHQ90RSC	OROHQ90RBC
1000 - Left Hand	970	990	570	OROHQ100LSC	OROHQ100LBC
1000 - Right Hand	970	990	570	OROHQ100RSC	OROHQ100RBC

## OFFSET HINGED QUADRANT – DOOR SIZE OPTIONS

SIZE (mm)	ADJUSTMENT SIZE		ACCESS (mm)	CODE SILVER	CODE MATTE BLACK
MIN (mm)	MAX (mm)				
1000 x 800 - Left Hand	770-970	790-990	570	OROHQ80X100LSC	—
1000 x 800 - Right Hand	770-970	790-990	570	OROHQ80X100RSC	—
1000 x 900 - Left Hand	870-970	890-990	570	OROHQ90X100LSC	—
1000 x 900 - Right Hand	870-970	890-990	570	OROHQ90X100RSC	—
1200 x 800 - Left Hand	770-1170	790-1190	570	OROHQ80X120LSC	OROHQ80X120LBC
1200 x 800 - Right Hand	770-1170	790-1190	570	OROHQ80X120RSC	OROHQ80X120RBC
1200 x 900 - Left Hand	870-1170	890-1190	570	OROHQ90X120LSC	OROHQ90X120LBC
1200 x 900 - Right Hand	870-1170	890-1190	570	OROHQ90X120RSC	OROHQ90X120RBC

## ACCESSORIES

DESCRIPTION	CODE SILVER	CODE MATTE BLACK
20mm Compensating Wall Profile	OROCB20SC	OROCB20BC



HINGED QUADRANT (LEFT HAND) -  
MATTE BLACK

# HINGE DOOR

FINISHES:

- SILVER
- MATTE BLACK

The 8mm ORO Hinged Door is perfect for small spaces, with frameless curved detailing, concealed fixings, flush hinges for easy cleaning, and ultra-clear magnetic seals for a smooth, precise close.



HINGE DOOR IN ALCOVE - MATTE BLACK

STAINLESS  
STEEL  
STRAIGHT  
STABILISING  
BAR

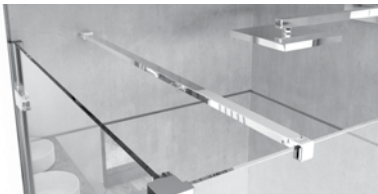

DOOR SIZE OPTIONS

SIZE (mm)	ADJUSTMENT SIZE MIN (mm) MAX (mm)		ACCESS (mm)	CODE SILVER	CODE MATTE BLACK
800	760	800	660	OROHD80SC	OROHD80BC
900	860	900	760	OROHD90SC	OROHD90BC
1000	960	1000	860	OROHD100SC	—

SEMI FRAMED SIDE PANEL OPTIONS *(Includes Corner Profile)*

SIZE (mm)	ADJUSTMENT SIZE MIN (mm) MAX (mm)		CODE SILVER	CODE MATTE BLACK
700	670	690	OROSP70SC	OROSP70BC
760	730	750	OROSP76SC	OROSP76BC
800	770	790	OROSP80SC	OROSP80BC
900	870	890	OROSP90SC	OROSP90BC
1000	970	990	OROSPI00SC	—
1200	1170	1190	OROSPI20SC	—

ACCESSORIES

DESCRIPTION	CODE SILVER	CODE MATTE BLACK
20mm Compensating Wall Profile	OROCB20SC	OROCB20BC
Straight Stabilising Bar 1050mm	S-ORO105SSB	S-ORO105SSBMB

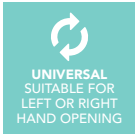

UNIVERSAL  
SUITABLE FOR  
LEFT OR RIGHT  
HAND OPENING

Note: Stabilising bar must be purchased with the hinge door and semi framed side panel with silver or black corner profile.



HINGE DOOR WITH SEMI FRAMED SIDE PANEL - SILVER

HINGE DOOR

ORO

8mm GLASS

# INLINE PANEL TO SUIT HINGE DOOR

FINISHES:

- SILVER
- MATTE BLACK

The ORO hinge door with an inline panel offers a sleek, frameless design for alcove installation, combining elegance with flexible sizing.

INLINE PANEL OPTIONS

SIZE (mm)	CODE SILVER	CODE MATTE BLACK
100 (No Stabilising Bar Required)	OROIL10SC	—
200 (No Stabilising Bar Required)	OROIL20SC	—
300 (450mm Stabilising Bar Included)	OROIL30SC	OROIL30BC
400 (450mm Stabilising Bar Included)	OROIL40SC	OROIL40BC
500 (450mm Stabilising Bar Included)	OROIL50SC	—
600 (450mm Stabilising Bar Included)	OROIL60SC	—

DOOR SIZE OPTIONS

SIZE (mm)	ADJUSTMENT SIZE MIN (mm) MAX (mm)		ACCESS (mm)	CODE SILVER	CODE MATTE BLACK
800	760	800	660	OROHD80SC	OROHD80BC
900	860	900	760	OROHD90SC	OROHD90BC
1000	960	1000	860	OROHD100SC	—

BOTTOM BARRIER BAR –  
TO SUIT HINGE DOOR WITH INLINE PANEL APPLICATION

DESCRIPTION	CODE SILVER	CODE MATTE BLACK
Bottom Barrier Bar   600mm	OROILBB-BFHDS	OROILBB-BFHDB

Note: Inline panels only suitable for alcove or recess application (not compatible with side panels).



HINGE DOOR WITH INLINE PANEL IN ALCOVE - SILVER



# HINGE & INLINE DOOR

FINISHES:

- SILVER
- MATTE BLACK

The ORO Hinge & Inline Door makes a bold statement with curved flush hinges, a sleek T-bar stabiliser, ultra-clear magnetic seals, and perfectly symmetrical chrome handles for effortless elegance.



HINGE & INLINE DOOR (LEFT HAND)  
IN ALCOVE - SILVER

DOOR SIZE OPTIONS

SIZE (mm)	ADJUSTMENT SIZE		ACCESS (mm)	CODE	CODE
	MIN (mm)	MAX (mm)		SILVER	MATTE BLACK
1100 - Left Hand	1060	1100	740	OROHD110LSC	—
1100 - Right Hand	1060	1100	740	OROHD110RSC	—
1200 - Left Hand	1160	1200	740	OROHD120LSC	OROHD120LBC
1200 - Right Hand	1160	1200	740	OROHD120RSC	OROHD120RBC
1400 - Left Hand	1360	1400	740	OROHD140LSC	—
1400 - Right Hand	1360	1400	740	OROHD140RSC	—
1600 - Left Hand	1560	1600	740	OROHD160LSC	—
1600 - Right Hand	1560	1600	740	OROHD160RSC	—

SEMI FRAMED SIDE PANEL OPTIONS *(Includes Corner Profile)*

SIZE (mm)	ADJUSTMENT SIZE		CODE	CODE
	MIN (mm)	MAX (mm)	SILVER	MATTE BLACK
700	670	690	OROSP70SC	OROSP70BC
760	730	750	OROSP76SC	OROSP76BC
800	770	790	OROSP80SC	OROSP80BC
900	870	890	OROSP90SC	OROSP90BC
1000	970	990	OROSP100SC	—
1200	1170	1190	OROSP120SC	—

ACCESSORIES

DESCRIPTION	CODE	CODE
	SILVER	MATTE BLACK
20mm Compensating Wall Profile	OROCB20SC	OROCB20BC
Straight Stabilising Bar 1600mm with T Piece	S-ORO160SSB+TB	S-ORO160SSBMB+TB

*Note: Stabilising bar must be purchased with the hinge and inline door and semi framed side panel. Stabilising bar is standard 1600mm and can be resized to suit all door sizes.*

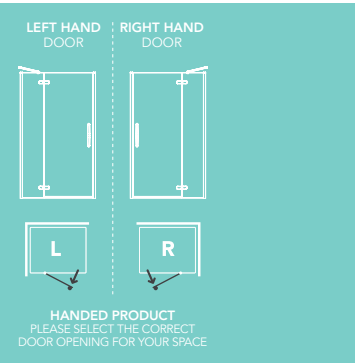

HINGE & INLINE OPEN POSITION MEASUREMENTS		
DOOR SIZE	FIXED INLINE PANEL SIZE	DOOR OPEN EXTERNAL PROTRUSION*
1100mm	350mm	770mm
1200mm	400mm	770mm
1400mm	600mm	770mm
1600mm	750mm	770mm
*Door opens to 90° angle.		



HINGE & INLINE DOOR (LEFT HAND) WITH  
SEMI FRAMED SIDE PANEL - MATTE BLACK

HINGE & INLINE DOOR

ORO

8mm GLASS

# INLINE PANEL TO SUIT HINGE & INLINE DOOR

FINISHES:

- SILVER
- MATTE BLACK

The ORO Hinge & Inline Door pairs frameless elegance with 8mm Clearvue-coated glass and flush hinges, offering a spacious feel and effortless cleaning without compromising functionality.

## INLINE PANEL OPTIONS

SIZE (mm)	CODE SILVER	CODE MATTE BLACK
100 (No Stabilising Bar Required)	OROIL10SC	—
200 (No Stabilising Bar Required)	OROIL20SC	—
300 (450mm Stabilising Bar Included)	OROIL30SC	OROIL30BC
400 (450mm Stabilising Bar Included)	OROIL40SC	OROIL40BC
500 (450mm Stabilising Bar Included)	OROIL50SC	—
600 (450mm Stabilising Bar Included)	OROIL60SC	—

## DOOR SIZE OPTIONS

SIZE (mm)	ADJUSTMENT SIZE MIN (mm)	MAX (mm)	ACCESS (mm)	CODE SILVER	CODE MATTE BLACK
1100 - Left Hand	1060	1100	740	OROHD110LSC	—
1100 - Right Hand	1060	1100	740	OROHD110RSC	—
1200 - Left Hand	1160	1200	740	OROHD120LSC	OROHD120LBC
1200 - Right Hand	1160	1200	740	OROHD120RSC	OROHD120RBC
1400 - Left Hand	1360	1400	740	OROHD140LSC	—
1400 - Right Hand	1360	1400	740	OROHD140RSC	—
1600 - Left Hand	1560	1600	740	OROHD160LSC	—
1600 - Right Hand	1560	1600	740	OROHD160RSC	—

## BOTTOM BARRIER BAR – TO SUIT HINGE DOOR WITH INLINE PANEL APPLICATION

DESCRIPTION	CODE SILVER	CODE MATTE BLACK
Bottom Barrier Bar 2200mm	OROILBB-HDILS	OROILBB-HDILB

Note: Inline panels only suitable for alcove or recess application (not compatible with side panels).



HINGE & INLINE DOOR WITH INLINE PANEL IN ALCOVE - SILVER



# BIFOLD DOOR

FINISHES:

- SILVER
- MATTE BLACK

The ORO Bifold Door features an innovative 180° hinge for flexible inwards and outwards opening, self-stop action, and exceptional stability, all complemented by its signature handle design.



BIFOLD DOOR WITH SEMI FRAMED SIDE PANEL - SILVER

DOOR SIZE OPTIONS

SIZE (mm)	ADJUSTMENT SIZE MIN (mm)	ADJUSTMENT SIZE MAX (mm)	ACCESS (mm)	CODE SILVER	CODE MATTE BLACK
700	660	700	483	OROBF70SC	—
760	720	760	538	OROBF76SC	—
800	760	800	575	OROBF80SC	OROBF80BC
900	860	900	668	OROBF90SC	OROBF90BC
1000	960	1000	759	OROBFI00SC	OROBFI00BC

SEMI FRAMED SIDE PANEL OPTIONS *(Includes Corner Profile)*

SIZE (mm)	ADJUSTMENT SIZE MIN (mm)	ADJUSTMENT SIZE MAX (mm)	CODE SILVER	CODE MATTE BLACK
700	670	690	OROSP70SC	OROSP70BC
760	730	750	OROSP76SC	OROSP76BC
800	770	790	OROSP80SC	OROSP80BC
900	870	890	OROSP90SC	OROSP90BC
1000	970	990	OROSPI00SC	—
1200	1170	1190	OROSPI20SC	—

ACCESSORIES

DESCRIPTION	CODE SILVER	CODE MATTE BLACK
20mm Compensating Wall Profile	OROCB20SC	OROCB20BC
Straight Stabilising Bar 1050mm	S-ORO105HSSB	S-ORO105HSSBMB

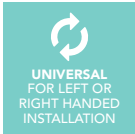

Note: Stabilising bar must be purchased with the bifold door and semi framed side panel with silver or black corner profile.



BIFOLD DOOR IN ALCOVE - MATTE BLACK

BIFOLD DOOR

ORO

8mm GLASS

# HINGE DOOR WITH ULTRA FRAMELESS CORNER SIDE PANEL

FINISHES:

- SILVER
- MATTE BLACK

The ORO Hinge Door and ultra-frameless corner side panel offer modular flexibility, sleek styling, and durable support with a minimalist chrome stabilising bar.

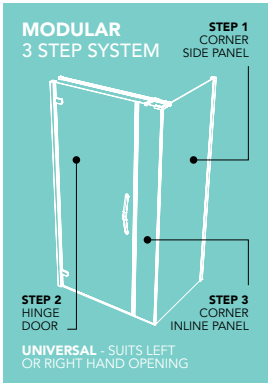

## STEP 1 - SELECT SIZE OF ULTRA FRAMELESS CORNER SIDE PANEL

SIZE (mm)	ADJUSTMENT SIZE MIN (mm) MAX (mm)		ACCESS (mm)	CODE SILVER	CODE MATTE BLACK
700	660	680		OROCSP70SC	—
760	720	740		OROCSP76SC	—
800	760	780		OROCSP80SC	OROCSP80BC
900	860	880		OROCSP90SC	OROCSP90BC
1000	960	980		OROCSP100SC	—

## STEP 2 - SELECT SIZE OF DOOR

SIZE (mm)	ADJUSTMENT SIZE MIN (mm) MAX (mm)		ACCESS (mm)	CODE SILVER	CODE MATTE BLACK
800	760	800	660	OROHD80SC	OROHD80BC
900	860	900	760	OROHD90SC	OROHD90BC
1000	960	1000	860	OROHD100SC	—

## STEP 3 - CHOOSE CORNER INLINE PANEL KIT SIZE

SIZE (mm)	CODE SILVER	CODE MATTE BLACK
100	OROKIT1	—
200	OROKIT2	—
300	OROKIT3	OROKIT3B
400	OROKIT4	OROKIT4B



NOTE: HINGE DOOR SIZE PLUS CORNER INLINE PANEL SIZE WILL TOTAL TO THE WIDTH OF YOUR SHOWER TRAY.  
Each corner inline panel kit includes the following components: inline panel, bottom barrier bar and stabilising bar with fixing brackets.  
Ultra clear seal or 3M tape option supplied for corner inline panel fixation.



HINGE DOOR WITH ULTRA FRAMELESS CORNER SIDE PANEL

ORO

8mm GLASS



# HINGE AND INLINE DOOR WITH ULTRA FRAMELESS CORNER SIDE PANEL

FINISHES:

SILVER

MATTE BLACK

The ORO Hinge and Inline door with an ultra-frameless corner panel creates a bold style statement, ideal for spacious showers with durable, minimalist support.

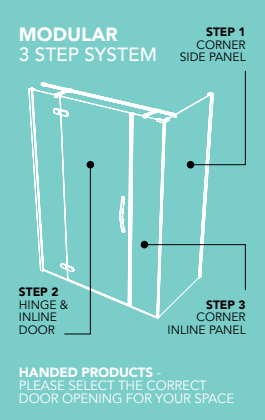

HINGE AND INLINE DOOR (LEFT HAND) WITH  
ULTRA FRAMELESS CORNER SIDE PANEL - SILVER

## STEP 1 - SELECT SIZE OF ULTRA FRAMELESS CORNER SIDE PANEL

SIZE (mm)	ADJUSTMENT SIZE		CODE	CODE
	MIN (mm)	MAX (mm)	SILVER	MATTE BLACK
700	660	680	OROCSP70SC	—
760	720	740	OROCSP76SC	—
800	760	780	OROCSP80SC	OROCSP80BC
900	860	880	OROCSP90SC	OROCSP90BC
1000	960	980	OROCSP100SC	—

## STEP 2 - SELECT SIZE OF DOOR

SIZE (mm)	ADJUSTMENT SIZE		ACCESS (mm)	CODE	CODE
	MIN (mm)	MAX (mm)		SILVER	MATTE BLACK
1100 - Left Hand	1060	1100	740	OROHD110LSC	—
1100 - Right Hand	1060	1100	740	OROHD110RSC	—
1200 - Left Hand	1160	1200	740	OROHD120LSC	OROHD120LBC
1200 - Right Hand	1160	1200	740	OROHD120RSC	OROHD120RBC

## STEP 3 - CHOOSE CORNER INLINE PANEL KIT SIZE

SIZE (mm)	CODE	CODE
	SILVER	MATTE BLACK
100	OROKIT5	—
200	OROKIT6	—
300	OROKIT7	OROKIT7B
400	OROKIT8	OROKIT8B

NOTE: HINGE AND INLINE DOOR SIZE PLUS CORNER INLINE PANEL SIZE WILL TOTAL TO THE WIDTH OF YOUR SHOWER TRAY.  
Tolerance of 20mm in the inline panel measurement reflecting the 20mm profile adjustment.  
Each corner inline panel kit includes the following components: inline panel, bottom barrier bar and stabilising bar with fixing brackets.  
Ultra clear seal or 3M tape option supplied for corner inline panel fixation.

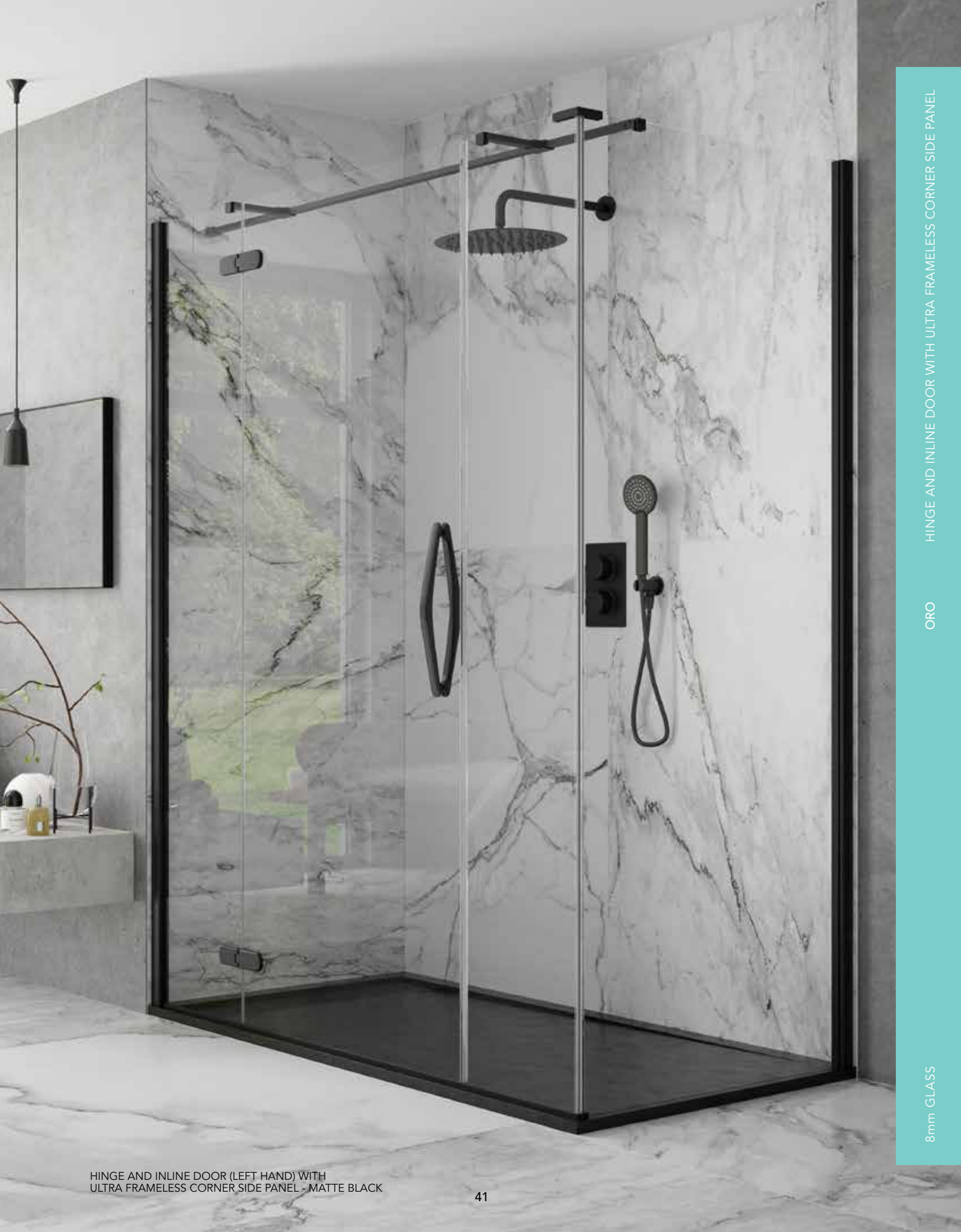

HINGE AND INLINE DOOR (LEFT HAND) WITH  
ULTRA FRAMELESS CORNER SIDE PANEL - MATTE BLACK

# BIFOLD DOOR WITH ULTRA FRAMELESS CORNER SIDE PANEL

FINISHES:

- SILVER
- MATTE BLACK

The ORO Bifold with an ultra-frameless corner panel offers versatile two-way opening, featuring a self-stop hinge and a raised stabilising bar for seamless functionality.

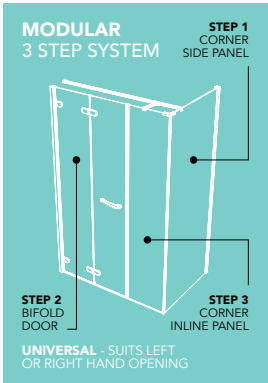

BIFOLD DOOR WITH ULTRA FRAMELESS CORNER SIDE PANEL - SILVER

## STEP 1 - SELECT SIZE OF ULTRA FRAMELESS CORNER SIDE PANEL

SIZE (mm)	ADJUSTMENT SIZE MIN (mm)	ADJUSTMENT SIZE MAX (mm)	ACCESS (mm)	CODE SILVER	CODE MATTE BLACK
700	660	680		OROCSP70SC	—
760	720	740		OROCSP76SC	—
800	760	780		OROCSP80SC	OROCSP80BC
900	860	880		OROCSP90SC	OROCSP90BC
1000	960	980		OROCSP100SC	—

## STEP 2 - SELECT SIZE OF DOOR

SIZE (mm)	ADJUSTMENT SIZE MIN (mm)	ADJUSTMENT SIZE MAX (mm)	ACCESS (mm)	CODE SILVER	CODE MATTE BLACK
700	660	700	483	OROBF70SC	—
760	720	760	538	OROBF76SC	—
800	760	800	575	OROBF80SC	OROBF80BC
900	860	900	668	OROBF90SC	OROBF90BC
1000	960	1000	759	OROBFI00SC	OROBFI00BC

## STEP 3 - CHOOSE CORNER INLINE PANEL KIT SIZE

SIZE (mm)	CODE SILVER	CODE MATTE BLACK
100	OROKIT1	—
200	OROKIT2	—
300	OROKIT3	OROKIT3B
400	OROKIT4	OROKIT4B



NOTE: BIFOLD DOOR SIZE PLUS CORNER INLINE PANEL SIZE WILL TOTAL TO THE WIDTH OF YOUR SHOWER TRAY.  
Each corner inline panel kit includes the following components: Inline panel, bottom barrier bar and stabilising bar with fixing brackets.  
Ultra clear seal or 3M tape option supplied for corner inline panel fixation.



BIFOLD DOOR WITH ULTRA FRAMELESS CORNER SIDE PANEL - MATTE BLACK



# ALTERNATIVE HANDLES

FINISHES:

- SILVER
- MATTE BLACK

An alternative choice of ORO handle design is available.

Created to deliver a sleek and contemporary aesthetic, these additional handle options are available in a Polished Chrome or Matte Black finish.



DESCRIPTION	CODE CHROME	CODE MATTE BLACK
ORO Alternative Handle (Compatible with all ORO doors except bifold)	S-OROHLE2	S-OROHLE2B
ORO Alternative Handle for Bifold	S-ETO-OROHLE1	S-ETO-OROHLE1B

# WATER RETENTION

For detailed information on water retention and recommended installation options, scan the QR code to access our Water Retention Guide.





## DESIGN AWARD

Flair are proud to have received the **Good Design** Award accolade in recognition of the ETO shower door collection.

The **Good Design** Award is a seal of global design excellence and a testimony to our passion for product quality and innovation.



## PATENTED CLICK FIT ASSEMBLY SYSTEM

This screw free assembly mechanism revolutionises the way ETO shower doors are fitted, reducing assembly time dramatically for installers.



EXPLORE  
ETO

# THE ETO<sup>®</sup> COLLECTION

Experience elegant practicality with ETO.

Crafted to seamlessly integrate into your daily routine, the ETO shower door collection combines robust design with clever functional innovations.

The uniquely shaped handle is beautifully precise and features a cleverly integrated towel hook. Softly curved hinges with a countersunk finish and a slim profile design create a refined shower door aesthetic.

The stylish yet functional simplicity of the ETO collection embodies Design with Purpose, a concept which lies at the heart of this collection.

## FRAMED 8mm SHOWER ENCLOSURE COLLECTION





FIND  
YOUR  
ETO

ETO®

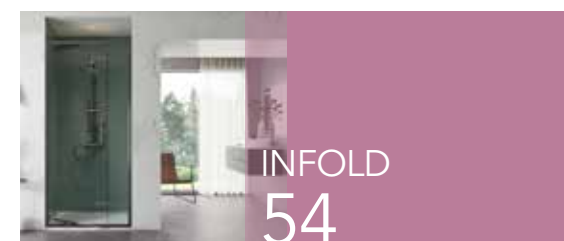

INFOLD  
54



ONE DOOR  
QUADRANT  
& OFFSET  
QUADRANT  
72



HINGE & HINGE  
AND INLINE  
58



TWO DOOR  
QUADRANT  
& OFFSET  
QUADRANT  
76

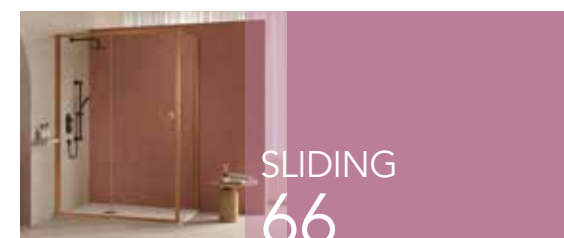

SLIDING  
66

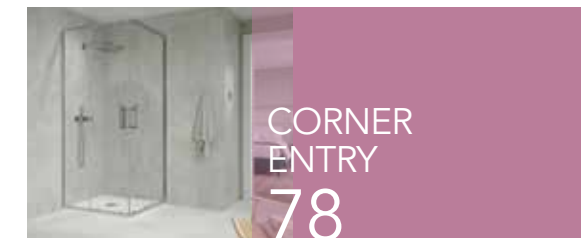

CORNER  
ENTRY  
78

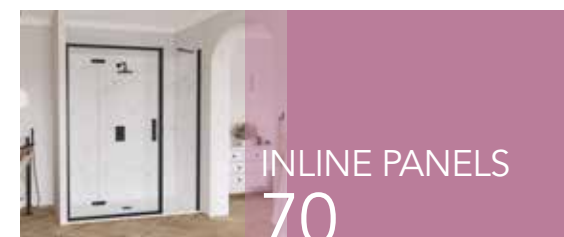

INLINE PANELS  
70

# DOORS

- SILVER
- MATTE BLACK
- GUNMETAL GREY
- BRUSHED BRASS
- BRUSHED NICKEL
- BRUSHED BRONZE

# FINISHES

S - Silver  
 B - Matte Black  
 GM - Gunmetal Grey  
 BRB - Brushed Brass  
 BRN - Brushed Nickel  
 BRZC - Brushed Bronze

ETO sliding quadrant door in Brushed Bronze.



ONE DOOR OFFSET QUADRANT -  
 BRUSHED BRONZE





## FUNCTIONAL DETAILS

<b>8mm</b> TOUGHENED SAFETY GLASS	<b>2000mm</b> HEIGHT	<b>20mm</b> PROFILE ADJUSTMENT
ULTRA CLEAR SEALS	SEAMLESS INTERIOR COVER STRIPS	ULTRA SLIM COVER CAPS
CRAFTED HANDLE DESIGN	CLEARVUE HYDROPHOBIC GLASS COATING	PRESS FIT SEAL DESIGN
PRE-ASSEMBLED PROFILE FRAME	SHOWER TRAY OR WETROOM APPLICATION	LIFETIME GUARANTEE
SUITABLE FOR SIDE PANEL INSTALLATION	PATENTED MAGNETIC GUIDE SYSTEM	COUNTERSUNK INTERIOR HINGES
QUICK RELEASE DOUBLE WHEEL ROLLERS	REVERSIBLE	



Gemstone Onyx Black tray.



## VISIONARY INNOVATIONS



MAGNETIC INFOLD LINKAGE SYSTEM FOR SMOOTH SEAMLESS GLIDING MOTION



ULTRA SLIM PROFILE AND COVER CAP



UNIQUELY CRAFTED HANDLE WITH INTEGRATED ROBE HOOK



SOFTLY CURVED HINGE DESIGN



COUNTERSUNK INTERIOR HINGES FOR EASY CLEANING





# INFOLD DOOR

FINISHES:

- SILVER
- MATTE BLACK
- GUNMETAL GREY

- BRUSHED BRASS
- BRUSHED NICKEL
- BRUSHED BRONZE

The ETO Infold blends elegance with practicality, featuring a space-saving outward-opening design, smooth magnetic linkage for seamless glass edges, and 8mm toughened safety glass with ClearVue coating.



INFOLD DOOR WITH SEMI FRAMED SIDE PANEL - MATTE BLACK

INFOLD - DOOR OPEN POSITION MEASUREMENTS

INTERIOR MEASUREMENTS

EXTERIOR MEASUREMENTS

INFOLD DOOR (mm)	INTERIOR SIZE (mm)	EXTERIOR SIZE (mm)
700	250	292
760	250	352
800	250	392
900	357	386
1000	357	486

DOOR SIZE OPTIONS

SIZE (mm)	ADJUSTMENT SIZE MIN (mm)    MAX (mm)		ACCESS (mm)	CODE SILVER	CODE MATTE BLACK	CODE GM / GREY
700	650	690	496	ETOIF70SC	ETOIF70BC	—
760	710	750	556	ETOIF76SC	ETOIF76BC	—
800	750	790	596	ETOIF80SC	ETOIF80BC	ETOIF80GMC
900	850	890	696	ETOIF90SC	ETOIF90BC	ETOIF90GMC
1000	950	990	796	ETOIF100SC	ETOIF100BC	ETOIF100GMC

SEMI FRAMED SIDE PANEL OPTIONS *(Includes Corner Profile)*

SIZE (mm)	ADJUSTMENT SIZE MIN (mm)    MAX (mm)		CODE SILVER	CODE MATTE BLACK	CODE GM / GREY
700	660	680	ETOSP70SC	ETOSP70BC	ETOSP70GMC
760	720	740	ETOSP76SC	ETOSP76BC	—
800	760	780	ETOSP80SC	ETOSP80BC	ETOSP80GMC
900	860	880	ETOSP90SC	ETOSP90BC	ETOSP90GMC
1000	960	980	ETOSP100SC	ETOSP100BC	—
1100	1060	1080	ETOSPI10SC	—	—
1200	1160	1180	ETOSPI20SC	ETOSPI20BC	—

ACCESSORIES

DESCRIPTION	CODE SILVER	CODE MATTE BLACK	CODE GM / GREY
10mm Compensating Wall Profile*	ETOCB10SC	ETOCB10BC	—
25mm Compensating Wall Profile	ETOCB25SC	ETOCB25BC	ETOCB25GM

NOTE: An ETO Infold installed with a side panel must be installed with the 10mm compensating profile supplied. Infold Door is also suitable to be installed with an Inline Panel - For size options, please see page 70. \*10mm Compensating Wall Profile included with side panel.



INFOLD DOOR IN ALCOVE - GUNMETAL GREY



# INFOLD DOOR

FINISHES:

SILVER   MATTE BLACK   GUNMETAL GREY

BRUSHED BRASS   BRUSHED NICKEL   BRUSHED BRONZE

The ETO Infold blends elegance with practicality, featuring a space-saving outward-opening design, smooth magnetic linkage for seamless glass edges, and 8mm toughened safety glass with ClearVue coating.



INFOLD DOOR IN ALCOVE - BRUSHED BRASS

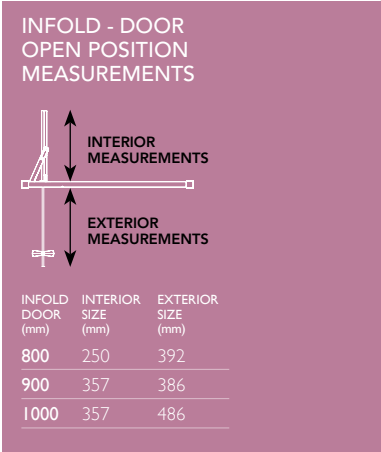

DOOR SIZE OPTIONS

SIZE (mm)	ADJUSTMENT SIZE		ACCESS (mm)	CODE BRUSHED BRASS	CODE BRUSHED NICKEL	CODE BRUSHED BRONZE
	MIN (mm)	MAX (mm)				
800	750	790	596	ETOIF80BRBC	ETOIF80BRNC	ETOIF80BRZC
900	850	890	696	ETOIF90BRBC	ETOIF90BRNC	ETOIF90BRZC
1000	950	990	796	ETOIF100BRBC	ETOIF100BRNC	ETOIF100BRZC

SEMI FRAMED SIDE PANEL OPTIONS *(Includes Corner Profile)*

SIZE (mm)	ADJUSTMENT SIZE		CODE BRUSHED BRASS	CODE BRUSHED NICKEL	CODE BRUSHED BRONZE
	MIN (mm)	MAX (mm)			
700	660	680	ETOSP70BRBC	ETOSP70BRNC	ETOSP70BRZC
800	760	780	ETOSP80BRBC	ETOSP80BRNC	ETOSP80BRZC
900	860	880	ETOSP90BRBC	ETOSP90BRNC	ETOSP90BRZC
1000	960	980	ETOSP100BRBC	—	—

ACCESSORIES

DESCRIPTION	CODE BRUSHED BRASS	CODE BRUSHED NICKEL	CODE BRUSHED BRONZE
10mm Compensating Wall Profile*	ETOCB10BRB	—	—
25mm Compensating Wall Profile	ETOCB25BRB	ETOCB25BRN	ETOCB25BRZ

NOTE: An ETO Infold installed with a side panel must be installed with the 10mm compensating profile supplied. Infold Door is also suitable to be installed with an Inline Panel - For size options, please see page 70. \*10mm Compensating Wall Profile included with side panel.



INFOLD DOOR WITH SEMI FRAMED SIDE PANEL - BRUSHED NICKEL

# HINGE DOOR

FINISHES:

- SILVER
- MATTE BLACK
- GUNMETAL GREY
- BRUSHED BRASS
- BRUSHED NICKEL
- BRUSHED BRONZE

The ETO Hinge door combines stylish simplicity with functionality, featuring flush-to-glass hinges for easy cleaning, 8mm ClearVue-coated safety glass, and versatile installation options.



HINGE DOOR IN ALCOVE - MATTE BLACK

DOOR SIZE OPTIONS

SIZE (mm)	ADJUSTMENT SIZE MIN (mm) MAX (mm)		ACCESS (mm)	CODE SILVER	CODE MATTE BLACK	CODE GM / GREY
800	750	790	646	ETOHD80SC	ETOHD80BC	ETOHD80GMC
900	850	890	746	ETOHD90SC	ETOHD90BC	ETOHD90GMC
1000	950	990	846	ETOHD100SC	—	ETOHD100GMC

SEMI FRAMED SIDE PANEL OPTIONS *(Includes Corner Profile)*

SIZE (mm)	ADJUSTMENT SIZE MIN (mm) MAX (mm)		CODE SILVER	CODE MATTE BLACK	CODE GM / GREY
700	660	680	ETOSP70SC	ETOSP70BC	ETOSP70GMC
760	720	740	ETOSP76SC	ETOSP76BC	—
800	760	780	ETOSP80SC	ETOSP80BC	ETOSP80GMC
900	860	880	ETOSP90SC	ETOSP90BC	ETOSP90GMC
1000	960	980	ETOSPI00SC	ETOSPI00BC	—
1100	1060	1080	ETOSPI10SC	—	—
1200	1160	1180	ETOSPI20SC	ETOSPI20BC	—

ACCESSORIES

DESCRIPTION	CODE SILVER	CODE MATTE BLACK	CODE GM / GREY
10mm Compensating Wall Profile*	ETOCB10SC	ETOCB10BC	—
25mm Compensating Wall Profile	ETOCB25SC	ETOCB25BC	ETOCB25GM

NOTE: An ETO Hinge Door installed with a side panel must be installed with the 10mm compensating profile supplied. Hinge Door is also suitable to be installed with an Inline Panel - For size options, please see page 70. \*10mm Compensating Wall Profile included with side panel.



HINGE DOOR WITH SEMI FRAMED SIDE PANEL - GUNMETAL GREY



# HINGE DOOR

FINISHES:

- SILVER
- MATTE BLACK
- GUNMETAL GREY

- BRUSHED BRASS
- BRUSHED NICKEL
- BRUSHED BRONZE

The ETO Hinge door combines stylish simplicity with functionality, featuring flush-to-glass hinges for easy cleaning, 8mm ClearVue-coated safety glass, and versatile installation options.



HINGE DOOR WITH SEMI FRAMED SIDE PANEL

DOOR SIZE OPTIONS

SIZE (mm)	ADJUSTMENT SIZE		ACCESS (mm)	CODE BRUSHED BRASS	CODE BRUSHED NICKEL	CODE BRUSHED BRONZE
	MIN (mm)	MAX (mm)				
800	750	790	596	ETOHD80BRBC	ETOHD80BRNC	ETOHD80BRZC
900	850	890	646	ETOHD90BRBC	ETOHD90BRNC	ETOHD90BRZC
1000	950	990	846	ETOHD100BRBC	ETOHD100BRNC	ETOHD100BRZC

SEMI FRAMED SIDE PANEL OPTIONS *(Includes Corner Profile)*

SIZE (mm)	ADJUSTMENT SIZE		CODE BRUSHED BRASS	CODE BRUSHED NICKEL	CODE BRUSHED BRONZE
	MIN (mm)	MAX (mm)			
700	660	680	ETOSP70BRBC	ETOSP70BRNC	ETOSP70BRZC
800	760	780	ETOSP80BRBC	ETOSP80BRNC	ETOSP80BRZC
900	860	880	ETOSP90BRBC	ETOSP90BRNC	ETOSP90BRZC
1000	960	980	ETOSP100BRBC	—	—

ACCESSORIES

DESCRIPTION	CODE BRUSHED BRASS	CODE BRUSHED NICKEL	CODE BRUSHED BRONZE
10mm Compensating Wall Profile*	ETOCB10BRB	—	—
25mm Compensating Wall Profile	ETOCB25BRB	ETOCB25BRN	ETOCB25BRZ

NOTE: An ETO Hinge Door installed with a side panel must be installed with the 10mm compensating profile supplied. Hinge Door is also suitable to be installed with an Inline Panel - For size options, please see page 70. \*10mm Compensating Wall Profile included with side panel.



HINGE DOOR IN ALCOVE - BRUSHED BRASS

# HINGE & INLINE DOOR

FINISHES:

- SILVER
- MATTE BLACK
- GUNMETAL GREY
- BRUSHED BRASS
- BRUSHED NICKEL
- BRUSHED BRONZE

The ETO Hinge and Inline door is a luxurious choice for spacious bathrooms, featuring semi-framed profiles, a functional ETO handle with an integrated towel hook, and flush countersunk hinges for easy cleaning, all with ClearVue-coated glass.



HINGE & INLINE DOOR WITH SEMI FRAMED SIDE PANEL - SILVER

DOOR SIZE OPTIONS

SIZE (mm)	ADJUSTMENT SIZE MIN (mm)	MAX (mm)	ACCESS (mm)	CODE SILVER	CODE MATTE BLACK	CODE GM / GREY
1100	1050	1090	725	ETOHD110SC	—	—
1200	1150	1190	725	ETOHD120SC	ETOHD120BC	ETOHD120GMC
1300	1250	1290	725	ETOHD130SC	—	—
1400	1350	1390	725	ETOHD140SC	ETOHD140BC	ETOHD140GMC
1500	1450	1490	725	ETOHD150SC	—	—
1600	1550	1590	725	ETOHD160SC	—	—

SEMI FRAMED SIDE PANEL OPTIONS *(Includes Corner Profile)*

SIZE (mm)	ADJUSTMENT SIZE MIN (mm)	MAX (mm)	CODE SILVER	CODE MATTE BLACK	CODE GM / GREY
700	660	680	ETOSP70SC	ETOSP70BC	ETOSP70GMC
760	720	740	ETOSP76SC	ETOSP76BC	—
800	760	780	ETOSP80SC	ETOSP80BC	ETOSP80GMC
900	860	880	ETOSP90SC	ETOSP90BC	ETOSP90GMC
1000	960	980	ETOSP100SC	ETOSP100BC	—
1100	1060	1080	ETOSP110SC	—	—
1200	1160	1180	ETOSP120SC	ETOSP120BC	—

ACCESSORIES

DESCRIPTION	CODE SILVER	CODE MATTE BLACK	CODE GM / GREY
10mm Compensating Wall Profile*	ETOCB10SC	ETOCB10BC	— — —
25mm Compensating Wall Profile	ETOCB25SC	ETOCB25BC	ETOCB25GM

NOTE: An ETO Hinge & Inline Door installed with a side panel must be installed with the 10mm compensating profile supplied.  
Hinge & Inline Door is also suitable to be installed with an Inline Panel - For size options, please see page 70.  
\*10mm Compensating Wall Profile included with side panel.



HINGE & INLINE DOOR IN ALCOVE - MATTE BLACK



# HINGE & INLINE DOOR

FINISHES:

- SILVER
- MATTE BLACK
- GUNMETAL GREY
- BRUSHED BRASS
- BRUSHED NICKEL
- BRUSHED BRONZE

The ETO Hinge and Inline door is a luxurious choice for spacious bathrooms, featuring semi-framed profiles, a functional ETO handle with an integrated towel hook, and flush countersunk hinges for easy cleaning, all with ClearVue-coated glass.

DOOR SIZE OPTIONS

SIZE (mm)	ADJUSTMENT SIZE MIN (mm)    MAX (mm)		ACCESS (mm)	CODE BRUSHED BRASS	CODE BRUSHED NICKEL	CODE BRUSHED BRONZE
1200	1150	1190	725	ETOHD120BRBC	ETOHD120BRNC	ETOHD120BRZC
1400	1350	1390	725	ETOHD140BRBC	ETOHD140BRNC	ETOHD140BRZC

SEMI FRAMED SIDE PANEL OPTIONS *(Includes Corner Profile)*

SIZE (mm)	ADJUSTMENT SIZE MIN (mm)    MAX (mm)		CODE BRUSHED BRASS	CODE BRUSHED NICKEL	CODE BRUSHED BRONZE
700	660	680	ETOSP70BRBC	ETOSP70BRNC	ETOSP70BRZC
800	760	780	ETOSP80BRBC	ETOSP80BRNC	ETOSP80BRZC
900	860	880	ETOSP90BRBC	ETOSP90BRNC	ETOSP90BRZC
1000	960	980	ETOSP100BRBC	—	—

ACCESSORIES

DESCRIPTION	CODE BRUSHED BRASS	CODE BRUSHED NICKEL	CODE BRUSHED BRONZE
10mm Compensating Wall Profile*	ETOCB10BRB	—	—
25mm Compensating Wall Profile	ETOCB25BRB	ETOCB25BRN	ETOCB25BRZ

NOTE: An ETO Hinge & Inline Door installed with a side panel must be installed with the 10mm compensating profile supplied.  
Hinge & Inline Door is also suitable to be installed with an Inline Panel - For size options, please see page 70.  
\*10mm Compensating Wall Profile included with side panel.



HINGE & INLINE DOOR  
IN ALCOVE - BRUSHED BRASS



# SLIDING DOOR

## FINISHES:

SILVER   MATTE BLACK   GUNMETAL GREY

BRUSHED BRASS   BRUSHED NICKEL   BRUSHED BRONZE

The ETO Sliding Door combines minimalist profiles with durable 8mm toughened glass, smooth stainless steel wheel brackets, a magnetic cushion close, and a precision-crafted handle with an integrated towel hook.

## DOOR SIZE OPTIONS

SIZE (mm)	ADJUSTMENT SIZE MIN (mm)	ADJUSTMENT SIZE MAX (mm)	ACCESS (mm)	CODE SILVER	CODE MATTE BLACK	CODE GM / GREY
1000	950	990	370	ETOSA100SC	—	—
1100	1050	1090	420	ETOSA110SC	ETOSA110BC	—
1200	1150	1190	470	ETOSA120SC	ETOSA120BC	ETOSA120GMC
1300	1250	1290	520	ETOSA130SC	—	—
1400	1350	1390	520	ETOSA140SC	ETOSA140BC	ETOSA140GMC
1500	1450	1490	570	ETOSA150SC	ETOSA150BC	ETOSA150GMC
1600	1550	1590	570	ETOSA160SC	—	—
1700	1650	1690	570	ETOSA170SC	—	—
1800	1750	1790	570	ETOSA180SC	—	—

## SEMI FRAMED SIDE PANEL OPTIONS *(Includes Corner Profile)*

SIZE (mm)	ADJUSTMENT SIZE MIN (mm)	ADJUSTMENT SIZE MAX (mm)	CODE SILVER	CODE MATTE BLACK	CODE GM / GREY
700	660	680	ETOSP70SC	ETOSP70BC	ETOSP70GMC
760	720	740	ETOSP76SC	ETOSP76BC	—
800	760	780	ETOSP80SC	ETOSP80BC	ETOSP80GMC
900	860	880	ETOSP90SC	ETOSP90BC	ETOSP90GMC
1000	960	980	ETOSPI00SC	ETOSPI00BC	—
1100	1060	1080	ETOSPI10SC	—	—
1200	1160	1180	ETOSPI20SC	ETOSPI20BC	—

## FRAMELESS SIDE PANELS OPTIONS *(Suitable only for Sliding Door)*

SIZE (mm)	ADJUSTMENT SIZE MIN (mm)	ADJUSTMENT SIZE MAX (mm)	CODE SILVER	CODE MATTE BLACK	CODE GM / GREY
700	660	680	ETOFSP70SC	ETOFSP70BC	—
760	720	740	ETOFSP76SC	ETOFSP76BC	—
800	760	780	ETOFSP80SC	ETOFSP80BC	—
900	860	880	ETOFSP90SC	ETOFSP90BC	—
1000	960	980	ETOFSP100SC	ETOFSP100BC	—
1200	1160	1180	ETOFSP120SC	ETOFSP120BC	—

## ACCESSORIES

DESCRIPTION	CODE SILVER	CODE MATTE BLACK	CODE GM / GREY
10mm Compensating Wall Profile*	ETOCB10SC	ETOCB10BC	—
25mm Compensating Wall Profile	ETOCB25SC	ETOCB25BC	ETOCB25GM

NOTE: An ETO Sliding Door installed with a side panel must be installed with the 10mm compensating profile supplied. Sliding Door is also suitable to be installed with an Inline Panel - For size options, please see page 70.  
\*10mm Compensating Wall Profile included with side panel.



SLIDING DOOR WITH SEMI FRAMED SIDE PANEL - GUNMETAL GREY



SLIDING DOOR WITH FRAMELESS SIDE PANEL - SILVER



# SLIDING DOOR

FINISHES:

SILVER   MATTE BLACK   GUNMETAL GREY

BRUSHED BRASS   BRUSHED NICKEL   BRUSHED BRONZE

The ETO Sliding Door combines minimalist profiles with durable 8mm toughened glass, smooth stainless steel wheel brackets, a magnetic cushion close, and a precision-crafted handle with an integrated towel hook.



SLIDING DOOR IN ALCOVE -  
BRUSHED NICKEL

DOOR SIZE OPTIONS

SIZE (mm)	ADJUSTMENT SIZE		ACCESS (mm)	CODE	CODE	CODE
	MIN (mm)	MAX (mm)		BRUSHED BRASS	BRUSHED NICKEL	BRUSHED BRONZE
1100	1050	1090	420	ETOSA110BRBC	ETOSA110BRNC	—
1200	1150	1190	470	ETOSA120BRBC	ETOSA120BRNC	ETOSA120BRZC
1400	1350	1390	520	ETOSA140BRBC	ETOSA140BRNC	ETOSA140BRZC
1500	1450	1490	570	ETOSA150BRBC	ETOSA150BRNC	ETOSA150BRZC

SEMI FRAMED SIDE PANEL OPTIONS *(Includes Corner Profile)*

SIZE (mm)	ADJUSTMENT SIZE		CODE	CODE	CODE
	MIN (mm)	MAX (mm)	BRUSHED BRASS	BRUSHED NICKEL	BRUSHED BRONZE
700	660	680	ETOSP70BRBC	ETOSP70BRNC	ETOSP70BRZC
800	760	780	ETOSP80BRBC	ETOSP80BRNC	ETOSP80BRZC
900	860	880	ETOSP90BRBC	ETOSP90BRNC	ETOSP90BRZC
1000	960	980	ETOSP100BRBC	—	—

ACCESSORIES

DESCRIPTION	CODE	CODE	CODE
	BRUSHED BRASS	BRUSHED NICKEL	BRUSHED BRONZE
10mm Compensating Wall Profile*	ETOCB10BRB	—	—
25mm Compensating Wall Profile	ETOCB25BRB	ETOCB25BRN	ETOCB25BRZ

NOTE: An ETO Sliding Door installed with a side panel must be installed with the 10mm compensating profile supplied.  
Sliding Door is also suitable to be installed with an Inline Panel - For size options, please see page 70.  
\*10mm Compensating Wall Profile included with side panel.



SLIDING DOOR WITH SEMI FRAMED  
SIDE PANEL - BRUSHED BRONZE

# INLINE PANELS

FINISHES:

SILVER   MATTE BLACK   GUNMETAL GREY

BRUSHED BRASS   BRUSHED NICKEL   BRUSHED BRONZE

ETO Inline Panels provide flexible installation with various ETO door types, making them a versatile solution for a wide range of bathroom designs.

- For *Infold Door* size options, please see pages 54-57.
- For *Hinge Door* size options, please see pages 58-61.
- For *Hinge and Inline Door* size options, please see pages 62-65.
- For *Sliding Door* size options, please see pages 66-69.



INFOLD DOOR WITH INLINE PANEL ON BOTH SIDES - SILVER



HINGE AND INLINE DOOR WITH INLINE PANEL - MATTE BLACK

## INLINE PANEL OPTIONS

SIZE (mm)	CODE SILVER	CODE MATTE BLACK	CODE GM / GREY
150	ETOIL15SC	ETOIL15BC	—
200	ETOIL20SC	ETOIL20BC	—
300	ETOIL30SC	ETOIL30BC	ETOIL30GMC
400	ETOIL40SC	ETOIL40BC	ETOIL40GMC
450	ETOIL45SC	ETOIL45BC	—
500	ETOIL50SC	ETOIL50BC	—

SIZE (mm)	CODE BRUSHED BRASS	CODE BRUSHED NICKEL	CODE BRUSHED BRONZE
300	ETOIL30BRBC	ETOIL30BRNC	ETOIL30BRZC
400	ETOIL40BRBC	ETOIL40BRNC	ETOIL40BRZC

NOTE: An ETO Inline Panel can be installed on each or both sides on the Infold Door with compensating profile supplied.



INFOLD DOOR WITH INLINE PANEL - BRUSHED BRONZE



# ONE DOOR QUADRANT & OFFSET QUADRANT

FINISHES:

- SILVER
- MATTE BLACK
- GUNMETAL GREY
- BRUSHED BRASS
- BRUSHED NICKEL
- BRUSHED BRONZE

The ETO One Door Quadrant and Offset Quadrant maximises corner space with a smooth magnetic cushion close, durable stainless steel quick-release rollers, and 8mm ClearVue-coated glass. The central door opening ensures easy access while accommodating your bathroom layout.



ONE DOOR QUADRANT - GUNMETAL GREY

DOOR SIZE OPTIONS

SIZE (mm)	ADJUSTMENT SIZE MIN (mm) MAX (mm)		ACCESS (mm)	CODE SILVER	CODE MATTE BLACK	CODE GM / GREY
800	770	790	440	ETOOCQ80SC	—	—
900	870	890	484	ETOOCQ90SC	ETOOCQ90BC	ETOOCQ90GMC
1000	970	990	484	ETOOCQ100SC	ETOOCQ100BC	—
1000 x 800*	770-970	790-990	440	ETOOCQ100X80SCL	ETOOCQ100X80BCL	—
1200 x 800*	770-1170	790-1190	440	ETOOCQ120X80SCL	ETOOCQ120X80BCL	ETOOCQ120X80GMCL
1200 x 900*	870-1170	890-1190	484	ETOOCQ120X90SCL	ETOOCQ120X90BCL	ETOOCQ120X90GMCL

\*Long Side Opening



ONE DOOR OFFSET QUADRANT - MATTE BLACK



# ONE DOOR QUADRANT & OFFSET QUADRANT

FINISHES:

- SILVER
- MATTE BLACK
- GUNMETAL GREY
- BRUSHED BRASS
- BRUSHED NICKEL
- BRUSHED BRONZE

The ETO One Door Quadrant and Offset Quadrant optimises corner space with a smooth magnetic cushion close, durable stainless steel quick-release rollers, and 8mm ClearVue-coated glass. Its centrally positioned door ensures easy access while accommodating your bathroom layout.



ONE DOOR QUADRANT -  
BRUSHED NICKEL

DOOR SIZE OPTIONS

SIZE (mm)	ADJUSTMENT SIZE		ACCESS (mm)	CODE	CODE	CODE
	MIN (mm)	MAX (mm)		BRUSHED BRASS	BRUSHED NICKEL	BRUSHED BRONZE
900	870	890	484	ETOOCQ90BRBC	ETOOCQ90BRNC	ETOOCQ90BRZC
1000 x 800*	770-970	790-990	440	ETOOCQ100X80BRBCL	—	—
1200 x 800*	770-790	1170-1190	440	ETOOCQ120X80BRBCL	ETOOCQ120X80BRNCL	ETOOCQ120X80BRZCL
1200 x 900*	870-1170	890-1190	484	ETOOCQ120X90BRBCL	ETOOCQ120X90BRNCL	ETOOCQ120X90BRZCL

\*Long Side Opening



ONE DOOR OFFSET QUADRANT -  
BRUSHED BRASS



# TWO DOOR QUADRANT & OFFSET QUADRANT

FINISH:

SILVER

The Two Door Quadrant and Offset Quadrant offer contemporary elegance with smooth magnetic cushion close, 8mm ClearVue-coated glass, and durable quick-release double wheel rollers for lasting performance.



TWO DOOR OFFSET QUADRANT - SILVER

## DOOR SIZE OPTIONS

SIZE (mm)	ADJUSTMENT SIZE MIN (mm) MAX (mm)		ACCESS (mm)	CODE SILVER
900	870	890	528	ETOCQ90SC
1100 x 800	770 - 1070	790 - 1090	458	ETOCQ80X110SC
1100 x 900	870 - 1070	890 - 1090	528	ETOCQ90X110SC
1200 x 800	770 - 1170	790 - 1190	458	ETOCQ80X120SC
1200 x 900	870 - 1170	890 - 1190	528	ETOCQ90X120SC

NOTE: Dedicated 1100 x 800mm and 1100 x 900mm offset quadrant slimline shower trays now available.



TWO DOOR QUADRANT - SILVER

# CORNER ENTRY

FINISH:

SILVER

The ETO Corner Entry features a sleek semi-frameless design with space-saving corner sliding doors, flush-finish brackets, and quick-release double rollers for easy cleaning. The magnetic cushion close ensures a smooth stop, while superior magnetic seals provide a secure, watertight closure.



ETO CORNER ENTRY  
HANDLE DESIGN



SLEEK FLUSH CORNER  
BRACKET DESIGN

## DOOR SIZE OPTIONS

SIZE (mm)	ADJUSTMENT SIZE		ACCESS (mm)	CODE SILVER
	MIN (mm)	MAX (mm)		
800	770	790	392	ETOCE80SC
900	870	890	462	ETOCE90SC



CORNER ENTRY - SILVER



# ALTERNATIVE HANDLES

FINISHES:

- SILVER
- MATTE BLACK
- BRUSHED BRASS

An alternative choice of ORO handle design is available.

Created to deliver a sleek and contemporary aesthetic, these additional handle options are available in a Polished Chrome, Matte Black or Brushed Brass finish.



## ACCESSORIES

DESCRIPTION	CODE CHROME	CODE MATTE BLACK	CODE BRUSHED BRASS
ETO Alternative Handle	S-ETO-OROHLE1	S-ETO-OROHLE1B	S-ETO-OROHLE1BRB





## PATENTED CLICK FIT ASSEMBLY SYSTEM

This screw free assembly mechanism revolutionises the way ILI shower doors are fitted, reducing assembly time dramatically for installers.



EXPLORE  
ILI

# THE ILI<sup>®</sup> COLLECTION

Embrace everyday adventure with ILI.

ILI is a fusion of original style and practical affordability. Crafted from 6mm glass, the unique handle features a cleverly integrated towel hook. The minimalist profiles and neatly curved hinges give simple, clean lines to the door aesthetic.

Each sliding door features a silent wheel track system while clearvue coating ensuring the shower door glass remains sparkling clean.

# FRAMED 6mm SHOWER ENCLOSURE COLLECTION





 FIND  
YOUR  
ILI

ILI<sup>®</sup>

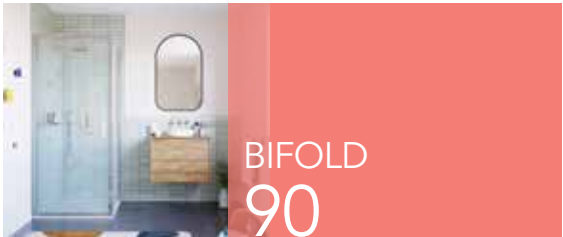

BIFOLD  
90



SLIDING  
QUADRANT  
& OFFSET  
QUADRANT  
96

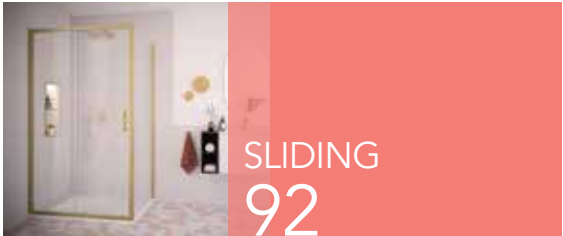

SLIDING  
92



HINGED  
QUADRANT  
& OFFSET  
QUADRANT  
98

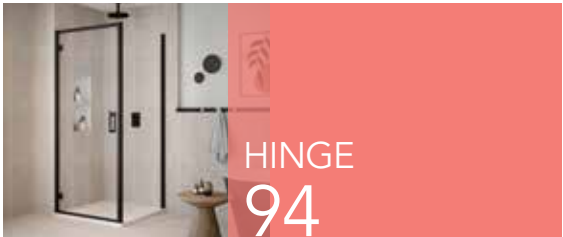

HINGE  
94



BABY ILI  
COLLECTION  
101

# DOORS

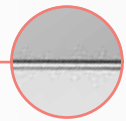

SILVER\*



MATTE BLACK

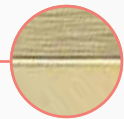

BRUSHED BRASS

## FINISHES

S - Silver\*  
B - Matte Black  
BRB - Brushed Brass

\*BABY ILI available in Silver only, see page 100.

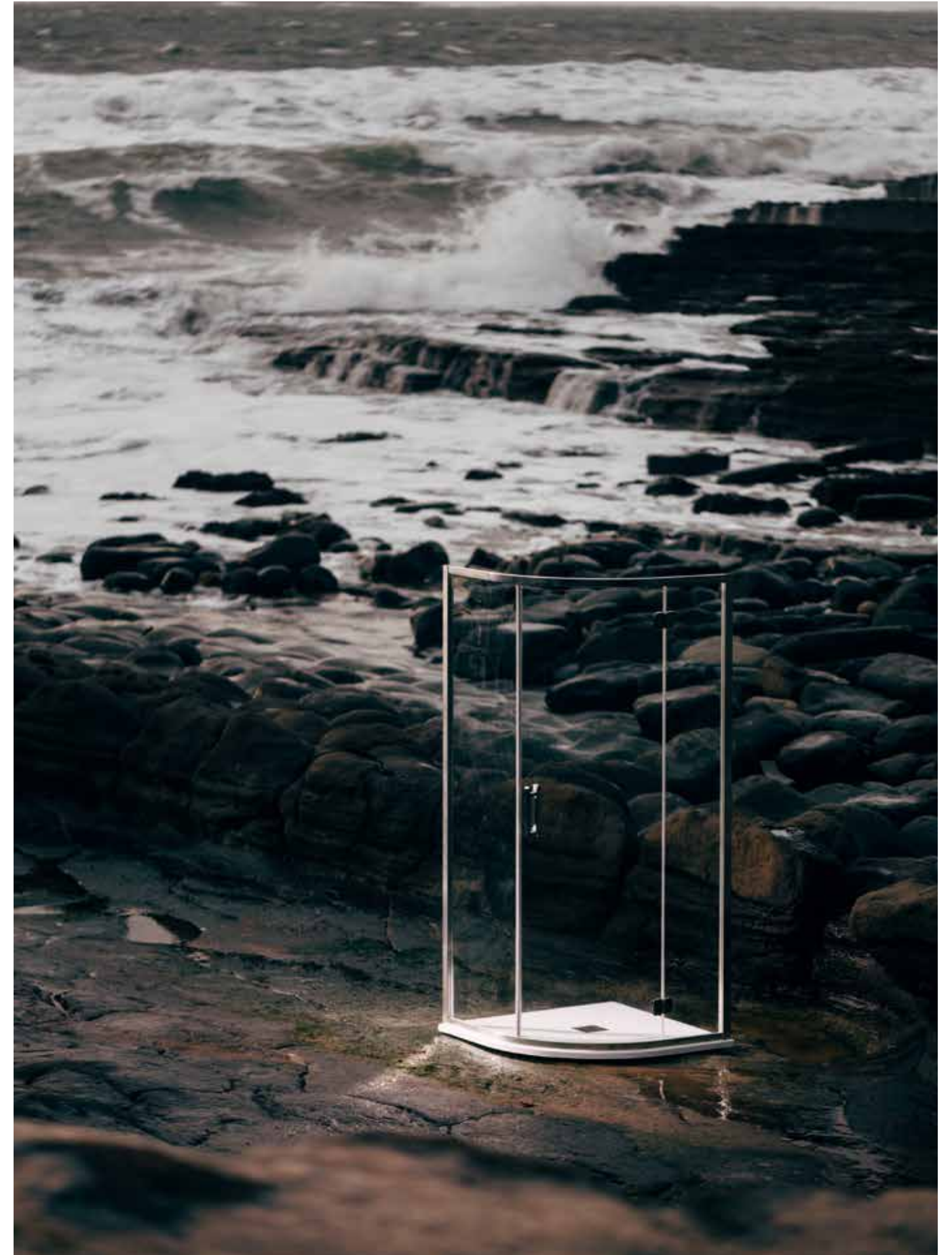

ILI hinged quadrant door in Silver with Gemstone White tray.





# FUNCTIONAL DETAILS

6mm  
TOUGHENED  
SAFETY GLASS

1950mm  
HEIGHT

25mm  
PROFILE  
ADJUSTMENT

ULTRA CLEAR  
SEALS

SEAMLESS  
INTERIOR  
COVER STRIPS

ULTRA SLIM  
COVER CAPS

CRAFTED  
HANDLE DESIGN

CLEARVUE  
HYDROPHOBIC  
GLASS COATING

PRESS FIT  
SEAL DESIGN

PRE-ASSEMBLED  
PROFILE FRAME

SUITABLE FOR  
SIDE PANEL  
INSTALLATION

MAGNETIC  
BIFOLD HINGE

SILENT WHEEL  
ROLLER  
MECHANISM

QUICK RELEASE  
DOUBLE WHEEL  
ROLLERS

REVERSIBLE

SHOWER TRAY  
OR WETROOM  
APPLICATION

LIFETIME  
GUARANTEE

# VISIONARY INNOVATIONS



DOUBLE WHEEL ROLLERS GLIDE ALONG AN INNOVATIVE SILENT WHEEL TRACK SYSTEM



CONCEALED DOOR STOP MECHANISM



UNIQUELY CRAFTED HANDLE WITH INTEGRATED ROBE HOOK



SOFTLY CURVED EXTERIOR HINGE DESIGN



SOFTLY CURVED INTERIOR HINGE DESIGN



EXPLORE  
ILI

# BIFOLD DOOR

FINISHES:

- SILVER
- MATTE BLACK
- BRUSHED BRASS

The space-saving ILI Bifold door is ideal for smaller bathrooms, featuring an inward-opening design, seamless magnetic hinge functionality, and a lifetime guarantee for peace of mind.



BIFOLD - DOOR  
OPEN POSITION  
MEASUREMENTS

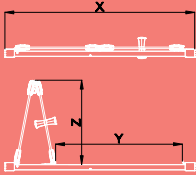

BIFOLD DOOR (mm)	X SIZE (mm)	Y SIZE (mm)	Z SIZE (mm)
700	650-700	472	313
760	710-760	472	313
800	750-800	512	333
850	800-850	521	354
900	850-900	571	379
100m	950-1000	671	431

DOOR SIZE OPTIONS

SIZE (mm)	ADJUSTMENT SIZE MIN (mm) MAX (mm)		ACCESS (mm)	CODE SILVER	CODE MATTE BLACK	CODE BRUSHED BRASS
700	650	700	472	ILIBF70SC	ILIBF70BC	—
760	710	760	472	ILIBF76SC	ILIBF76BC	—
800	750	800	512	ILIBF80SC	ILIBF80BC	ILIBF80BRBC
850	800	850	521	ILIBF85SC	—	—
900	850	900	571	ILIBF90SC	ILIBF90BC	ILIBF90BRBC
1000	950	1000	671	ILIBF100SC	ILIBF100BC	ILIBF100BRBC

SEMI FRAMED SIDE PANEL OPTIONS *(Includes Corner Profile)*

SIZE (mm)	ADJUSTMENT SIZE MIN (mm) MAX (mm)		CODE SILVER	CODE MATTE BLACK	CODE BRUSHED BRASS
700	665	690	ILISP70SC	ILISP70BC	ILISP70BRBC
760	725	750	ILISP76SC	ILISP76BC	—
800	765	790	ILISP80SC	ILISP80BC	ILISP80BRBC
900	865	890	ILISP90SC	ILISP90BC	ILISP90BRBC
1000	965	990	ILISP100SC	ILISP100BC	—

ACCESSORIES

DESCRIPTION	CODE SILVER	CODE MATTE BLACK	CODE BRUSHED BRASS
25mm Compensating Wall Profile	ILICB25SC	ILICB25BC	ILICB25BRBC



BIFOLD DOOR WITH SEMI FRAMED  
SIDE PANEL - BRUSHED BRASS



# SLIDING DOOR

FINISHES:

- SILVER
- MATTE BLACK
- BRUSHED BRASS

The ILI Sliding Door combines a silent wheel track system for smooth operation with ultra-slim profiles and 6mm toughened glass, offering a sleek design in eight size options.



DOOR SIZE OPTIONS

SIZE (mm)	ADJUSTMENT SIZE MIN (mm) MAX (mm)		ACCESS (mm)	CODE SILVER	CODE MATTE BLACK	CODE BRUSHED BRASS
1000	950	1000	370	ILISA100SC	ILISA100BC	ILISA100BRBC
1100	1050	1100	420	ILISA110SC	ILISA110BC	ILISA110BRBC
1200	1150	1200	470	ILISA120SC	ILISA120BC	ILISA120BRBC
1300	1250	1300	520	ILISA130SC	—	—
1400	1350	1400	570	ILISA140SC	ILISA140BC	ILISA140BRBC
1500	1450	1500	570	ILISA150SC	ILISA150BC	ILISA150BRBC
1600	1550	1600	570	ILISA160SC	ILISA160BC	—
1700	1650	1700	570	ILISA170SC	ILISA170BC	ILISA170BRBC

SEMI FRAMED SIDE PANEL OPTIONS *(Includes Corner Profile)*

SIZE (mm)	ADJUSTMENT SIZE MIN (mm) MAX (mm)		CODE SILVER	CODE MATTE BLACK	CODE BRUSHED BRASS
700	665	690	ILISP70SC	ILISP70BC	ILISP70BRBC
760	725	750	ILISP76SC	ILISP76BC	—
800	765	790	ILISP80SC	ILISP80BC	ILISP80BRBC
900	865	890	ILISP90SC	ILISP90BC	ILISP90BRBC
1000	965	990	ILISP100SC	ILISP100BC	—

FRAMELESS SIDE PANELS *(Suitable only for Sliding Door)*

SIZE (mm)	ADJUSTMENT SIZE MIN (mm) MAX (mm)		CODE SILVER	CODE MATTE BLACK
700	665	690	ILIFSP70SC	ILIFSP70BC
760	725	750	ILIFSP76SC	ILIFSP76BC
800	765	790	ILIFSP80SC	ILIFSP80BC
900	865	890	ILIFSP90SC	ILIFSP90BC
1000	965	990	ILIFSP100SC	ILIFSP100BC

ACCESSORIES

DESCRIPTION	CODE SILVER	CODE MATTE BLACK	CODE BRUSHED BRASS
25mm Compensating Wall Profile	ILICB25SC	ILICB25BC	ILICB25BRBC



SLIDING DOOR WITH  
FRAMELESS SIDE PANEL - SILVER

SLIDING DOOR

ILI

6mm GLASS

# HINGE DOOR

FINISHES:

- SILVER
- MATTE BLACK

The ILI Hinge Door is perfect for compact spaces, featuring an outward-opening design, firm magnetic closure, ultra-clear bottom seal for water retention, and concealed hinges for a sleek finish inside and out.



DOOR SIZE OPTIONS

SIZE	ADJUSTMENT SIZE		ACCESS	CODE	CODE
760	710	760	600	ILIHD76SC	ILIHD76BC
800	750	800	640	ILIHD80SC	ILIHD80BC
850	800	850	690	ILIHD85SC	ILIHD85BC
900	850	900	740	ILIHD90SC	ILIHD90BC
1000	950	1000	840	ILIHD100SC	—

SEMI FRAMED SIDE PANEL OPTIONS *(Includes Corner Profile)*

SIZE (mm)	ADJUSTMENT SIZE		CODE	CODE
	MIN (mm)	MAX (mm)	SILVER	MATTE BLACK
700	665	690	ILISP70SC	ILISP70BC
760	725	750	ILISP76SC	ILISP76BC
800	765	790	ILISP80SC	ILISP80BC
900	865	890	ILISP90SC	ILISP90BC
1000	965	990	ILISP100SC	ILISP100BC

ACCESSORIES

DESCRIPTION	CODE	CODE
	SILVER	MATTE BLACK
25mm Compensating Wall Profile	ILICB25SC	ILICB25BC





# ONE DOOR SLIDING QUADRANT & OFFSET QUADRANT

FINISHES:

- SILVER
- MATTE BLACK
- BRUSHED BRASS

The ILI One Door Quadrant and Offset Quadrant maximises corner shower space with a smooth silent wheel mechanism, quick-release stainless steel rollers for easy cleaning, and ClearVue-coated glass to resist grime and limescale.



ONE DOOR SLIDING QUADRANT - SILVER



ONE DOOR OFFSET  
SLIDING QUADRANT - MATTE BLACK

## DOOR SIZE OPTIONS

SIZE (mm)	ADJUSTMENT SIZE MIN (mm) MAX (mm)	ACCESS (mm)	CODE SILVER	CODE MATTE BLACK	CODE BRUSHED BRASS
900	870-895 870-895	485	ILICOQ90SC	ILICOQ90BC	ILICOQ90BRBC
800 x 1000	770-795 970-995	436	ILICOQ80X100SC	ILICOQ80X100BC	—
800 x 1200	770-795 1170-1195	436	ILICOQ80X120SC	ILICOQ80X120BC	ILICOQ80X120BRBC
900 x 1200	870-895 1170-1195	485	ILICOQ90X120SC	ILICOQ90X120BC	ILICOQ90X120BRBC



ONE DOOR SLIDING QUADRANT - BRUSHED BRASS

# HINGED QUADRANT & HINGED OFFSET QUADRANT

FINISHES:

- SILVER
- MATTE BLACK
- BRUSHED BRASS

The Hinged Quadrant and Hinged Offset Quadrant offer a unique corner shower solution, featuring vertical magnetic seals for a secure close, concealed fixings for a sleek interior, and ClearVue-coated 6mm glass for easy cleaning.



## DOOR SIZE OPTIONS

SIZE (mm)	ADJUSTMENT SIZE MIN (mm) MAX (mm)	ACCESS (mm)	CODE SILVER	CODE MATTE BLACK	CODE BRUSHED BRASS
900	870-895 870-895	585	ILIHQ90SC	ILIHQ90BC	ILIHQ90BRBC
800 x 1200	770-795 1170-1195	585	ILIHQ80X120SC	ILIHQ80X120BC	ILIHQ80X120BRBC
900 x 1200	870-895 1170-1195	585	ILIHQ90X120SC	ILIHQ90X120BC	ILIHQ90X120BRBC



HINGED QUADRANT AND HINGED OFFSET QUADRANT

ILI

6mm GLASS





## PATENTED CLICK FIT ASSEMBLY SYSTEM

This screw free assembly mechanism revolutionises the way ILI shower doors are fitted, reducing assembly time dramatically for installers.



EXPLORE  
ILI

## THE BABY ILI<sup>®</sup> COLLECTION

Born out of the ingenuity of the ILI collection, BABY ILI is a reduced height offering that is the perfect fit where ceiling height is restricted.

At 1800mm high, Baby ILI fits seamlessly under low ceilings. An ideal solution for attic or loft style bathrooms.

## FRAMED 6mm, 1800mm HIGH SHOWER ENCLOSURE COLLECTION



FIND  
YOUR  
BABY ILI

KEY FEATURES



FINISHES



BABY ILI SLIDING DOOR  
in alcove – Silver



# BABY ILI

1800MM HEIGHT ON ALL BABY ILI SHOWER DOORS

FINISHES:

SILVER

## HINGE DOOR – SIZE OPTIONS

SIZE (mm)	ADJUSTMENT SIZE MIN (mm)    MAX (mm)		ACCESS (mm)	CODE SILVER
700	650	700	640	ILI180HD70SC
760	710	760	640	ILI180HD76SC
800	750	800	640	ILI180HD80SC
900	850	900	740	ILI180HD90SC

## SLIDING DOOR – SIZE OPTIONS

SIZE (mm)	ADJUSTMENT SIZE MIN (mm)    MAX (mm)		ACCESS (mm)	CODE SILVER
1000	950	1000	470	ILI180SA100SC
1200	1150	1200	470	ILI180SA120SC
1400	1350	1400	470	ILI180SA140SC

## SEMI FRAMED SIDE PANEL (INCLUDES CORNER PROFILE) – SIZE OPTIONS

SIZE (mm)	ADJUSTMENT SIZE MIN (mm)    MAX (mm)		CODE SILVER
700	665	690	ILI180SP70SC
800	765	790	ILI180SP80SC
900	865	890	ILI180SP90SC
1000	965	990	ILI180SP100SC



HINGE DOOR WITH  
SEMI FRAMED SIDE PANEL



SLIDING DOOR WITH  
SEMI FRAMED SIDE PANEL

# BABY ILI

1800MM HEIGHT ON ALL BABY ILI SHOWER DOORS

FINISHES:

SILVER

## BIFOLD DOOR – SIZE OPTIONS

SIZE (mm)	ADJUSTMENT SIZE MIN (mm)	ADJUSTMENT SIZE MAX (mm)	ACCESS (mm)	CODE SILVER
700	650	700	472	ILI180BF70SC
800	750	800	512	ILI180BF80SC
900	850	900	571	ILI180BF90SC
1000	950	1000	671	ILI180BF100SC

## SEMI FRAMED SIDE PANEL (INCLUDES CORNER PROFILE) – SIZE OPTIONS

SIZE (mm)	ADJUSTMENT SIZE MIN (mm)	ADJUSTMENT SIZE MAX (mm)	CODE SILVER
700	665	690	ILI180SP70SC
800	765	790	ILI180SP80SC
900	865	890	ILI180SP90SC
1000	965	990	ILI180SP100SC

## ONE DOOR SLIDING QUADRANT – SIZE OPTIONS

SIZE (mm)	ADJUSTMENT SIZE MIN (mm)	ADJUSTMENT SIZE MAX (mm)	ACCESS (mm)	CODE SILVER
800	770	795	436	ILI180COQ80SC
900	870	895	485	ILI180COQ90SC

BIFOLD - DOOR OPEN POSITION MEASUREMENTS

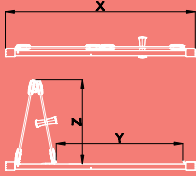

BIFOLD DOOR (mm)	X SIZE (mm)	Y SIZE (mm)	Z SIZE (mm)
700	650-700	412	283
800	750-800	512	333
900	850-900	571	379
100m	950-1000	671	431



CRAFTED ILI HANDLE WITH INTEGRATED ROBE HOOK FEATURE







## DESIGN AWARD

Flair are proud to have received the **Good Design** Award accolade in recognition of the AYO wetroom collection.

The **Good Design** Award is a seal of global design excellence and a testimony to our passion for product quality and innovation.

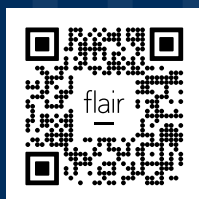

EXPLORE  
AYO

# THE AYO<sup>®</sup> COLLECTION

The AYO modular wetroom collection is crafted to create a truly personal shower experience.

Standing tall at a height of 2 metres, AYO comes in 8mm and 10mm glass which is treated with a hydrophobic coating that resists the build up of grime and lime scale.

With an abundance of configurations and fixture innovations such as recessed channels, fixed and rotating panels, ultra-clear seals and stylish stabilising bar options, makes this a truly versatile modular wetroom system. AYO boasts 3 glass options - clear, fluted and opaque.

Now available in 9 high quality colour finishes, AYO will pair perfectly with other signature elements in any bathroom.

## MODULAR WETROOM COLLECTION 8mm & 10mm

ENHANCE  
YOUR  
SHOWERING  
EXPERIENCE  
EVERYDAY.



FIND  
YOUR  
AYO

AYO®



CHOOSE  
YOUR AYO  
YOUR WAY  
116



10MM WETROOM  
COLLECTION  
134



8MM CLEAR,  
FLUTED &  
OPAQUE GLASS  
COLLECTION  
118



MODULAR  
142



8MM FRAMED  
BLACK  
COLLECTION  
128



8MM  
BATHSCREENS  
158

# WETROOMS



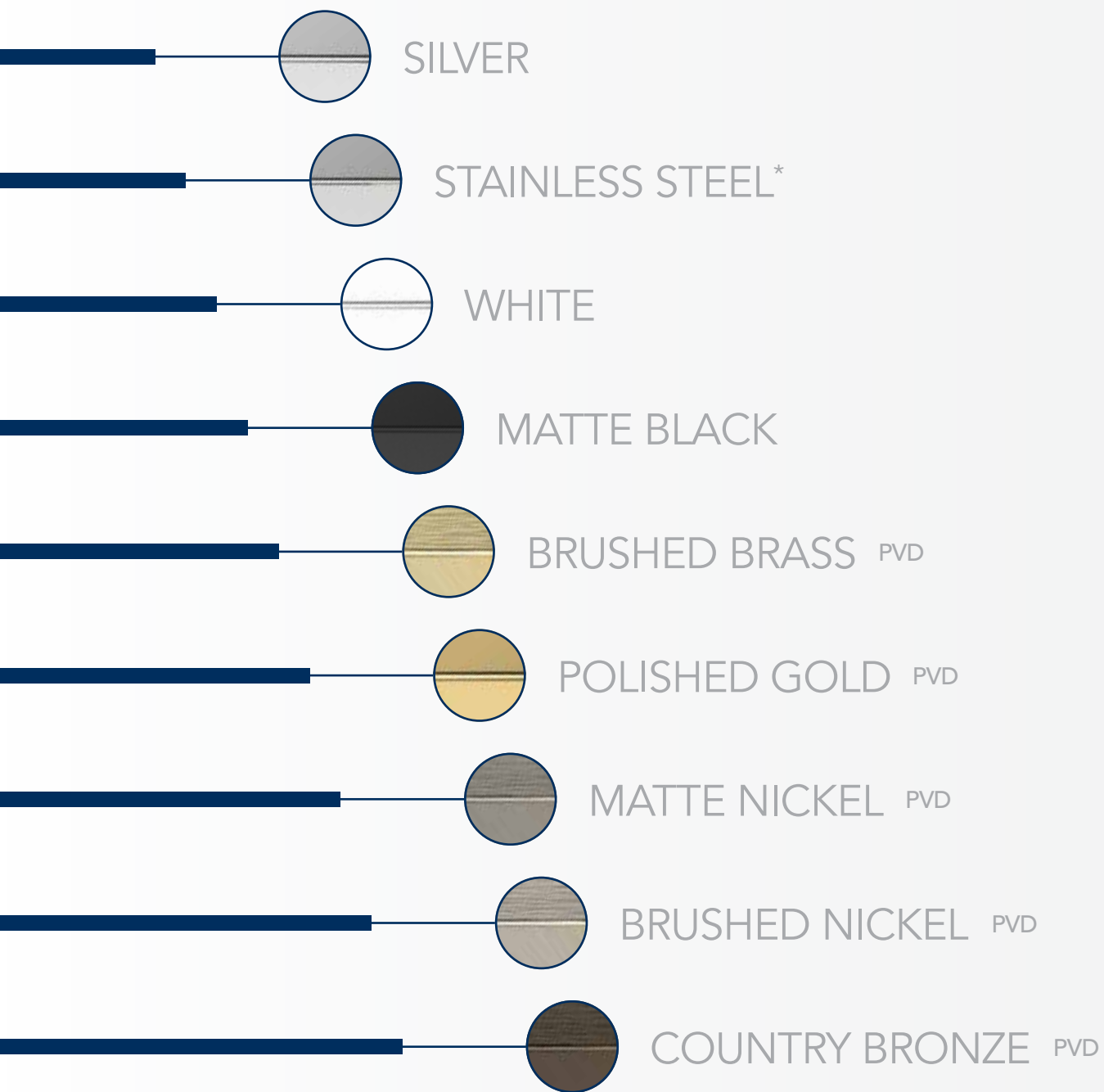

## FINISHES

S - Silver  
SS - Stainless Steel  
W - White  
B - Matte Black  
BRB - Brushed Brass

PG - Polished Gold  
BRMN - Matte Nickel  
BRN - Brushed Nickel  
CTRY BRZ - Country Bronze

## PVD

The PVD coating is applied to high grade 304 stainless steel base material. The result is a superbly robust and hard wearing finish.

\* Polished Stainless Steel is high grade 304 stainless steel.



AYO 8mm fluted wetroom panel with straight stabilising bar in Matte Nickel.





EXPLORE  
AYO

AYO 8mm Linear Framed wetroom panel with straight stabilising bar in Matte Black.

# PERSONALISE YOUR SHOWERING SPACE

Choose your finish.  
Choose your glass.  
**Make it yours.**



## EXPLORE YOUR OPTIONS

AYO SILVER & MATTE BLACK - 8mm or 10mm

AYO COLOUR - 8mm or 10mm

AYO FLUTED - 8mm

AYO FRAMED - 8mm (Clear & Fluted Glass)



## FUNCTIONAL DETAILS

8mm OR 10mm TOUGHENED SAFETY GLASS	2000mm HEIGHT	ULTRA CLEAR SEALS	RANGE OF STABILISING SOLUTIONS	CLEARVUE HYDROPHOBIC GLASS COATING	ALUMINIUM FLOOR PROTECTOR STRIP AVAILABLE	ULTRA CLEAR BOTTOM FLOOR PROTECTOR STRIP INCLUDED
		CONCEALED FIXINGS	ECO FRIENDLY PVD TECHNOLOGY	SHOWER TRAY OR WETROOM APPLICATION	REVERSIBLE	20 YEAR GUARANTEE



# CHOOSE YOUR AYO® YOUR WAY

## FIND YOUR PERFECT AYO WETROOM

### AYO WETROOMS

(FROM PAGE 118 (8mm) OR PAGE 136 (10mm))

Discover our three most popular wetroom configurations - designed to make choosing and ordering quick and easy.

### AYO MODULAR

(FROM PAGE 142)

A step-by-step process that will help bring your dream shower space to life and is tailored to create a unique shower enclosure design that suits your style. Choose from a variety of materials, colours and finishes to create the perfect ambience.



### AYO SINGLE WETROOM PANEL

A classic and simple option.  
Ideal for minimalist, modern wetrooms.

8 OR 10mm  
TOUGHENED  
SAFETY GLASS

FOR A  
CORNER  
SPACE

FOR AN  
ALCOVE  
SPACE



### AYO WETROOM PANEL WITH ROTATING PANEL

Looking for extra splash protection?  
A stylish solution that maintains an open,  
flexible showering space.

Start by picking your front panel size on page 120  
(for 8mm glass) or page 136 (for 10mm glass),  
then select your rotating panel.

Note - All rotating panels  
can be retro fitted.

8 OR 10mm  
TOUGHENED  
SAFETY GLASS

FOR A  
CORNER  
SPACE



### AYO CORNER WETROOM

Creating a corner shower?  
Designed to maximise space and minimise splash.

Pick two panels in your required sizes.  
For an optional rotating panel, see page 122  
(for 8mm glass) or page 138 (for 10mm glass).

Pick three panels in your required size  
for a straight space.

8 OR 10mm  
TOUGHENED  
SAFETY GLASS

FOR A  
CORNER  
SPACE

FOR A  
STRAIGHT  
SPACE

CHOOSE FROM  
9 PREMIUM  
FINISHES



# AYO® 8MM CLEAR, FLUTED & OPAQUE GLASS COLLECTION

Designed for style-conscious spaces, AYO offers wetroom panel configurations in clear, fluted, and opaque glass.

Each setup includes a premium glass panel, a 15mm wall profile, and a stabilising bar, making it easy to achieve a sleek, minimalist shower space that blends functionality with contemporary design.



**8mm**  
TOUGHENED  
SAFETY GLASS

**FOR A  
CORNER  
SPACE**

**FOR AN  
ALCOVE  
SPACE**



FLUTED GLASS - BRUSHED BRASS



AYO®  
WETROOM  
8MM CLEAR GLASS

FINISHES:

- SILVER
- MATTE BLACK
- BRUSHED BRASS
- MATTE NICKEL
- BRUSHED NICKEL
- COUNTRY BRONZE
- WHITE

Includes an 8mm clear glass panel, a 15mm wall profile and a suitable stabilising bar solution.

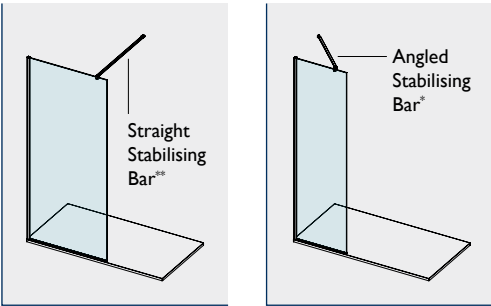

AYO – 8MM WETROOM			
SIZE (mm)	CODE SILVER	CODE MATTE BLACK	CODE BRUSHED BRASS
300	AYO8MWR30SC	AYO8MWR30BC	–
400	AYO8MWR40SC	AYO8MWR40BC	–
450	AYO8MWR45SC	AYO8MWR45BC	AYO8MWR45-CBRB
500	AYO8MWR50SC	AYO8MWR50BC	AYO8MWR50-CBRB
600	AYO8MWR60SC	AYO8MWR60BC	AYO8MWR60-CBRB
700	AYO8MWR70SC	AYO8MWR70BC	AYO8MWR70-CBRB
760	AYO8MWR76SC	AYO8MWR76BC	AYO8MWR76-CBRB
800	AYO8MWR80SC	AYO8MWR80BC	AYO8MWR80-CBRB
900	AYO8MWR90SC	AYO8MWR90BC	AYO8MWR90-CBRB
1000	AYO8MWR100SC	AYO8MWR100BC	AYO8MWR100-CBRB
1100	AYO8MWR110SC	AYO8MWR110BC	AYO8MWR110-CBRB
1200	AYO8MWR120SC	AYO8MWR120BC	AYO8MWR120-CBRB
1400	AYO8MWR140SC	AYO8MWR140BC	AYO8MWR140-CBRB
1500	AYO8MWR150SC	AYO8MWR150BC	AYO8MWR150-CBRB
1600	AYO8MWR160SC	AYO8MWR160BC	AYO8MWR160-CBRB

\*\*1200mm Straight Stabilising Bar included with wetrooms 700mm and over.  
\*350mm Angled Stabilising Bar included with 300 & 400mm wetrooms.  
\*650mm Angled Stabilising Bar included with 450, 500 & 600mm wetrooms.

AYO – 8MM WETROOM			
SIZE (mm)	CODE MATTE NICKEL	CODE BRUSHED NICKEL	CODE COUNTRY BRONZE
450	–	AYO8MWR45-CBRN	AYO8MWR45-CCTRYBRZ
500	–	AYO8MWR50-CBRN	AYO8MWR50-CCTRYBRZ
600	–	AYO8MWR60-CBRN	AYO8MWR60-CCTRYBRZ
700	AYO8MWR70-CBRMN	AYO8MWR70-CBRN	AYO8MWR70-CCTRYBRZ
760	–	–	AYO8MWR76-CCTRYBRZ
800	AYO8MWR80-CBRMN	AYO8MWR80-CBRN	AYO8MWR80-CCTRYBRZ
900	AYO8MWR90-CBRMN	AYO8MWR90-CBRN	AYO8MWR90-CCTRYBRZ
1000	AYO8MWR100-CBRMN	AYO8MWR100-CBRN	AYO8MWR100-CCTRYBRZ
1100	AYO8MWR110-CBRMN	AYO8MWR110-CBRN	AYO8MWR110-CCTRYBRZ
1200	AYO8MWR120-CBRMN	AYO8MWR120-CBRN	AYO8MWR120-CCTRYBRZ
1400	AYO8MWR140-CBRMN	AYO8MWR140-CBRN	AYO8MWR140-CCTRYBRZ
1500	–	AYO8MWR150-CBRN	AYO8MWR150-CCTRYBRZ
1600	–	–	AYO8MWR160-CCTRYBRZ

SIZE (mm)	CODE WHITE
700	AYO8MWR70WC
800	AYO8MWR80WC
900	AYO8MWR90WC
1000	AYO8MWR100WC
1100	AYO8MWR110WC
1200	AYO8MWR120WC
1400	AYO8MWR140WC



# AYO<sup>®</sup>

## ROTATING PANEL

### 8MM CLEAR GLASS

FINISHES:

- SILVER
- MATTE BLACK
- BRUSHED BRASS
- MATTE NICKEL
- BRUSHED NICKEL
- COUNTRY BRONZE
- WHITE

Rotating panels help reduce water spray while keeping your space open.

**Rotating Panel:** Swings in and out for flexible access.

**Hinge Rotating Panel:** Opens in one direction, ideal for more defined spaces.

Note: Please order your front wetroom panel in the required size from page 120.

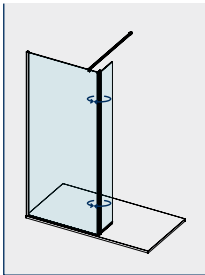

HINGE ROTATING PANEL

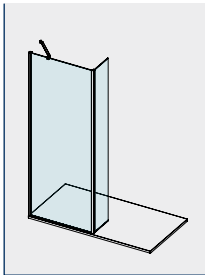

RISE & FALL ROTATING PANEL

AYO – 8MM ROTATING PANELS - RISE & FALL HINGE MECHANISM*			
SIZE (mm)	CODE SILVER	CODE MATTE BLACK	CODE WHITE
300	AYO8RP30SC	AYO8RP30BC	AYO8RP30WC
450	AYO8RP45SC	AYO8RP45BC	AYO8RP45WC
500	AYO8RP50SC	AYO8RP50BC	—

\*Rotating Panels can be retrofitted.



ROTATING PANEL - MATTE BLACK



HINGE ROTATING PANEL - BRUSHED BRASS (PVD)



AYO – 8MM HINGE ROTATING PANELS			
SIZE (mm)	CODE SILVER	CODE MATTE BLACK	CODE BRUSHED BRASS
300	AYO8HRP30SSC	AYO8HRP30BC	AYO8HRP30CBRBC
450	AYO8HRP45SSC	AYO8HRP45BC	AYO8HRP45CBRBC
500	AYO8HRP50SSC	AYO8HRP50BC	AYO8HRP50CBRBC

SIZE (mm)	CODE MATTE NICKEL	CODE BRUSHED NICKEL	CODE COUNTRY BRONZE
300	AYO8HRP30CPGC	AYO8HRP30CBRMNC	AYO8HRP30CCTRYBRZC
450	AYO8HRP45CPGC	AYO8HRP45CBRMNC	AYO8HRP45CCTRYBRZC
500	AYO8HRP50CPGC	AYO8HRP50CBRMNC	AYO8HRP50CCTRYBRZC

AYO – 8MM PLATED FINISH - HANDED HINGE ROTATING PANELS		
SIZE (mm)	CODE SILVER	CODE MATTE BLACK
300 – Right Hand	AYO8HRPR30SC	AYO8HRPR30BC
450 – Right Hand	AYO8HRPR45SC	AYO8HRPR45BC
500 – Right Hand	AYO8HRPR50SC	AYO8HRPR50BC
300 – Left Hand	AYO8HRPL30SC	AYO8HRPL30BC
450 – Left Hand	AYO8HRPL45SC	AYO8HRPL45BC
500 – Left Hand	AYO8HRPL50SC	AYO8HRPL50BC

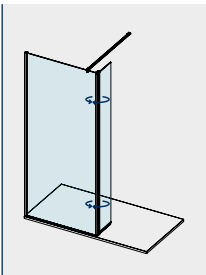

LEFT HAND HINGE

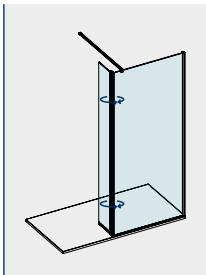

RIGHT HAND HINGE



AYO®

# CORNER WETROOM

## 8MM CLEAR GLASS

FINISHES:

SILVER

MATTE BLACK

BRUSHED BRASS

MATTE NICKEL

BRUSHED NICKEL

COUNTRY BRONZE

WHITE

Start by choosing your front wetroom panel from page 120, then select your side panel size from the options below. You must also order a T-Piece to complete the corner installation.

Create a spacious, stylish corner wetroom with a sleek two-panel layout supported by stainless steel stabilising bars. Add a matching T-piece for enhanced stability and a seamless, modern finish.

Note: Order your front panel in the size you need from page 120.

This page 124, shows some of our most popular sizes for corner configurations, but any size can be used to create your ideal layout.

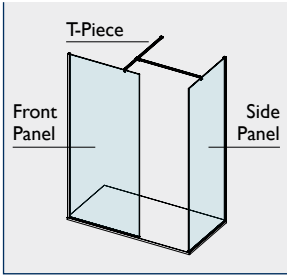

AYO – 8MM CORNER WETROOMS

SIZE (mm)	CODE SILVER	CODE MATTE BLACK	CODE BRUSHED BRASS
700	AYO8MWR70SC	AYO8MWR70BC	AYO8MWR70-CBRB
760	AYO8MWR76SC	AYO8MWR76BC	AYO8MWR76-CBRB
800	AYO8MWR80SC	AYO8MWR80BC	AYO8MWR80-CBRB
900	AYO8MWR90SC	AYO8MWR90BC	AYO8MWR90-CBRB

SIZE (mm)	CODE MATTE NICKEL	CODE BRUSHED NICKEL	CODE COUNTRY BRONZE
700	AYO8MWR70-CBRMN	AYO8MWR70-CBRN	AYO8MWR70-CCTRYBRZ
760	—	—	AYO8MWR76-CCTRYBRZ
800	AYO8MWR80-CBRMN	AYO8MWR80-CBRN	AYO8MWR80-CCTRYBRZ
900	AYO8MWR90-CBRMN	AYO8MWR90-CBRN	AYO8MWR90-CCTRYBRZ

SIZE (mm)	CODE WHITE
700	AYO8MWR70WC
800	AYO8MWR80WC
900	AYO8MWR90WC

1200mm Straight Stabilising Bar included with wetrooms 700mm and over.

Choose your optional rotating panel from page 122.



CORNER WETROOM WITH T-PIECE - MATTE BLACK



AYO – T-PIECES

SIZE (mm)	CODE SILVER	CODE MATTE BLACK	CODE BRUSHED BRASS
T-Piece	AYOTPS	AYOTPB	AYOTP-CBRB

SIZE (mm)	CODE MATTE NICKEL	CODE BRUSHED NICKEL	CODE COUNTRY BRONZE
T-Piece	AYOTP-CBRMN	AYOTP-CBRN	AYOTP-CCTRYBRZ

SIZE (mm)	CODE WHITE
T-Piece	AYOTPW

# AYO® WETROOM

## 8MM FLUTED GLASS

Note: To create a corner wetroom, order two panels in your required sizes along with a T-piece connector (T-piece codes available on page 125). Add a rotating panel if you would like extra splash protection.

FINISHES:

- SILVER
- MATTE BLACK
- BRUSHED BRASS
- POLISHED GOLD
- MATTE NICKEL
- BRUSHED NICKEL
- COUNTRY BRONZE

Each item below includes an 8mm clear glass panel, a 15mm wall profile and a straight stabilising bar.

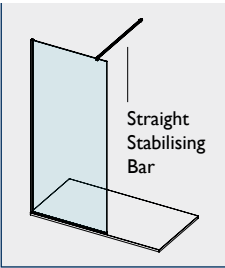

### AYO – 8MM WETROOMS - FLUTED GLASS

SIZE (mm)	CODE SILVER	CODE MATTE BLACK	CODE BRUSHED BRASS
700	AYO8MWR70SFC	AYO8MWR70BFC	AYO8MWR70F-CBRB
800	AYO8MWR80SFC	AYO8MWR80BFC	AYO8MWR80F-CBRB
900	AYO8MWR90SFC	AYO8MWR90BFC	AYO8MWR90F-CBRB
1000	AYO8MWR100SFC	AYO8MWR100BFC	AYO8MWR100F-CBRB
1200	AYO8MWR120SFC	AYO8MWR120BFC	AYO8MWR120F-CBRB
1400	AYO8MWR140SFC	AYO8MWR140BFC	AYO8MWR140F-CBRB

### 8MM HINGE ROTATING PANEL - FLUTED GLASS

300	AYO8HRP30SSFC	AYO8HRP30BFC	AYO8HRP30BBFC
-----	---------------	--------------	---------------

SIZE (mm)	CODE POLISHED GOLD	CODE MATTE NICKEL	CODE BRUSHED NICKEL
700	AYO8MWR70F-CPG	AYO8MWR70F-CBRMIN	AYO8MWR70F-CBRN
800	AYO8MWR80F-CPG	AYO8MWR80F-CBRMIN	AYO8MWR80F-CBRN
900	AYO8MWR90F-CPG	AYO8MWR90F-CBRMIN	AYO8MWR90F-CBRN
1000	AYO8MWR100F-CPG	AYO8MWR100F-CBRMIN	AYO8MWR100F-CBRN
1200	AYO8MWR120F-CPG	AYO8MWR120F-CBRMIN	AYO8MWR120F-CBRN
1400	AYO8MWR140F-CPG	AYO8MWR140F-CBRMIN	AYO8MWR140F-CBRN

### 8MM HINGE ROTATING PANEL - FLUTED GLASS

300	AYO8HRP30PGFC	AYO8HRP30BRMINFC	AYO8HRP30BRNFC
-----	---------------	------------------	----------------

SIZE (mm)	CODE COUNTRY BRONZE
700	AYO8MWR70F-CCTRYBRZ
800	AYO8MWR80F-CCTRYBRZ
900	AYO8MWR90F-CCTRYBRZ
1000	AYO8MWR100F-CCTRYBRZ
1200	AYO8MWR120F-CCTRYBRZ
1400	AYO8MWR140F-CCTRYBRZ

### 8MM HINGE ROTATING PANEL - FLUTED GLASS

300	AYO8HRP30CCTRYBRZFC
-----	---------------------



# AYO® WETROOM

## 8MM OPAQUE GLASS

FINISHES:

- SILVER
- MATTE BLACK

Each item below includes an 8mm clear glass panel, a 15mm wall profile and a straight stabilising bar.

### AYO – 8MM WETROOMS - OPAQUE GLASS

SIZE (mm)	CODE SILVER	CODE MATTE BLACK
800	AYO8MWR80SPC	AYO8MWR80BPC
900	AYO8MWR90SPC	AYO8MWR90BPC
1000	AYO8MWR100SPC	AYO8MWR100BPC
1200	AYO8MWR120SPC	AYO8MWR120BPC
1400	AYO8MWR140SPC	AYO8MWR140BPC





# AYO<sup>®</sup> 8MM FRAMED BLACK COLLECTION

AVAILABLE IN **CLEAR GLASS & FLUTED GLASS**

Bold and beautifully engineered, AYO Framed brings industrial-inspired style to the modern bathroom.

Each 2-metre high panel features 8mm toughened glass with a flush, easy-clean interior; a protective hydrophobic coating, and a striking black metal frame bonded to the exterior for stand-out design and lasting durability.

**8mm**  
TOUGHENED  
SAFETY GLASS

  
FOR A  
CORNER  
SPACE

  
FOR AN  
ALCOVE  
SPACE



FRAMED WETROOM IN FLUTED GLASS

FRAMED BLACK WETROOMS

AYO

8mm CLEAR & FLUTED GLASS

AYO®

# FRAMED WETROOM

## 8MM CLEAR GLASS

FINISH:

MATTE BLACK

Comes complete with 8mm Framed Wetroom Panel (clear glass) with 15mm Wall profile and 1200mm Straight Stabilising Bar.



8MM FRAMED WETROOM



8MM FRAMED CORNER WALK-IN WETROOM WITH T-PIECE



8MM FRAMED WETROOM WITH ROTATING PANEL

AYO – 8MM FRAMED WETROOM	
SIZE (mm)	CODE MATTE BLACK
700	AYO8MWRFB70BC
760	AYO8MWRFB76BC
800	AYO8MWRFB80BC
900	AYO8MWRFB90BC
1000	AYO8MWRFB100BC
1100	AYO8MWRFB110BC
1200	AYO8MWRFB120BC
1400	AYO8MWRFB140BC

AYO – 8MM FRAMED CORNER WALK-IN*	
SIZE (mm)	CODE MATTE BLACK
700	AYO8MWRFB70TBC
760	AYO8MWRFB76TBC
800	AYO8MWRFB80TBC
900	AYO8MWRFB90TBC
1000	AYO8MWRFB100TBC

AYO – FRAMED ROTATING PANEL	
SIZE (mm)	CODE MATTE BLACK
300	AYO8RPFB30BC
450	AYO8RPFB45BC

ACCESSORIES	
SIZE (mm)	CODE MATTE BLACK
1200mm Straight Stabilising Bar	AYOSSBB
1400mm Straight Stabilising Bar	AYO140SSBB
L Shape Stabilising Bar - Length 1410mm / Height 220mm	AYOLSSBB
Top of Glass to Ceiling Bar - 600mm	AYOCSBB
Two Piece Floor to Ceiling Stabilising Bar	AYOF2CSBB

FINISH:

MATTE BLACK

Comes complete with 8mm Linear Wetroom Panel (clear glass) with 15mm Wall profile and 1200mm Straight Stabilising Bar.



8MM LINEAR WETROOM



8MM LINEAR CORNER WALK-IN WETROOM WITH T-PIECE



8MM LINEAR WETROOM WITH ROTATING PANEL

AYO – 8MM LINEAR WETROOM	
SIZE (mm)	CODE MATTE BLACK
700	AYO8MWRFB70BC
760	AYO8MWRFB76BC
800	AYO8MWRFB80BC
900	AYO8MWRFB90BC
1000	AYO8MWRFB100BC
1100	AYO8MWRFB110BC
1200	AYO8MWRFB120BC
1400	AYO8MWRFB140BC

AYO – 8MM LINEAR CORNER WALK-IN*	
SIZE (mm)	CODE MATTE BLACK
700	AYO8MWRFB70TBC
760	AYO8MWRFB76TBC
800	AYO8MWRFB80TBC
900	AYO8MWRFB90TBC
1000	AYO8MWRFB100TBC

AYO – LINEAR ROTATING PANEL	
SIZE (mm)	CODE MATTE BLACK
300	AYO8RPFHB30BC

ACCESSORIES	
SIZE (mm)	CODE MATTE BLACK
1200mm Straight Stabilising Bar	AYOSSBB
1400mm Straight Stabilising Bar	AYO140SSBB
L Shape Stabilising Bar - Length 1410mm / Height 220mm	AYOLSSBB
Top of Glass to Ceiling Bar - 600mm	AYOCSBB
Two Piece Floor to Ceiling Stabilising Bar	AYOF2CSBB



# AYO®

## FRAMED WETROOM

### 8MM FLUTED GLASS

FINISH:

**MATTE BLACK**

Comes complete with 8mm Framed Wetroom Panel (fluted glass) with 15mm Wall profile and 1200mm Straight Stabilising Bar.

AYO – 8MM FRAMED WETROOM	
SIZE (mm)	CODE MATTE BLACK
700	AYO8MVRFB70TBFC
800	AYO8MVRFB80TBFC
900	AYO8MVRFB90TBFC
1000	AYO8MVRFB100TBFC

ACCESSORIES	
DESCRIPTION	CODE MATTE BLACK
T-Piece	AYOTPB

Note: To create a Corner Walk-In Wetroom, order a second Framed Wetroom in your desired size of Side Panel as above and separate T-Piece.

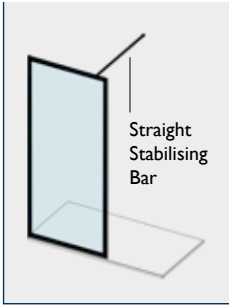

8MM FRAMED WETROOM

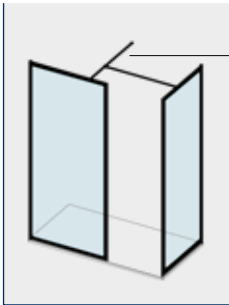

T-Piece  
Stabilising  
Bar

8MM FRAMED WETROOM WITH SIDE PANEL AND T-PIECE



FRAMED WETROOM IN FLUTED GLASS



FRAMED WALK-IN WETROOM IN FLUTED GLASS



# AYO® 10MM WETROOM COLLECTION

Designed for style-conscious spaces, AYO offers complete wetroom panels with 10mm glass.

Includes a glass panel, 15mm wall profile, and a stabilising bar, making it easy to achieve a beautifully minimalist showering solution.

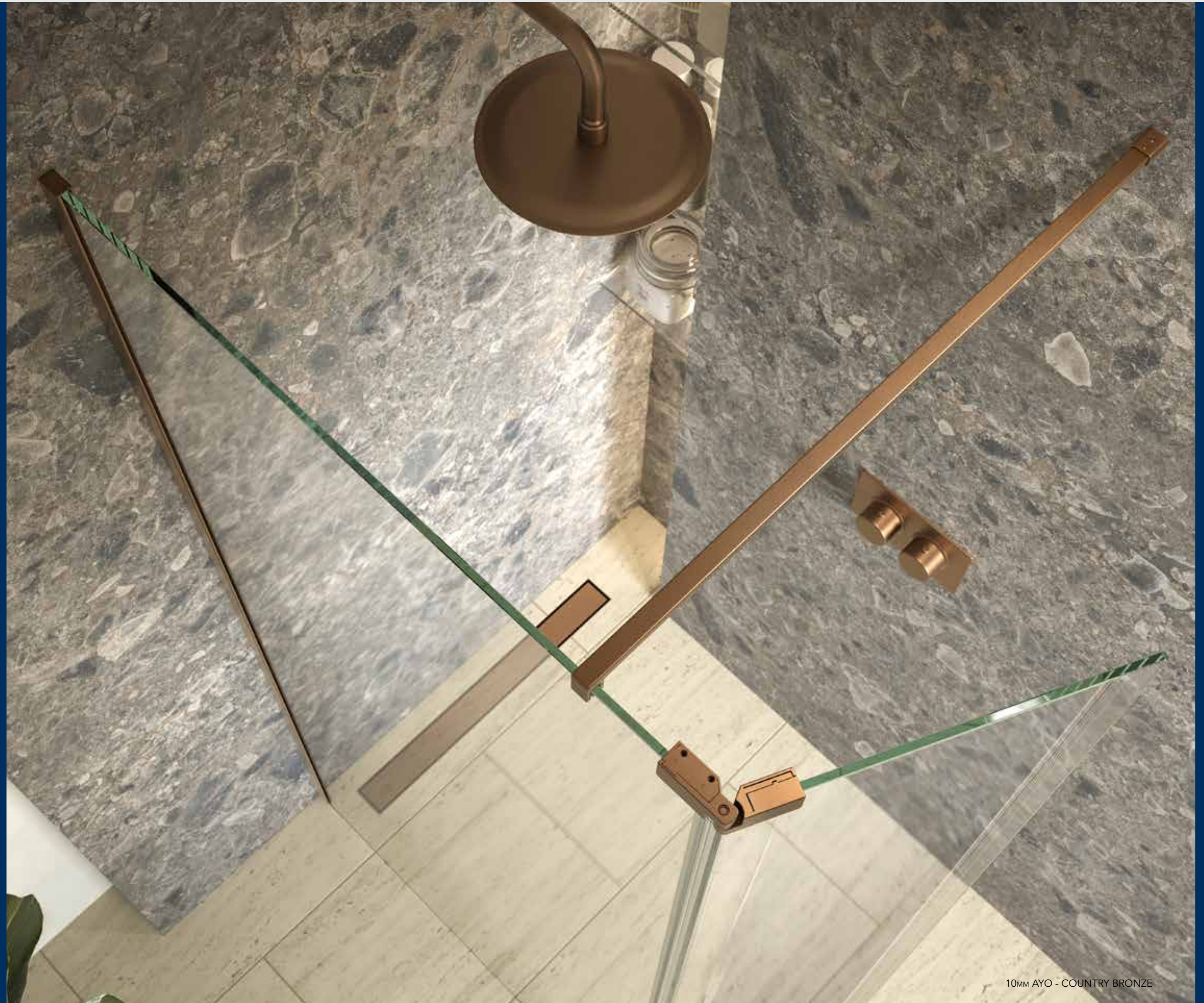

10MM AYO - COUNTRY BRONZE



# AYO®

## WETROOM

### 10MM CLEAR GLASS

FINISHES:

- SILVER
- MATTE BLACK
- BRUSHED BRASS
- POLISHED GOLD
- MATTE NICKEL
- BRUSHED NICKEL
- COUNTRY BRONZE
- STAINLESS STEEL
- WHITE

Includes a 10mm clear glass panel, a 15mm wall profile and a suitable stabilising bar solution.

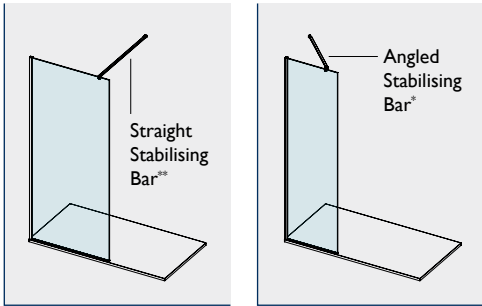

AYO – 10MM WETROOMS			
SIZE (mm)	CODE SILVER	CODE MATTE BLACK	CODE BRUSHED BRASS
300	AYO10MWR30SC	AYO10MWR30BC	—
400	AYO10MWR40SC	AYO10MWR40BC	—
450	AYO10MWR45SC	AYO10MWR45BC	AYO10MWR45-CBRB
500	AYO10MWR50SC	AYO10MWR50BC	AYO10MWR50-CBRB
600	AYO10MWR60SC	AYO10MWR60BC	AYO10MWR60-CBRB
700	AYO10MWR70SC	AYO10MWR70BC	AYO10MWR70-CBRB
760	AYO10MWR76SC	AYO10MWR76BC	AYO10MWR76-CBRB
800	AYO10MWR80SC	AYO10MWR80BC	AYO10MWR80-CBRB
900	AYO10MWR90SC	AYO10MWR90BC	AYO10MWR90-CBRB
1000	AYO10MWR100SC	AYO10MWR100BC	AYO10MWR100-CBRB
1100	AYO10MWR110SC	AYO10MWR110BC	AYO10MWR110-CBRB
1200	AYO10MWR120SC	AYO10MWR120BC	AYO10MWR120-CBRB
1400	AYO10MWR140SC	AYO10MWR140BC	AYO10MWR140-CBRB

\*\*1200mm Straight Stabilising Bar included with wetrooms 700mm and over.  
\*350mm Angled Stabilising Bar included with 300 & 400mm wetrooms.  
\*650mm Angled Stabilising Bar included with 450, 500 & 600mm wetrooms.



AYO – 10MM WETROOMS			
SIZE (mm)	CODE POLISHED GOLD	CODE MATTE NICKEL	CODE BRUSHED NICKEL
450	AYO10MWR45-CPG	AYO10MWR45-CBRMN	AYO10MWR45-CBRN
500	AYO10MWR50-CPG	AYO10MWR50-CBRMN	AYO10MWR50-CBRN
600	AYO10MWR60-CPG	AYO10MWR60-CBRMN	AYO10MWR60-CBRN
700	AYO10MWR70-CPG	AYO10MWR70-CBRMN	AYO10MWR70-CBRN
760	AYO10MWR76-CPG	AYO10MWR76-CBRMN	AYO10MWR76-CBRN
800	AYO10MWR80-CPG	AYO10MWR80-CBRMN	AYO10MWR80-CBRN
900	AYO10MWR90-CPG	AYO10MWR90-CBRMN	AYO10MWR90-CBRN
1000	AYO10MWR100-CPG	AYO10MWR100-CBRMN	AYO10MWR100-CBRN
1100	AYO10MWR110-CPG	AYO10MWR110-CBRMN	AYO10MWR110-CBRN
1200	AYO10MWR120-CPG	AYO10MWR120-CBRMN	AYO10MWR120-CBRN
1400	AYO10MWR140-CPG	AYO10MWR140-CBRMN	AYO10MWR140-CBRN

SIZE (mm)	CODE COUNTRY BRONZE	CODE STAINLESS STEEL	CODE WHITE
450	AYO10MWR45-CCTRYBRZ	AYO10MWR45-SS	AYO10MWR45WC
500	AYO10MWR50-CCTRYBRZ	AYO10MWR50-SS	AYO10MWR50WC
600	AYO10MWR60-CCTRYBRZ	AYO10MWR60-SS	AYO10MWR60WC
700	AYO10MWR70-CCTRYBRZ	AYO10MWR70-SS	AYO10MWR70WC
760	AYO10MWR76-CCTRYBRZ	AYO10MWR76-SS	AYO10MWR76WC
800	AYO10MWR80-CCTRYBRZ	AYO10MWR80-SS	AYO10MWR80WC
900	AYO10MWR90-CCTRYBRZ	AYO10MWR90-SS	AYO10MWR90WC
1000	AYO10MWR100-CCTRYBRZ	AYO10MWR100-SS	AYO10MWR100WC
1100	AYO10MWR110-CCTRYBRZ	AYO10MWR110-SS	AYO10MWR110WC
1200	AYO10MWR120-CCTRYBRZ	AYO10MWR120-SS	AYO10MWR120WC
1400	AYO10MWR140-CCTRYBRZ	AYO10MWR140-SS	AYO10MWR140WC

AYO<sup>®</sup>  
ROTATING PANEL  
10MM CLEAR GLASS

FINISHES:

- SILVER
- MATTE BLACK
- BRUSHED BRASS
- POLISHED GOLD
- MATTE NICKEL
- BRUSHED NICKEL
- COUNTRY BRONZE
- STAINLESS STEEL
- WHITE

Rotating panels help reduce water spray while keeping your space open.

**Rotating Panel:** Swings in and out for flexible access.

**Hinge Rotating Panel:** Opens in one direction, ideal for more defined spaces.

Note: Please order your front wetroom panel in the required size from page 136.

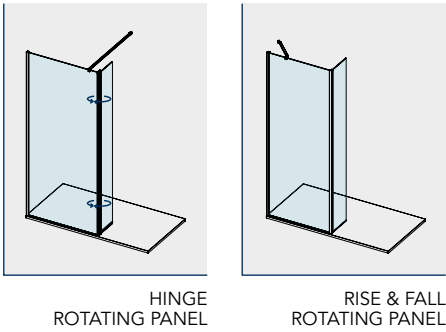

AYO – 10MM ROTATING PANELS - RISE & FALL HINGE MECHANISM*			
SIZE (mm)	CODE SILVER	CODE MATTE BLACK	CODE WHITE
300	AYO10RP30SC	AYO10RP30BC	AYO10RP30WC
450	AYO10RP45SC	AYO10RP45BC	AYO10RP45WC
500	AYO10RP50SC	AYO10RP50BC	—

\*Rotating Panels can be retrofitted.



AYO – 10MM HINGE ROTATING PANEL			
SIZE (mm)	CODE SILVER	CODE MATTE BLACK	CODE BRUSHED BRASS
300	AYO10HRP30SSC	AYO10HRP30BC	AYO10HRP30CBRBC
450	AYO10HRP45SSC	AYO10HRP45BC	AYO10HRP45CBRBC
500	AYO10HRP50SSC	AYO10HRP50BC	AYO10HRP50CBRBC

SIZE (mm)	CODE POLISHED GOLD	CODE MATTE NICKEL	CODE BRUSHED NICKEL
300	AYO10HRP30CPGC	AYO10HRP30CBRMNC	AYO10HRP30CBRNC
450	AYO10HRP45CPGC	AYO10HRP45CBRMNC	AYO10HRP45CBRNC
500	AYO10HRP50CPGC	AYO10HRP50CBRMNC	AYO10HRP50CBRNC

SIZE (mm)	CODE COUNTRY BRONZE	CODE STAINLESS STEEL
300	AYO10HRP30CCTRYBRZC	AYO10HRP30SSC
450	AYO10HRP45CCTRYBRZC	AYO10HRP45SSC
500	AYO10HRP50CCTRYBRZC	AYO10HRP50SSC



# AYO<sup>®</sup>

## CORNER WETROOM

### 10MM CLEAR GLASS

FINISHES:

- SILVER
- MATTE BLACK
- BRUSHED BRASS
- POLISHED GOLD
- MATTE NICKEL
- BRUSHED NICKEL
- COUNTRY BRONZE
- STAINLESS STEEL
- WHITE

Start by choosing your front wetroom panel from page 136, then select your side panel size from the options below. You must also order a T-Piece to complete the corner installation.

Create a spacious, stylish corner wetroom with a sleek two-panel layout supported by stainless steel stabilising bars. Add a matching T-piece for enhanced stability and a seamless, modern finish.

Note: Order your front panel in the size you need from page 136.

This page 140, shows some of our most popular sizes for corner configurations, but any size can be used to create your ideal layout.

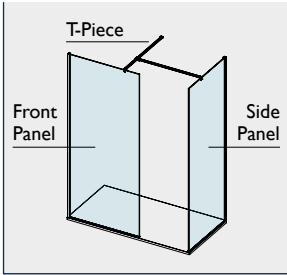

#### AYO – 10MM CORNER WETROOMS

SIZE (mm)	CODE SILVER	CODE MATTE BLACK	CODE BRUSHED BRASS
700	AYO10MWR70SC	AYO10MWR70BC	AYO10MWR70-CBRB
760	AYO10MWR76SC	AYO10MWR76BC	AYO10MWR76-CBRB
800	AYO10MWR80SC	AYO10MWR80BC	AYO10MWR80-CBRB
900	AYO10MWR90SC	AYO10MWR90BC	AYO10MWR90-CBRB

SIZE (mm)	CODE POLISHED GOLD	CODE MATTE NICKEL	CODE BRUSHED NICKEL
700	AYO10MWR70-CPG	AYO10MWR70-CBRMN	AYO10MWR70-CBRN
760	AYO10MWR76-CPG	AYO10MWR76-CBRMN	AYO10MWR76-CBRN
800	AYO10MWR80-CPG	AYO10MWR80-CBRMN	AYO10MWR80-CBRN
900	AYO10MWR90-CPG	AYO10MWR90-CBRMN	AYO10MWR90-CBRN

SIZE (mm)	CODE COUNTRY BRONZE	CODE STAINLESS STEEL
700	AYO8MWR70-CCTRYBRZ	AYO10MWR70-SS
760	AYO8MWR76-CCTRYBRZ	AYO10MWR76-SS
800	AYO8MWR80-CCTRYBRZ	AYO10MWR80-SS
900	AYO8MWR90-CCTRYBRZ	AYO10MWR90-SS

1200mm Straight Stabilising Bar included with wetrooms 700mm and over.

Choose your optional rotating panel from page 138.



CORNER WALK-IN WITH STRAIGHT & ANGLES STABILISING - SILVER

#### AYO – T-PIECES

SIZE (mm)	CODE SILVER	CODE MATTE BLACK	CODE BRUSHED BRASS
T-Piece	AYOTPS	AYOTPB	AYOTP-CBRB

SIZE (mm)	CODE POLISHED GOLD	CODE MATTE NICKEL	CODE BRUSHED NICKEL
T-Piece	AYOTP-CPG	AYOTP-CBRMN	AYOTP-CBRN

SIZE (mm)	CODE COUNTRY BRONZE	CODE WHITE
T-Piece	AYOTP-CCTRYBRZ	AYOTPW

# AYO<sup>®</sup> MODULAR

## YOUR SHOWER YOUR WAY

Elevate your showering experience with the flexibility and style of AYO Modular.

AYO Modular creates a step-by-step process that will help bring your dream shower space to life and is tailored to create a unique shower enclosure design that suits your style.

Choose from a variety of materials, colours and finishes to create the perfect ambience.

8 OR 10mm

TOUGHENED  
SAFETY GLASS



FOR A  
CORNER  
SPACE



FOR AN  
ALCOVE  
SPACE



FOR A  
STRAIGHT  
OPEN SPACE



HINGE ROTATING PANEL - CLEAR GLASS - MATTE BLACK



# THE PERFECT SHOWER MADE FOR YOU

## CHOOSE & MEASURE YOUR SPACE

First things first, analyse the area you have allowed for your shower, and get your measurements correct.

Then simply follow our 5 step process of selecting the components you need to create your personal shower sanctuary.

FOR A CORNER SPACE

FOR AN ALCOVE SPACE

FOR A STRAIGHT OPEN SPACE

**Please note:**  
It is suggested to leave a minimum of 500mm wide access when measuring for your wetroom panel.



## FOLLOW OUR SIMPLE 5 STEP PROCESS

1

CHOOSE YOUR LAYOUT

From page 146;  
Have a look at our configuration guide on the following pages to help you design your ideal shower space.

2

CHOOSE YOUR GLASS

From page 148;  
Choose from an 8mm or 10mm thickness, and also if you'd prefer clear, fluted\* or opaque\* glass.  
\*8mm only

3

CHOOSE YOUR WALL PROFILE & STABILISING SOLUTION

From page 150;  
Pick from a range of 9 finishes and a selection of stabilising solutions to suit your space and preference.

4

CHOOSE YOUR ACCESSORIES

From page 154;  
If needed finish your shower space with one of our accessories - available in a range of finishes.

5

CHOOSE YOUR ROTATING PANEL

From page 156;  
Add a rotating panel for added splash protection and a more versatile showering experience.

STEP 1  
CHOOSE YOUR LAYOUT

ENDLESS  
SHOWERING  
POSSIBILITIES

With an almost infinite choice of wetroom layouts, AYO provides maximum flexibility as you personalise your dream shower space.

For ease of ordering, we have created the following layouts for the most popular wetroom configurations.



LAYOUT C2  
WITH 8mm CLEAR GLASS - MATTE BLACK



LAYOUT A2  
HINGED ROTATING PANEL DETAIL -  
BRUSHED BRASS



LAYOUT A2  
HINGED ROTATING PANEL DETAIL -  
MATTE BLACK

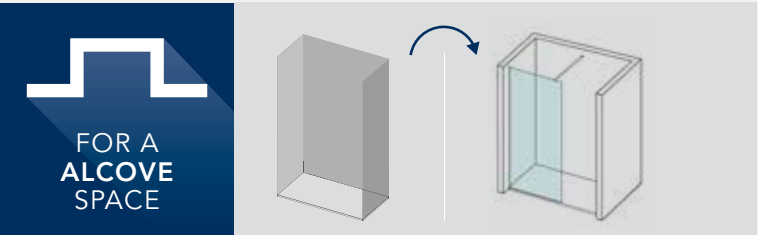

FOR A  
ALCOVE  
SPACE

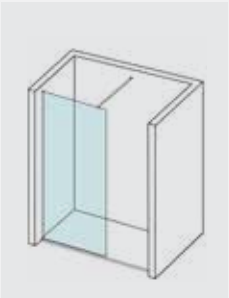

LAYOUT A1

- x1 Wall Profile
- x1 Glass Panel
- x1 Straight  
Stabilising Bar

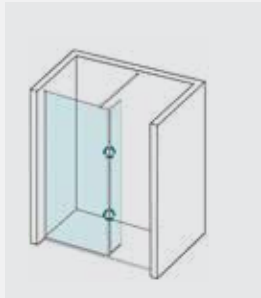

LAYOUT A2

- x1 Wall Profile
- x1 Glass Panel
- x1 Straight  
Stabilising Bar
- x1 Hinged Rotating Panel



FOR A  
CORNER  
SPACE

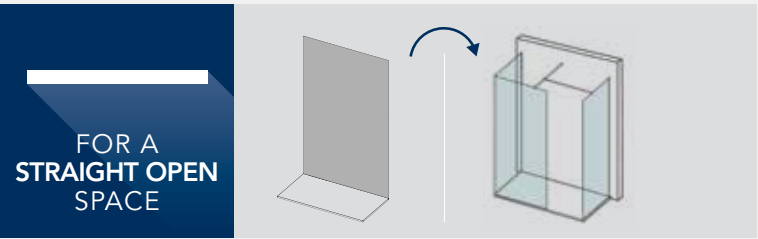
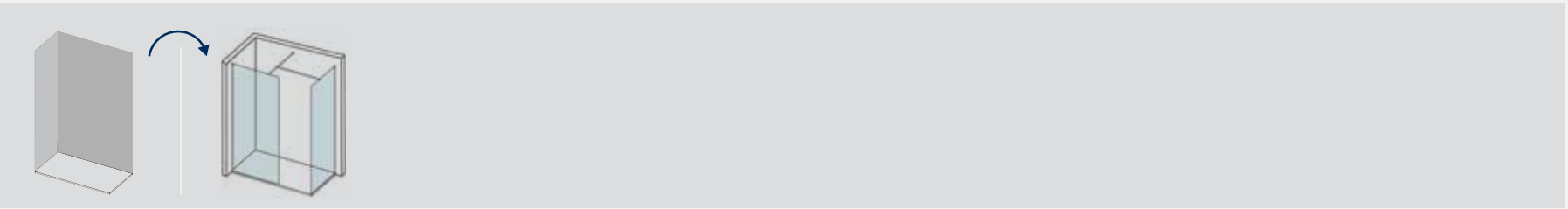

FOR A  
STRAIGHT OPEN  
SPACE

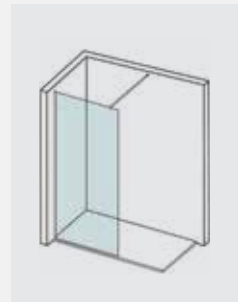

LAYOUT C1

- x1 Wall Profile
- x1 Glass Panel
- x1 Straight  
Stabilising Bar

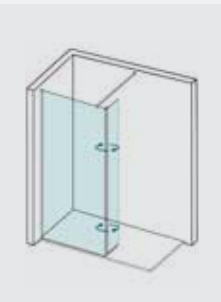

LAYOUT C2

- x1 Wall Profile
- x1 Glass Panel
- x1 Straight  
Stabilising Bar
- x1 Rotating Panel

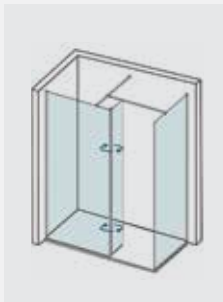

LAYOUT C3

- x2 Wall Profiles
- x2 Glass Panels
- x2 Straight  
Stabilising Bars
- x1 T-Piece
- x1 Rotating Panel



LAYOUT C1  
WITH 8mm  
CLEAR GLASS -  
MATTE BLACK



LAYOUT S2  
WITH 10mm CLEAR GLASS -  
COUNTRY BRONZE

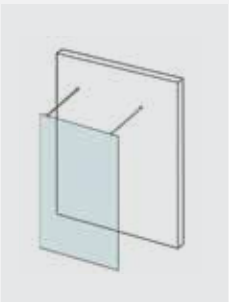

LAYOUT S1

- x1 Glass Panel
- x2 Straight  
Stabilising Bars

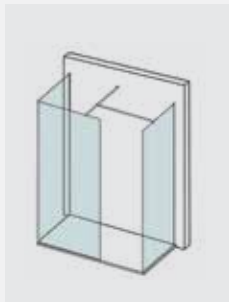

LAYOUT S2

- x2 Wall Profiles
- x3 Glass Panels
- x1 Ultra Clear  
Corner Seal
- x2 Straight  
Stabilising Bars
- x1 T-Piece

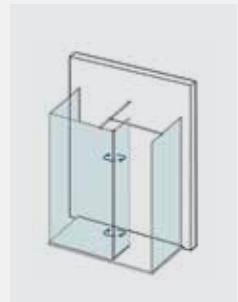

LAYOUT S3

- x2 Wall Profiles
- x3 Glass Panels
- x1 Ultra Clear  
Corner Seal
- x1 Rotating Panel
- x2 Straight  
Stabilising Bars
- x1 T-Piece



STEP 2  
CHOOSE YOUR GLASS

8mm  
TOUGHENED  
SAFETY GLASS

10mm  
TOUGHENED  
SAFETY GLASS

8mm Glass Wetroom Panel / 2000mm High

Suitable for use on wetroom floor or tray.

8MM GLASS WETROOM PANELS – CLEAR GLASS, FLUTED GLASS, OPAQUE GLASS OPTIONS			
SIZE (mm)	CODE CLEAR GLASS	CODE FLUTED	CODE OPAQUE
300	AYO8MW30C	AYO8MW30FC	–
400	AYO8MW40C	–	–
450	AYO8MW45C	–	–
500	AYO8MW50C	–	–
600	AYO8MW60C	–	–
700	AYO8MW70C	AYO8MW70FC	–
760	AYO8MW76C	–	–
800	AYO8MW80C	AYO8MW80FC	AYO8MW80PC
900	AYO8MW90C	AYO8MW90FC	AYO8MW90PC
1000	AYO8MW100C	AYO8MW100FC	AYO8MW100PC
1100	AYO8MW110C	–	–
1200	AYO8MW120C	AYO8MW120FC	AYO8MW120PC
1400	AYO8MW140C	AYO8MW140FC	AYO8MW140PC
1500	AYO8MW150C	–	–
1600	AYO8MW160C	–	–

10mm Glass Wetroom Panel / 2000mm High

Suitable for use on wetroom floor or tray.

10MM GLASS WETROOM PANELS – CLEAR GLASS ONLY	
SIZE (mm)	CODE CLEAR GLASS
300	AYO10MW30C
400	AYO10MW40C
450	AYO10MW45C
500	AYO10MW50C
600	AYO10MW60C
700	AYO10MW70C
760	AYO10MW76C
800	AYO10MW80C
900	AYO10MW90C
1000	AYO10MW100C
1100	AYO10MW110C
1200	AYO10MW120C
1400	AYO10MW140C

STEP 3  
CHOOSE YOUR WALL PROFILE  
& STABILISING SOLUTION

WALL PROFILES

FINISHES:

- SILVER
- MATTE BLACK
- BRUSHED BRASS
- POLISHED GOLD
- MATTE NICKEL
- BRUSHED NICKEL
- COUNTRY BRONZE
- STAINLESS STEEL

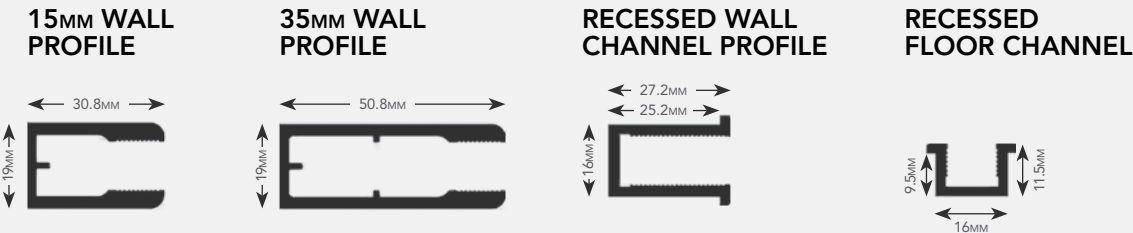

WALL PROFILES			
DESCRIPTION	CODE SILVER	CODE MATTE BLACK	CODE BRUSHED BRASS
15mm Wall Profile	AYOMW15WJS	AYOMW15WJB	AYOMW15WJSS-CBRB
35mm Wall Profile	AYOMW35WJS	AYOMW35WJB	—
Recessed Channel Wall & Floor Profile 2000mm	AYOMWCWJS	AYOMWCWJB	AYOMWCWJSS-CBRB
15mm Anodised Brushed Brass Wall Profile	—	—	AYOMW15WJBRB

DESCRIPTION	CODE POLISHED GOLD	CODE MATTE NICKEL	CODE BRUSHED NICKEL
15mm Wall Profile	AYOMW15WJSS-CPG	AYOMW15WJSS-CBRMN	AYOMW15WJSS-CBRN
Recessed Channel Wall & Floor Profile 2000mm	AYOMWCWJSS-CPG	AYOMWCWJSS-CBRMN	AYOMWCWJSS-CBRN

DESCRIPTION	CODE COUNTRY BRONZE	CODE STAINLESS STEEL
15mm Wall Profile	AYOMW15WJSS-CCTRYBRZ	AYOMW15WJS-SS
Recessed Channel Wall & Floor Profile 2000mm	AYOMWCWJSS-CCTRYBRZ	AYOMWCWJS-SS



MATTE BLACK WALL PROFILE (WITH HINGE ROTATING PANEL - SEE PAGE 156)



STABILISING SOLUTIONS

FINISHES:

- SILVER
- STAINLESS STEEL
- MATTE BLACK
- BRUSHED BRASS
- POLISHED GOLD
- MATTE NICKEL
- BRUSHED NICKEL
- COUNTRY BRONZE



BLACK STAINLESS STEEL STRAIGHT STABILISING BAR



BLACK L SHAPED STABILISING BAR



STAINLESS STEEL ANGLED STABILISING BAR



FLOOR TO CEILING STABILISING BAR



TOP OF GLASS TO CEILING STABILISING BAR

STRAIGHT STABILISING BARS

DESCRIPTION	CODE SILVER	CODE MATTE BLACK	CODE BRUSHED BRASS
1200mm Straight Stabilising Bar	AYOSSBS	AYOSSBB	AYOSSB-CBRB
1400mm Straight Stabilising Bar	AYO140SSBS	AYO140SSBB	—

DESCRIPTION	CODE POLISHED GOLD	CODE MATTE NICKEL	CODE BRUSHED NICKEL
1200mm Straight Stabilising Bar	AYOSSB-CPG	AYOSSB-CBRMN	AYOSSB-CBRN

DESCRIPTION	CODE COUNTRY BRONZE	CODE STAINLESS STEEL
1200mm Straight Stabilising Bar	AYOSSB-CCTRYBRZ	AYOSSBS
1400mm Straight Stabilising Bar	—	AYO140SSBS

ANGLED STABILISING BARS

DESCRIPTION	CODE SILVER	CODE MATTE BLACK	CODE BRUSHED BRASS
350mm Angled Short Stabilising Bar for 300 & 400mm Panels	AYOASBS-SH	AYOASBB-SH	AYOASB-SH-CBRB
650mm Angled Stabilising Bar	AYOASBS	AYOASBB	AYOASB-CBRB

DESCRIPTION	CODE POLISHED GOLD	CODE MATTE NICKEL	CODE BRUSHED NICKEL
350mm Angled Short Stabilising Bar for 300 & 400mm Panels	—	—	AYOASB-SH-CBRN
650mm Angled Stabilising Bar	AYOASB-CPG	AYOASB-CBRMN	AYOASB-CBRMN

DESCRIPTION	CODE COUNTRY BRONZE	CODE STAINLESS STEEL
350mm Angled Short Stabilising Bar for 300 & 400mm Panels	AYOASB-SH-CCTRYBRZ	AYOASBS-SH
650mm Angled Stabilising Bar	AYOASB-CCTRYBRZ	AYOASBS

CEILING STABILISING BARS

DESCRIPTION	CODE SILVER	CODE MATTE BLACK	CODE BRUSHED BRASS
Top of Glass to Ceiling Stabilising Bar - 600mm	AYOCSBS	AYOCSBB	AYOCSB-CBRB
Floor to Ceiling Stabilising Bar - 2600mm	AYOFCSBS	AYOFCSBB	—
Two Piece Floor to Ceiling Stabilising Bar - 2600mm	AYOF2CSBS	AYOF2CSBB	—
Two Piece Floor to Ceiling Stabilising Bar - 3000mm	AYOF2CSB3S	AYOF2CSB3B	—

OTHER STABILISING BARS

DESCRIPTION	CODE SILVER	CODE MATTE BLACK
L Shape Stabilising Bar - Length 1410mm / Height 220mm	AYOLSSBS	AYOLSSBB
Rotating Panel Stabilising Bar - 1200mm	AYORPSBS	AYORPSBB
1200mm Double Glass Bracket Stabilising Bar	AYODGBSBS	AYODGBSBB
1200mm Cutable Stabilising Bar with Angle & Straight Bracket	AYOCASSBS	AYOCASSBB

STEP 4  
CHOOSE YOUR ACCESSORIES

Required depending on your configuration.

Profile solutions

An array of wall profile solutions provides maximum versatility as each AYO wetroom aspiration becomes the reality.

All profile solutions are available in the standard Silver and Black options.

AYO COLOUR

Note: 15mm Wall Profile is available the premium colours - White, Brushed Brass, Matte Nickel, Stainless Steel and Polished Gold.

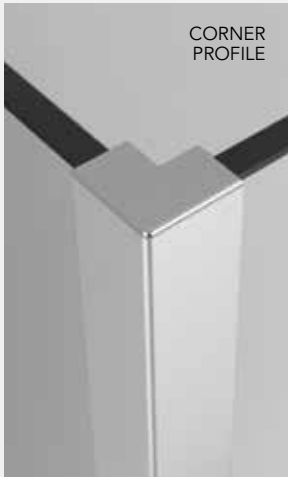

Seal solutions

AYO maximises your shower's visual appeal by offering an extensive selection of discreet ultra clear seal options.



SEALS – 2000MM HEIGHT

DESCRIPTION	CODE CLEAR SEAL	CODE BLACK SEAL
8mm Black Corner Seal	–	AYO8CSB
8mm Ultra Clear Corner Seal	AYO8CSC	–
8mm Ultra Clear H Joining Seal	AYO8JSC	–
10mm Black Corner Seal	–	AYO10CSB
10mm Ultra Clear Corner Seal	AYO10CSC	–
10mm Ultra Clear H Joining Seal	AYO10JSC	–

ACCESSORIES

DESCRIPTION	CODE SILVER	CODE MATTE BLACK	CODE BRUSHED BRASS
8mm U Channel - 1000mm	AYO8UC1000S	AYO8UC1000B	–
8mm U Channel - 2000mm	AYO8UCS	AYO8UCB	–
10mm U Channel - 1000mm	AYO10UC1000S	AYO10UC1000B	–
10mm U Channel - 2000mm	AYO10UCS	AYO10UCB	–
Corner Profile - 2000mm Height	AYOCPS	AYOCPB	–
H-Joining Profile - 2000mm Height	AYOHJPS	AYOHJPB	–
End Profile - 2000mm Height	AYOEPS	AYOEPB	–
Glass Joining Bracket	AYOGJBS	AYOGJBB	–
T-Piece	AYOTPS	AYOTPB	AYOTP-CBRB
Fixed Leg Support	AYOFSLS	AYOFSLB	AYOFSLCBRB

DESCRIPTION	CODE POLISHED GOLD	CODE MATTE NICKEL	CODE BRUSHED NICKEL
T-Piece	AYOTP-CPG	AYOTP-CBRMN	AYOTP-CBRN
Fixed Leg Support	–	–	–

DESCRIPTION	CODE COUNTRY BRONZE	CODE STAINLESS STEEL	CODE WHITE
T-Piece	AYOTP-CCTRYBRZ	AYOTPS	AYOTPW
Fixed Leg Support	–	AYOFSLS	–



STEP 5  
CHOOSE YOUR ROTATING PANEL

8MM ROTATING PANEL*			
SIZE (mm)	CODE SILVER	CODE MATTE BLACK	CODE WHITE
300	AYO8RP30SC	AYO8RP30BC	AYO8RP30WC
450	AYO8RP45SC	AYO8RP45BC	AYO8RP45WC
500	AYO8RP50SC	AYO8RP50BC	—

\*Rotating Panels can be retrofitted.

8MM PLATED FINISH - HANDED HINGE ROTATING PANEL		
SIZE (mm)	CODE SILVER	CODE MATTE BLACK
300 – Right Hand	AYO8HRPR30SC	AYO8HRPR30BC
450 – Right Hand	AYO8HRPR45SC	AYO8HRPR45BC
500 – Right Hand	AYO8HRPR50SC	AYO8HRPR50BC
300 – Left Hand	AYO8HRPL30SC	AYO8HRPL30BC
450 – Left Hand	AYO8HRPL45SC	AYO8HRPL45BC
500 – Left Hand	AYO8HRPL50SC	AYO8HRPL50BC

8MM HINGE ROTATING PANEL			
SIZE (mm)	CODE SILVER	CODE MATTE BLACK	CODE BRUSHED BRASS
300	AYO8HRP30SSC	AYO8HRP30BC	AYO8HRP30CBRBC
450	AYO8HRP45SSC	AYO8HRP45BC	AYO8HRP45CBRBC
500	AYO8HRP50SSC	AYO8HRP50BC	AYO8HRP50CBRBC

SIZE (mm)	CODE POLISHED GOLD	CODE MATTE NICKEL	CODE BRUSHED NICKEL
300	AYO8HRP30CPGC	AYO8HRP30CBRMNC	AYO8HRP30CBRNC
450	AYO8HRP45CPGC	AYO8HRP45CBRMNC	AYO8HRP45CBRNC
500	AYO8HRP50CPGC	AYO8HRP50CBRMNC	AYO8HRP50CBRNC

SIZE (mm)	CODE COUNTRY BRONZE	CODE STAINLESS STEEL
300	AYO8HRP30CCTRYBRZC	AYO8HRP30SSC
450	AYO8HRP45CCTRYBRZC	AYO8HRP45SSC
500	AYO8HRP50CCTRYBRZC	AYO8HRP50SSC

FINISHES:

SILVER	MATTE BLACK	BRUSHED BRASS
POLISHED GOLD	MATTE NICKEL	BRUSHED NICKEL
COUNTRY BRONZE	STAINLESS STEEL	WHITE

10MM ROTATING PANEL*			
SIZE (mm)	CODE SILVER	CODE MATTE BLACK	CODE WHITE
300	AYO10RP30SC	AYO10RP30BC	AYO10RP30WC
450	AYO10RP45SC	AYO10RP45BC	AYO10RP45WC
500	AYO10RP50SC	AYO10RP50BC	—

\*Rotating Panels can be retrofitted.

10MM HINGE ROTATING PANEL			
SIZE (mm)	CODE SILVER	CODE MATTE BLACK	CODE BRUSHED BRASS
300	AYO10HRP30SSC	AYO10HRP30BC	AYO10HRP30CBRBC
450	AYO10HRP45SSC	AYO10HRP45BC	AYO10HRP45CBRBC
500	AYO10HRP50SSC	AYO10HRP50BC	AYO10HRP50CBRBC

SIZE (mm)	CODE POLISHED GOLD	CODE MATTE NICKEL	CODE BRUSHED NICKEL
300	AYO10HRP30CPGC	AYO10HRP30CBRMNC	AYO10HRP30CBRNC
450	AYO10HRP45CPGC	AYO10HRP45CBRMNC	AYO10HRP45CBRNC
500	AYO10HRP50CPGC	AYO10HRP50CBRMNC	AYO10HRP50CBRNC

SIZE (mm)	CODE COUNTRY BRONZE	CODE STAINLESS STEEL
300	AYO10HRP30CCTRYBRZC	AYO10HRP30SSC
450	AYO10HRP45CCTRYBRZC	AYO10HRP45SSC
500	AYO10HRP50CCTRYBRZC	AYO10HRP50SSC

# AYO<sup>®</sup> 8MM BATHSCREENS

AVAILABLE IN **CLEAR GLASS & FLUTED GLASS**

Elevate your over-bath showering with the 8mm AYO Bathscreens, available in both clear and fluted glass for a clean or textured look.

Finished in your choice of Matte Black, Silver, Brushed Brass, Brushed Nickel or Country Bronze - each screen combines modern style with robust performance to complement any contemporary bathroom design.





# AYO®

## 8MM BATHSCREENS

FINISHES:

- SILVER
- MATTE BLACK
- BRUSHED BRASS
- BRUSHED NICKEL
- COUNTRY BRONZE



AYO 8MM BATHSCREENS - CLEAR GLASS		
SIZE / DESCRIPTION	COLOUR	CODE
800 x 1500mm Framed Fixed Bathscreen	Black	AYO8BSBCM
800 x 1500mm Framed Fixed Bathscreen	Brushed Brass	AYO8BSBRBC
800 x 1500mm Fixed Bathscreen Includes 15mm Wall Profile & 350mm Angled Stabilising Bar	Matt Black	AYO8MBSBC
800 x 1500mm Fixed Bathscreen Includes 15mm Wall Profile & 350mm Angled Stabilising Bar	Brushed Brass	AYO8MBSBRBC
800 x 1500mm Fixed Bathscreen Includes 15mm Wall Profile & 350mm Angled Stabilising Bar	Brushed Nickel	AYO8MBSBRNC
800 x 1500mm Fixed Bathscreen Includes 15mm Wall Profile & 350mm Angled Stabilising Bar	Silver	AYO8MBSSC
800 x 1500mm Framed Bathscreen	Matt Black	AYO8FBSBBC
800 x 1500mm Linear Bathscreen Includes 15mm Wall Profile & 350mm Angled Stabilising Bar	Matt Black	AYO8FHBSBBC

AYO 8MM BATHSCREENS - FLUTED GLASS		
SIZE / DESCRIPTION	COLOUR	CODE
800 x 1500mm Frameless Bathscreen Includes 15mm Wall Profile & 350mm Angled Stabilising Bar	Matte Black	AYO8BSFBC
800 x 1500mm Frameless Bathscreen Includes 15mm Wall Profile & 350mm Angled Stabilising Bar	Brushed Brass	AYO8BSFBRBC
800 x 1500mm Frameless Bathscreen Includes 15mm Wall Profile & 350mm Angled Stabilising Bar	Brushed Nickel	AYO8BSFBRNC
800 x 1500mm Frameless Bathscreen Includes 15mm Wall Profile & 350mm Angled Stabilising Bar	Country Bronze	AYO8BSFCCTRYBRZ
800 x 1500mm Frameless Bathscreen Includes 15mm Wall Profile & 350mm Angled Stabilising Bar	Silver	AYO8BSFSC
1500 x 800mm Framed Bathscreen Includes 15mm Wall Profile & 350mm Angled Stabilising Bar	Matt Black	AYO8FBSBBFC

# GEMSTONE

The Gemstone brand is synonymous with quality and style. This extensive selection of slate textured shower trays compliment the most beautiful of bathroom designs. With an ultra minimal height of 25 to 30mm, each tray is anti-slip rated and available in 4 colour options White, Graphite Black, Flint Grey and Onyx Black.

Choose from square or linear shape shower drain options. Both visually appealing and sensual to touch, a Gemstone shower tray will work perfectly in a wide variety of bathroom applications, be they classic, modern or contemporary in design.

# SHOWER TRAY COLLECTION

TEXTURED SLATE,  
SLIMLINE, ANTI-SLIP  
& ULTRA SLIM





Gemstone slate tray range with linear waste in Flint Grey

# GEMSTONE

## KEY FEATURES

- Slate texture – a natural stone resin composite with gel coat finish
- Anti slip rated** – Grade 3 Rating UNE ENV 12633:2003
- Available in 4 colours – Onyx Black, White, Graphite Black & Flint Grey
- Minimalist stainless steel waste cover in Square versions
- Stone resin linear cover standard on all linear trays
- Colour matched interior waste trap (Onyx Black, Graphite Black or Flint Grey = Grey interior waste / White tray - White interior waste)
- Supplied with 90mm McAlpine high flow waste



GRADE 3 ANTI SLIP RATED

ANTIBACTERIAL WITH NON POROUS SURFACE

CHEMICAL RESISTANCE IN ACCORDANCE WITH UNE EN 12527

MAY BE CUT WITH A DIAMOND CUTTING WHEEL

EASY TRANSPORT / DURABLE PACKAGING

90 mm

HI-FLOW WASTE

CE APPROVED

25mm or 30mm

TRAY DEPTH

## GEMSTONE TRAY COLOUR OPTIONS



WHITE TRAY with square waste.



FLINT GREY TRAY with colour matched grille.



STONE RESIN waste covers.

Note: Gemstone tray colours are reproduced as accurately as the printing process will allow. There is no guarantee of exact colour match - this brochure is a visual aid only.



GEMSTONE SLATE TRAY RANGE – SQUARE WASTE  
HEIGHT – 25mm

includes 90mm McAlpine manufactured high flow waste



RECTANGULAR TRAYS

SIZE (mm)	CODE WHITE	CODE GRAPHITE BLACK	CODE FLINT GREY	CODE ONYX BLACK
1000 x 800	GEM10080RWS	GEM10080RBS	GEM10080RGs	GEM10080ROS
1000 x 900	GEM10090RWS	GEM10090RBS	GEM10090RGs	GEM10090ROS
1100 x 800	GEM11080RWS	GEM11080RBS	GEM11080RGs	–
1100 x 900	GEM11090RWS	GEM11090RBS	GEM11090RGs	–
1200 x 800	GEM12080RWS	GEM12080RBS	GEM12080RGs	GEM12080ROS
1200 x 900	GEM12090RWS	GEM12090RBS	GEM12090RGs	GEM12090ROS
1200 x 1000	GEM120100RWS*	GEM120100RBS	GEM120100RGs*	GEM120100ROS*
1400 x 800	GEM14080RWS	GEM14080RBS	GEM14080RGs	GEM14080ROS
1400 x 900	GEM14090RWS	GEM14090RBS	GEM14090RGs	GEM14090ROS
1400 x 1000	GEM140100RWS	GEM140100RBS*	GEM140100RGs*	GEM140100ROS*
1500 x 800	GEM15080RWS	GEM15080RBS	GEM15080RGs	–
1500 x 900	GEM15090RWS	GEM15090RBS	GEM15090RGs	–
1600 x 800	GEM16080RWS	GEM16080RBS	GEM16080RGs	GEM16080ROS
1600 x 900	GEM16090RWS	GEM16090RBS	GEM16090RGs	GEM16090ROS
1700 x 700	GEM17070RWS	GEM17070RBS	GEM17070RGs	–
1700 x 800	GEM17080RWS	GEM17080RBS	GEM17080RGs	GEM17080ROS
1700 x 900	GEM17090RWS	GEM17090RBS	GEM17090RGs	GEM17090ROS
1800 x 800	GEM18080RWS	GEM18080RBS	GEM18080RGs	–
1800 x 900	GEM18090RWS	GEM18090RBS	GEM18090RGs	–
2000 x 800	GEM20080RWS	GEM20080RBS	–	GEM20080ROS
2000 x 900	GEM20090RWS	GEM20090RBS	–	GEM20090ROS

SQUARE TRAYS

SIZE (mm)	CODE WHITE	CODE GRAPHITE BLACK	CODE FLINT GREY	CODE ONYX BLACK
800	GEM80SWS	GEM80SBS	GEM80SGS	GEM80SOS
900	GEM90SWS	GEM90SBS	GEM90SGS	GEM90SOS
1000	GEM100SWS	GEM100SBS	GEM100SGS	–

OFFSET QUADRANT TRAYS – LEFT HAND

SIZE (mm)	CODE WHITE	CODE GRAPHITE BLACK	CODE FLINT GREY	CODE ONYX BLACK
1000 x 800	GEM10080QWSL	GEM10080QBSL	GEM10080QGSL	–
1200 x 800	GEM12080QWSL	GEM12080QBSL	GEM12080QGSL	GEM12080QOSL
1200 x 900	GEM12090QWSL	GEM12090QBSL	GEM12090QGSL	GEM12090QOSL

OFFSET QUADRANT TRAYS – RIGHT HAND

SIZE (mm)	CODE WHITE	CODE GRAPHITE BLACK	CODE FLINT GREY	CODE ONYX BLACK
1000 x 800	GEM10080QWSR	GEM10080QBSR	GEM10080QGSR	–
1200 x 800	GEM12080QWSR	GEM12080QBSR	GEM12080QGSR	GEM12080QOSR
1200 x 900	GEM12090QWSR	GEM12090QBSR	GEM12090QGSR	GEM12090QOSR

QUADRANT TRAYS

SIZE (mm)	CODE WHITE	CODE GRAPHITE BLACK	CODE FLINT GREY	CODE ONYX BLACK
900	GEM90QWS	GEM90QBS	GEM90QGS	GEM90QOS
1000	GEM100QWS	GEM100QBS	GEM100QGS	–

COLOUR MATCHED METAL GRILLES – SQUARE

DESCRIPTION	COLOUR	CODE
Square Grille	White	GEMGSW
Square Grille	Chrome	GEMGSC
Square Grille	Flint Grey	GEMGSG
Square Grille	Graphite Black	GEMGSB
Square Grille	Onyx Black	GEMGSOB

GEMSTONE SLATE TRAY RANGE – LINEAR WASTE  
HEIGHT – 30mm

includes 90mm McAlpine manufactured high flow waste

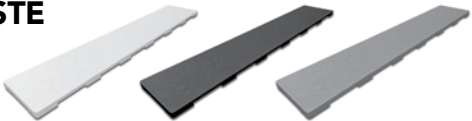

RECTANGULAR TRAYS – INCLUDES STONE RESIN LINEAR GRILLE COVER

SIZE (mm)	CODE WHITE	CODE GRAPHITE BLACK	CODE FLINT GREY	CODE ONYX BLACK
1200 x 800	GEM12080RWL	GEM12080RBL	GEM12080RGL	GEM12080ROBL
1200 x 900	GEM12090RWL	GEM12090RBL	GEM12090RGL	GEM12090ROBL
1400 x 800	GEM14080RWL	GEM14080RBL	GEM14080RGL	GEM14080ROBL
1400 x 900	GEM14090RWL	GEM14090RBL	GEM14090RGL	GEM14090ROBL
1500 x 800	GEM15080RWL	GEM15080RBL	GEM15080RGL	–
1500 x 900	GEM15090RWL	GEM15090RBL	GEM15090RGL	–
1600 x 800	GEM16080RWL	GEM16080RBL	GEM16080RGL	–
1600 x 900	GEM16090RWL	GEM16090RBL	GEM16090RGL	–
1700 x 700	GEM17070RWL	GEM17070RBL	GEM17070RGL	GEM17070ROBL
1700 x 800	GEM17080RWL	GEM17080RBL	GEM17080RGL	GEM17080ROBL
1700 x 900	GEM17090RWL	GEM17090RBL	GEM17090RGL	GEM17090ROBL

COLOUR MATCHED METAL GRILLES – LINEAR (STAINLESS STEEL MATERIAL)

SIZE (mm)	CODE WHITE	CODE CHROME	CODE GREY	CODE BLACK	CODE ONYX BLACK
700mm	GEMG70LW	GEMG70LC	GEMG70LG	GEMG70LB	GEMG70LOB
800mm	GEMG80LW	GEMG80LC	GEMG80LG	GEMG80LB	GEMG80LOB
900mm	GEMG90LW	GEMG90LC	GEMG90LG	GEMG90LB	GEMG90LOB

\*Discontinued once stock is sold



# GEMSTONE INFORMATION

## GUARANTEE

Your Gemstone tray must be inspected 100% before installation. Fitting of tray is acceptance of quality. Please read fitting instructions fully before installation.

Before tiling and placing the screen or any other fixed material on the shower tray, please make sure that the perimeters of your tray are 100% level in all directions.

The guarantee only covers the replacement or repair of the product and excludes any other compensation, assembly or travel costs.

Gemstone Trays are guaranteed for 2 years, in accordance with current European regulations.

- The following are excluded from the guarantee:**
- Damage caused by misuse.
  - Damage caused by the use of unsuitable cleaning materials (do not use products containing acids, alcohol, chlorine or solvents, do not spill drain cleaners onto the shower tray, do not use metallic or scouring pads).
  - Damage caused by improper installation.
  - Damage caused by the improper handling of the product.

Our products must be installed by qualified personnel to be eligible for the product guarantee. An installation guide will be delivered with the tray for its proper placement.

- Before installing the tray you should make sure that:**
- The tray drains well and is 100% level.
  - It has no anomalies.
  - **The tray has been stored in a horizontal position on a flat surface until installation.**

## CLEANING

- Routine: rinse and leave to dry.
- Thorough: rub with a soft cloth with neutral liquid detergent; for limescale prevention use an anti-lime product.

*Please note, Gemstone Trays are manufactured from a natural stone resin composition. You must allow for a tray thickness tolerance of 2 - 3mm.*

## CHEMICAL TESTS

Chemical resistance tested in accordance with UNE-EN 12527 - No deterioration.

## CHEMICAL TESTING COMPOSITION

Acetyl acid (10%), sodium hydroxide (10%), ethanol (70%), bleach, methylene blue (1%).

CLEANING SOLVENT (PRODUCT)	EXPOSURE TIME (DAYS)	RESULT OF VISUAL INSPECTION
Don Limpio Neutral PH	4	No Visible Effect
Perfumed Home Bleach	4	Slight Bleaching
Ace	4	Slight Bleaching
Perfumed Ammonia	4	No Visible Effect
Viakal	4	Slight Bleaching
Cillit Bang	4	No Visible Effect
KH-7 Anti-lime	4	No Visible Effect
White Wine Vinegar	4	No Visible Effect
Povidone Iodine	4	No Visible Effect
Hydrochloric Acid	4	No Visible Effect
Hydrogen Peroxide	4	No Visible Effect
Cleaning Solvent	4	No Visible Effect
Methylated Spirits	4	No Visible Effect
Acetone	4	No Visible Effect
Nail Polish Remover	4	No Visible Effect

## PACKAGING AND STORAGE

The products are delivered packed in individual boxes with expanded polystyrene reinforcements, including the drainage grate. Gemstone trays must be stored in a horizontal position on a flat surface until installation. This prevents the tray from losing shape.

## FAQ

**Can it be cut?**  
Yes, with a diamond cutting wheel.

*Please note, Maximum trim of 200mm on rectangular waste trays. Maximum trim of 100mm on linear waste trays, with the cut applied to opposite end to the linear drain.*

**Can it be repaired?**  
Although they are highly resistant to any impact, we have a repair kit available to the customer. Please contact us on 01279 443 644 to order your Gemstone Tray repair kit. Lead time applies.

**How should the product be cleaned?**  
We recommend cleaning with water and neutral soap, applied with a sponge, never with scouring products or tools.

**What material should I use to install the products?**  
Your Gemstone tray must be installed on a fully level glue-cement or mortar base. For sealing the product, it is recommended to use MS flexible polyurethane sealant and / or a neutral silicone.



# SLIMLINE

40mm high stone resin tray with waste.



RECTANGLE TRAY



SQUARE TRAY



OFFSET QUADRANT TRAY



QUADRANT TRAY

# ULTRA SLIM

25mm high stone resin tray with waste and White grille.



RECTANGLE TRAY



SQUARE TRAY



QUADRANT TRAY



OFFSET QUADRANT TRAY

Brushed Brass and Matte Black grilles available with Ultra Slim trays.

SLIMLINE SHOWER TRAYS

HEIGHT – 40MM (INCLUDES WASTE)

Note. There is a tolerance of up to 10mm in tray sizes above the nominal dimensions.  
This is to allow for potential shrinkage during the manufacturing process.

RECTANGULAR TRAYS

SIZE (mm)	CODE WHITE
800 x 700	TSL8070R
900 x 700	TSL9070R
900 x 760	TSL9076R
900 x 800	TSL9080R
1000 x 700	TSL10070R
1000 x 760	TSL10076R
1000 x 800	TSL10080R
1000 x 900	TSL10090R
1100 x 700	TSL11070R
1100 x 760	TSL11076R
1100 x 800	TSL11080R
1100 x 900	TSL11090R
1200 x 700	TSL12070R
1200 x 760	TSL12076R
1200 x 800	TSL12080R
1200 x 900	TSL12090R
1200 x 1000	TSL120100R
1300 x 800	TSL13080R
1300 x 900	TSL13090R
1400 x 700	TSL14070R
1400 x 760	TSL14076R
1400 x 800	TSL14080R
1400 x 900	TSL14090R
1500 x 700	TSL15070R
1500 x 760	TSL15076R
1500 x 800	TSL15080R
1500 x 900	TSL15090R
1600 x 700	TSL16070R
1600 x 800	TSL16080R
1600 x 900	TSL16090R
1700 x 700	TSL17070R
1700 x 750	TSL17075R
1700 x 800	TSL17080R
1700 x 900	TSL17090R
1800 x 800	TSL18080R
1800 x 900	TSL18090R
2000 x 900	TSL20090R

SQUARE TRAYS

SIZE (mm)	CODE WHITE
700 x 700	TSL70S
760 x 760	TSL76S
800 x 800	TSL80S
900 x 900	TSL90S
1000 x 1000	TSL100S
1200 x 1200	TSL120S

QUADRANT TRAYS

SIZE (mm)	CODE WHITE
800 x 800	TSL80Q
900 x 900	TSL90Q
1000 x 1000	TSL100Q

OFFSET QUADRANT TRAYS

SIZE (mm)	CODE WHITE
900 x 760 - Left	TSL9076LOQ
900 x 760 - Right	TSL9076ROQ
900 x 800 - Left	TSL9080LOQ
900 x 800 - Right	TSL9080ROQ
1000 x 800 - Left	TSL10080LOQ
1000 x 800 - Right	TSL10080ROQ
1000 x 900 - Left	TSL10090LOQ
1000 x 900 - Right	TSL10090ROQ
1100 x 800 - Left	TSL11080LOQ
1100 x 800 - Right	TSL11080ROQ
1100 x 900 - Left	TSL11090LOQ
1100 x 900 - Right	TSL11090ROQ
1200 x 800 - Left	TSL12080LOQ
1200 x 800 - Right	TSL12080ROQ
1200 x 900 - Left	TSL12090LOQ
1200 x 900 - Right	TSL12090ROQ



SLIMLINE ANTI-SLIP SHOWER TRAYS

HEIGHT – 40MM (INCLUDES WASTE)

Note. There is a tolerance of up to 10mm in tray sizes above the nominal dimensions.  
This is to allow for potential shrinkage during the manufacturing process.

RECTANGULAR TRAYS

SIZE (mm)	CODE WHITE
1000 x 800	ASTSL10080R
1000 x 900	ASTSL10090R
1100 x 800	ASTSL11080R
1100 x 900	ASTSL11090R
1200 x 700	ASTSL12070R
1200 x 760	ASTSL12076R
1200 x 800	ASTSL12080R
1200 x 900	ASTSL12090R
1400 x 700	ASTSL14070R
1400 x 800	ASTSL14080R
1400 x 900	ASTSL14090R
1500 x 700	ASTSL15070R
1500 x 800	ASTSL15080R
1500 x 900	ASTSL15090R
1600 x 700	ASTSL16070R
1600 x 800	ASTSL16080R
1600 x 900	ASTSL16090R
1700 x 700	ASTSL17070R
1700 x 800	ASTSL17080R
1700 x 900	ASTSL17090R

OFFSET QUADRANT TRAYS

SIZE (mm)	CODE WHITE
1000 x 800 - Left	ASTSL10080LOQ
1000 x 800 - Right	ASTSL10080ROQ
1000 x 900 - Left	ASTSL10090LOQ
1000 x 900 - Right	ASTSL10090ROQ
1200 x 800 - Left	ASTSL12080LOQ
1200 x 800 - Right	ASTSL12080ROQ
1200 x 900 - Left	ASTSL12090LOQ
1200 x 900 - Right	ASTSL12090ROQ

TRAYS WITH CORNER WASTE

SIZE (mm)	CODE WHITE
900 x 900 - Quadrant	CASTSL90Q
1000 x 1000 - Quadrant	CASTSL100Q
800 x 800 - Square	CASTSL80S
900 x 900 - Square	CASTSL90S
1000 x 1000 - Square	CASTSL100S
1000 x 800 - Rectangle	CASTSL10080R
1200 x 800 - Rectangle	CASTSL12080R
1200 x 900 - Rectangle	CASTSL12090R

SQUARE TRAYS

SIZE (mm)	CODE WHITE
800	ASTSL80S
900	ASTSL90S
1000	ASTSL100S

QUADRANT TRAYS

SIZE (mm)	CODE WHITE
800	ASTSL80Q
900	ASTSL90Q
1000	ASTSL100Q



ANTI-SLIP  
SURFACE



# ULTRA SLIM SHOWER TRAYS

HEIGHT – 25MM (INCLUDES WASTE & WHITE GRILLE)

Note. There is a tolerance of up to 10mm in tray sizes above the nominal dimensions. This is to allow for potential shrinkage during the manufacturing process.

## RECTANGULAR TRAYS

SIZE (mm)	CODE WHITE
1000 x 800	USLI0080R
1000 x 900	USLI0090R
1200 x 800	USLI2080R
1200 x 900	USLI2090R
1400 x 800	USLI4080R
1400 x 900	USLI4090R
1500 x 800	USLI5080R
1500 x 900	USLI5090R
1600 x 800	USLI6080R
1600 x 900	USLI6090R
1700 x 800	USLI7080R
1700 x 900	USLI7090R
1800 x 800	USLI8080R
1800 x 900	USLI8090R

## SQUARE TRAYS

SIZE (mm)	CODE WHITE
800 x 800	USL80S
900 x 900	USL90S
1000 x 1000	USLI00S

## QUADRANT TRAYS

SIZE (mm)	CODE WHITE
800 x 800	USL80Q
900 x 900	USL90Q

## OFFSET QUADRANT TRAYS

SIZE (mm)	CODE WHITE
1000 x 800 - Left	USLI0080LOQ
1000 x 800 - Right	USLI0080ROQ
1200 x 800 - Left	USLI2080LOQ
1200 x 800 - Right	USLI2080ROQ
1200 x 900 - Left	USLI2090LOQ
1200 x 900 - Right	USLI2090ROQ

# ULTRA SLIM ANTI-SLIP SHOWER TRAYS

HEIGHT – 25MM (INCLUDES WASTE & WHITE GRILLE)

Note. There is a tolerance of up to 10mm in tray sizes above the nominal dimensions. This is to allow for potential shrinkage during the manufacturing process.

## RECTANGULAR TRAYS

SIZE (mm)	CODE WHITE
1000 x 800	AUSLI0080R
1200 x 800	AUSLI2080R
1200 x 900	AUSLI2090R
1400 x 800	AUSLI4080R
1400 x 900	AUSLI4090R
1500 x 800	AUSLI5080R
1600 x 800	AUSLI6080R
1600 x 900	AUSLI6090R
1700 x 800	AUSLI7080R
1700 x 900	AUSLI7090R

## SQUARE TRAYS

SIZE (mm)	CODE WHITE
900 x 900	AUSL90S



ANTI-SLIP  
SURFACE

## The Benefits of using Anti-Slip Technology:

Clever Anti-Slip surface technology for a lifetime of showering confidence. Ideally suited to families with young children and those who just want to feel confident on their feet while in the shower, this unique patented technology ensures a lifetime of underfoot confidence when showering.

Unlike other Anti-Slip technologies which are applied on top of the surface of the tray after manufacture and wear away over time, our patented Anti-Slip surface is integrated directly into the shower tray at time of manufacture, meaning it never wears away and will last as long as the shower tray.

The Anti-Slip range offers a permanent guaranteed solution. When independently tested to the British standard 7976-2 test, the patent protected surface provided almost twice the bathroom industry standard of slip resistance.

## Smart Water Management Control

Our unique Smart Water Management Technology clears water instantly from the tray's surface. This greatly reduced the slip hazard of surplus water and soap deposits.

Although the tray surface appears almost flat, it combines perfectly with the vortex technology of the waste unit to create a vacuum effect beneath the surface.

The result is that almost all surplus water is actually drawn from the tray's surface instantly. In addition, no moving parts or hair traps means no maintenance and no risk of flooding.



ULTRA SLIM RECTANGLE TRAY  
INCLUDING WASTE AND WHITE GRILLE



ULTRA SLIM SQUARE TRAY  
INCLUDING WASTE AND WHITE GRILLE



ULTRA SLIM QUADRANT TRAY  
INCLUDING WASTE AND WHITE GRILLE



ULTRA SLIM OFFSET QUADRANT TRAY  
INCLUDING WASTE AND WHITE GRILLE

SHOWER ACCESSORIES

FLAIR EASY PLUMB KIT

Flair slimline easy plumb shower kits have adjustable legs to comply with building regulations to assist in installation and for maintenance of waste outlets if required after building settlement.

The Flair slimline easy plumb kit provides this access without compromising on style in the bathroom. An easy plumb tray can be made by using any of the Flair slimline trays and a kit. This will increase the height of the tray by 95mm.

Accessories are not to scale - for visual representation only.



DESCRIPTION	WEIGHT	CODE
Easy Plumb Riser Kit for all Square Trays & Rectangle Trays (Suitable for maximum tray size of 1200mm)	2kg	WD3
Easy Plumb Riser Kit for all Quadrant Trays (Suitable for maximum tray size of 1200 x 900mm)	3kg	WD4
Easy Plumb Kit for all Square & Rectangle Trays (Up to 2000mm in size)	2kg	WD5

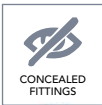

PROSEAL WATERPROOF BARRIER SEAL

ROLL SIZE (mm)	CODE
2.0 metre	PROS2.0M
2.5 metre	PROS2.5M
3.0 metre	PROS3.0M
3.5 metre	PROS3.5M
4.0 metre	PROS4.0M
10 metre	PROS10.0M
20 metre	PROS20.0M

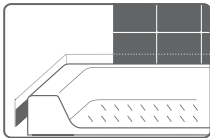
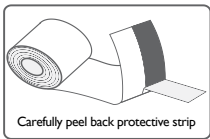

Flexible up-stand seal installed onto shower trays, baths and worktops eliminating the risk of water leakage.

SHOWER WASTE

DESCRIPTION	CODE
Tourbillion 90mm Shower Trap & Waste - Chrome	WIRCHROME



McAlpine 90mm Shower Waste Matte Black Plastic Dome.

McALPINE WASTES

DESCRIPTION	CODE
McAlpine 90mm Shower Waste Matte Black Plastic Dome	ST90MB10-70
McAlpine 90mm Shower Waste Matte White Plastic Dome	ST90WH10-70

SHOWER TRAP WASTES

Further enhance the look of your shower tray with our 90mm High Flow Shower Wastes in the following colours; Brushed Brass, Brushed Copper, Brushed Nickel, Matte Black and Matte White.



Brushed Brass  
TSLWASTEBC



Brushed Copper  
TSLWASTEBC



Brushed Nickel  
TSLWASTEBC



Matte Black  
TSLWASTEBC



Matte White  
TSLWASTEBC





# QUALITY GUARANTEED

## QUALITY GUARANTEED

Please consult the relevant consumer product brochure to view the Guarantee terms offered on each Flair product range.

At Flair we have an unwavering commitment to product quality.

All Flair products are CE approved and manufactured in accordance with ISO 9001:2015 Quality Assurance systems and ISO 14001:2015 Environmental Management systems.

All glass is toughened safety glass and produced to EN12150. Flair products are performance tested to EN14428, ensuring the highest industry criteria is met.

**Note: Proof of purchase is necessary to validate your guarantee so retain purchase receipt for your Flair product.**

If a Flair shower enclosure is defective in materials or manufacture, please contact us on (Ireland & Northern Ireland) +353 42 966 8000 or (UK) 0800 1800 8050.

## AFTERSALES & SPARE PARTS SERVICE

Flair is 100% committed to customer service excellence.

We carry a full range of spare parts for each product range and have dedicated aftersales specialists to deal with any issues you may have.

If you have any queries, please contact Flair on 00353 42 966 8000.

## RETURN POLICY

Flair will not accept return of any product that has been opened.

We do not accept return of any product if the packaging has been damaged.

If the product is unopened and not damaged, we will accept the return of the product but a handling fee of 25% of the invoice will be charged.

## SHOWER DOOR INSTALLATION ADVICE

BEFORE YOU INSTALL YOUR SHOWER ENCLOSURE PLEASE READ ALL INSTRUCTIONS. FAILURE TO DO SO MAY LEAD TO INVALIDATION OF YOUR GUARANTEE.

Flair Showers Ltd will not accept responsibility for any loss or damage, however caused, if the shower enclosure has not been installed as per the instructions.

- The shower tray MUST be fitted 100% level. The shower tray must be sealed correctly to prevent any water leakage.
- Glass edges are vulnerable and should be treated with care at all times. Contact with hard surfaces may result in glass breakage if due care is not taken.
- Check walls for electrical cabling or water pipes before drilling.
- Your shower enclosure, bath screen or wetroom must be inspected before installation. Check for all visual defects on the product before installation. Once the enclosure has been installed no claims of damage or defect will be accepted. Fitting of shower enclosure is acceptance of quality.
- The wall plugs supplied with the shower door are for use in solid walls. Timber frame, stud partition walls will require alternative fixings.
- Ensure vertical wall profiles are level and are an equal distance in from the tray.
- Shower Doors, Wetroom Screens, Bath Screens and Side Panels are adjustable between the dimensions stated. All dimensions are approximate.
- Ensure adjustment at wall profiles are equal at both sides and that all screws are fully tightened.
- Ensure hinges are level and securely fitted to the glass.
- Ensure magnets are the right orientation and are attracting rather than repelling.
- The shower enclosure should be sealed on the outside only using silicone sealant.

- Care must be taken during assembly. Flair will not accept responsibility where incorrect assembly results in undue stress being put on any components in this product.
- If there are any manufacturer defects, please contact us on (Ireland & Northern Ireland) +353 42 966 8000 or (UK) 0800 1800 8050.
- Note: If a problem has been caused by incorrect installation, a call-out charge will apply for the Flair technical engineer's time. Subsequent charges will apply "to fix" a problem caused by incorrect installation.

## BATH SCREEN INSTALLATION

The bath screen must be installed on a 100% level surface with the bath edge free from obstructions.

Bath screens should not be used on a bath with roll top rim, stepped edge rim or where the bath handle void meets the bath screen seal. This will impact on the performance of the bathscreen and the guarantee will be void. The Bath screen should be fitted to the inside edge of the bath only.

A bath screen acts as a water deflector and is not 100% waterproof. If used appropriately under normal showering conditions and installed to the inside edge of the bath, water will be deflected into the showering area. Bath Screens are not suitable for power showers.



## SHOWER TRAY INSTALLATION

All shower trays must be installed as per instructions supplied. Install on a base of fine sand, cement and cement additive. Please note: Silicone sealants, foams, mastics, installation compound adhesive or similar must not be used as a substitute for cement. Ensure shower tray is 100% level and water test to ensure water is draining correctly. If not satisfied at any stage do not proceed with fitting. Fitting of Shower Tray is acceptance of quality.

NOTE: It is normal for a small amount of localised water to be retained on a shower tray surface after use. This should be wiped dry to prevent any build up of residue.

## CLEANING GUIDELINES

- Glass: Use a soft cloth and mild detergent, rinse off thoroughly.
- Metallic Surfaces: Use a soft cloth and warm soapy water. Rinse off thoroughly.
- Do not use "Spray & leave" cleaning products on the metal surface as these will cause damage to your product. These include acidic based cleaning products, bleaches, solvents or abrasive pads. Only use detergents, cleaners and limescale removers with a pH of 5-8.
- The constant use of detergents will degrade the finish of the product over time if not thoroughly rinsed off.
- In hard water areas, regular cleaning of your Flair door will help to prevent the build-up of limescale. Stubborn deposits of limescale can be removed with the use of a mild limescale remover.
- Check your shower door for functionality periodically. Ensure that the wheel track is free from any grit / dirt which may have collected over time.

Glass breakage and components subject to wear are not covered under the lifetime guarantee. All glass complies with EN 12150-1, which is referenced in EN 14428.

## CONDITIONS OF SALE

Unless otherwise stated, all quotations are subject to acceptance within 30 days of date of issue. Other than in the case of faulty goods / incorrect despatch, Flair will not accept the return of any product.

**As part of our continuing policy of product improvement, we reserve the right to amend specifications, colours and s without prior notice. Images are for illustrated purposes only. The colours and finishes shown in the catalogue are as accurate as possible within the limits of the printing process. The positioning of all shower heads and shower wastes in the brochure is for illustrative purposes only.**

\*Errors and Omissions Exempt.





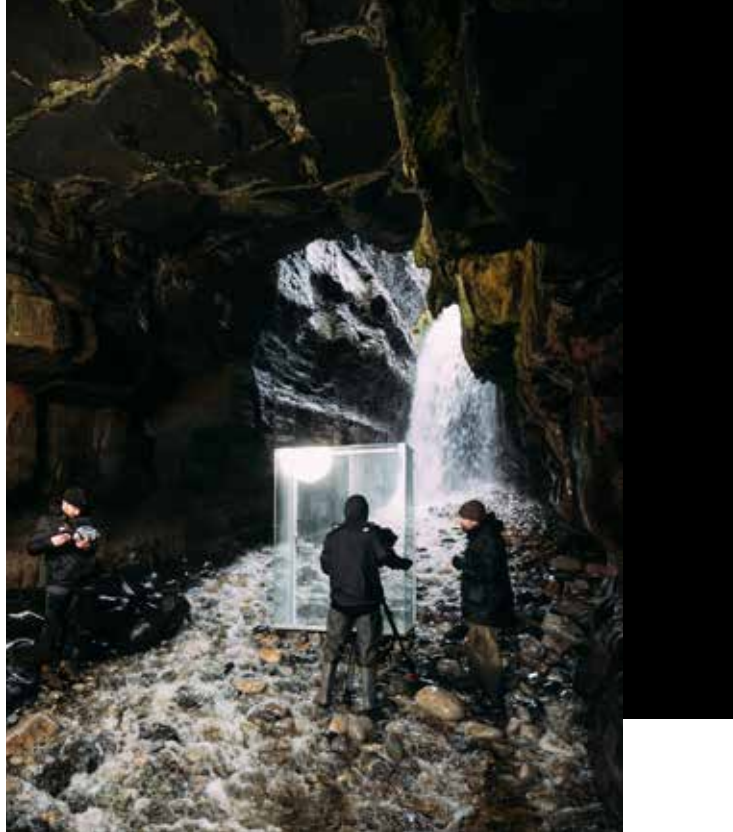

Errors and Omissions Exempt.



BEHIND  
THE  
SCENES



WATCH  
THE  
VIDEO



BEHIND THE SCENES

FLAIR

THE SECRET WATERFALL



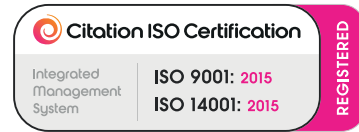

flair

Flair Showers

Ireland / Northern Ireland  
+353 42 966 8000

[sales@flairshowers.com](mailto:sales@flairshowers.com)



[FLAIRSHOWERS.COM](http://FLAIRSHOWERS.COM)

